

ALTERNATE 80' RIGHT OF WAY CROSS SECTION

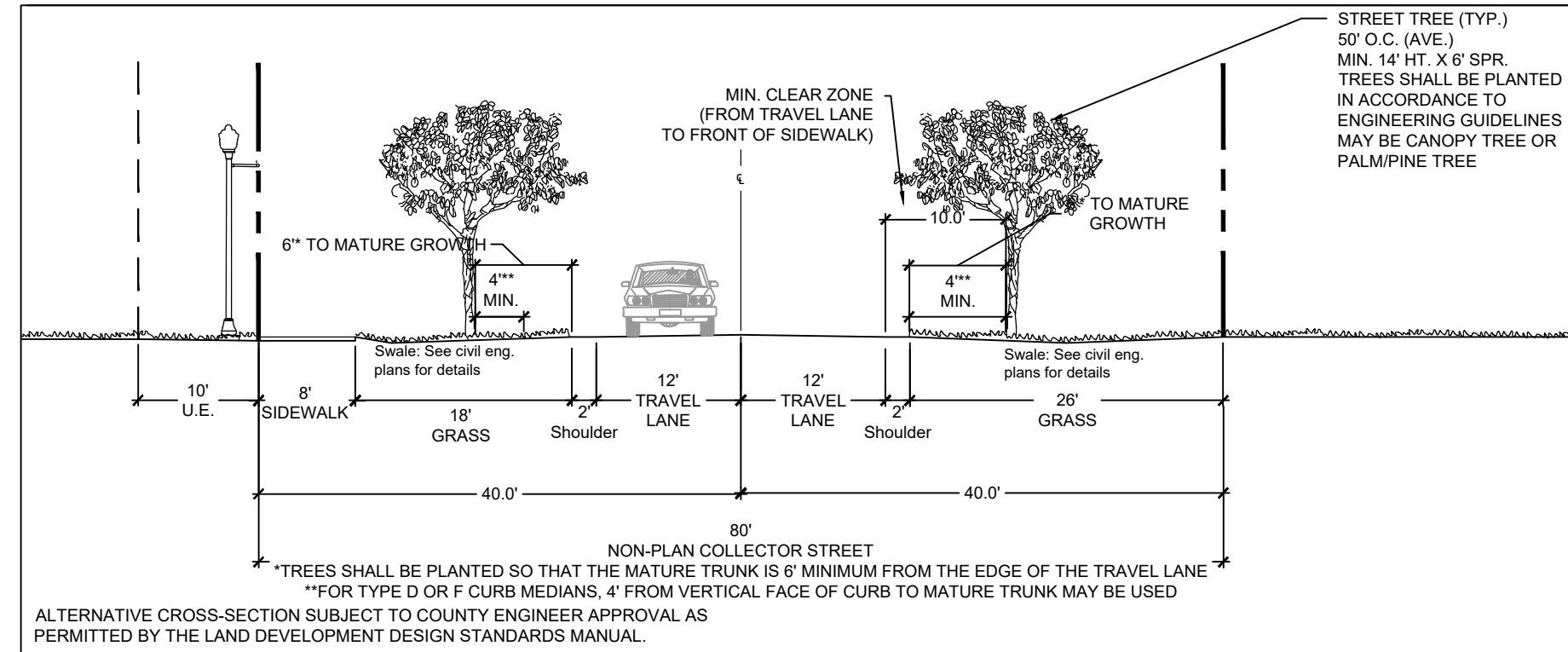

25' WIDE TYPE 3 INCOMPATIBILITY BUFFER DETAIL AND CROSS SECTION -WEST 2,040' OF NORTH BUFFER - SUBJECT OF VARIANCE

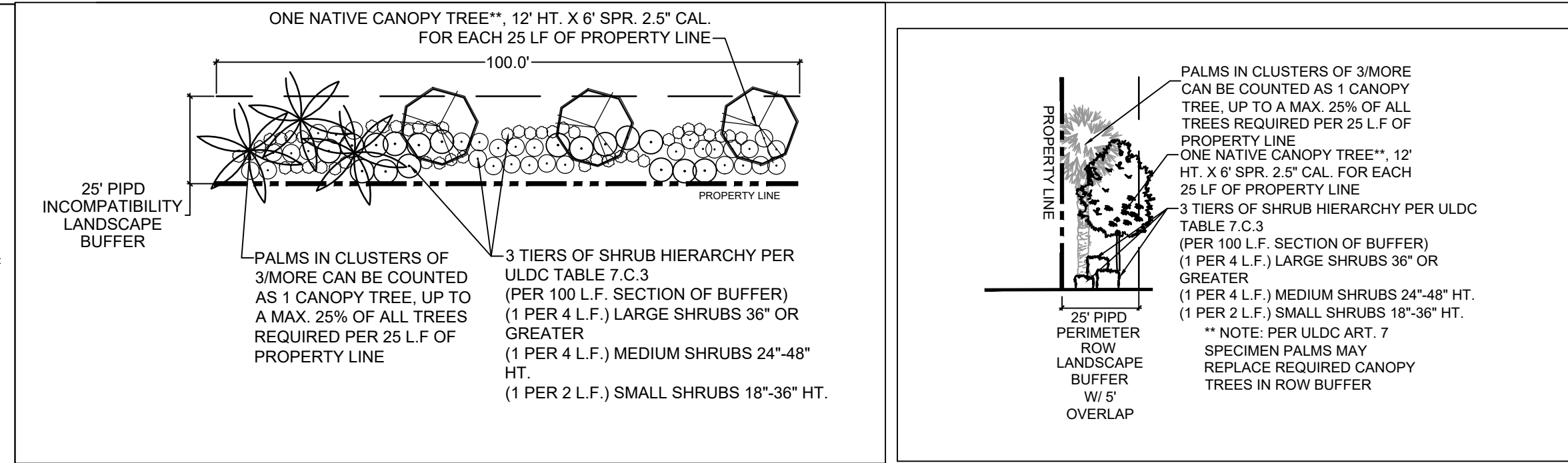

WAVE EQUIPMENT VISIBILITY DETAIL

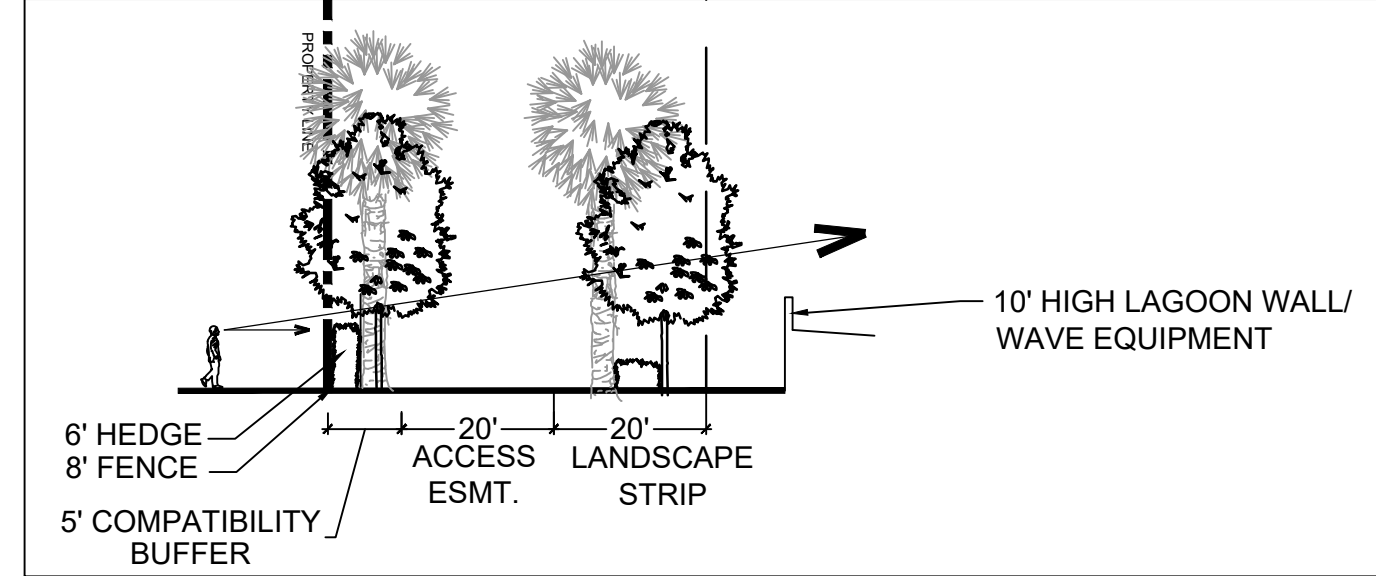

5' WIDE COMPATIBILITY BUFFER & 20' WIDE LANDSCAPE STRIP DETAIL & CROSS SECTION EAST 3,155' OF NORTH BUFFER

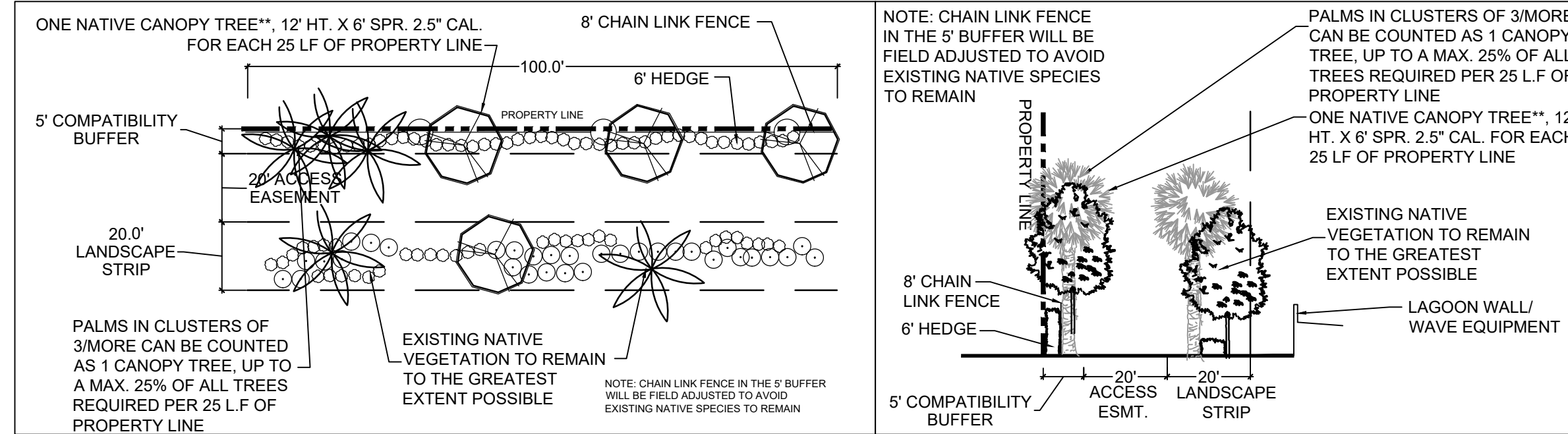

5' WIDE COMPATIBILITY LANDSCAPE BUFFER DETAIL (SOUTH & EAST PERIMETERS)

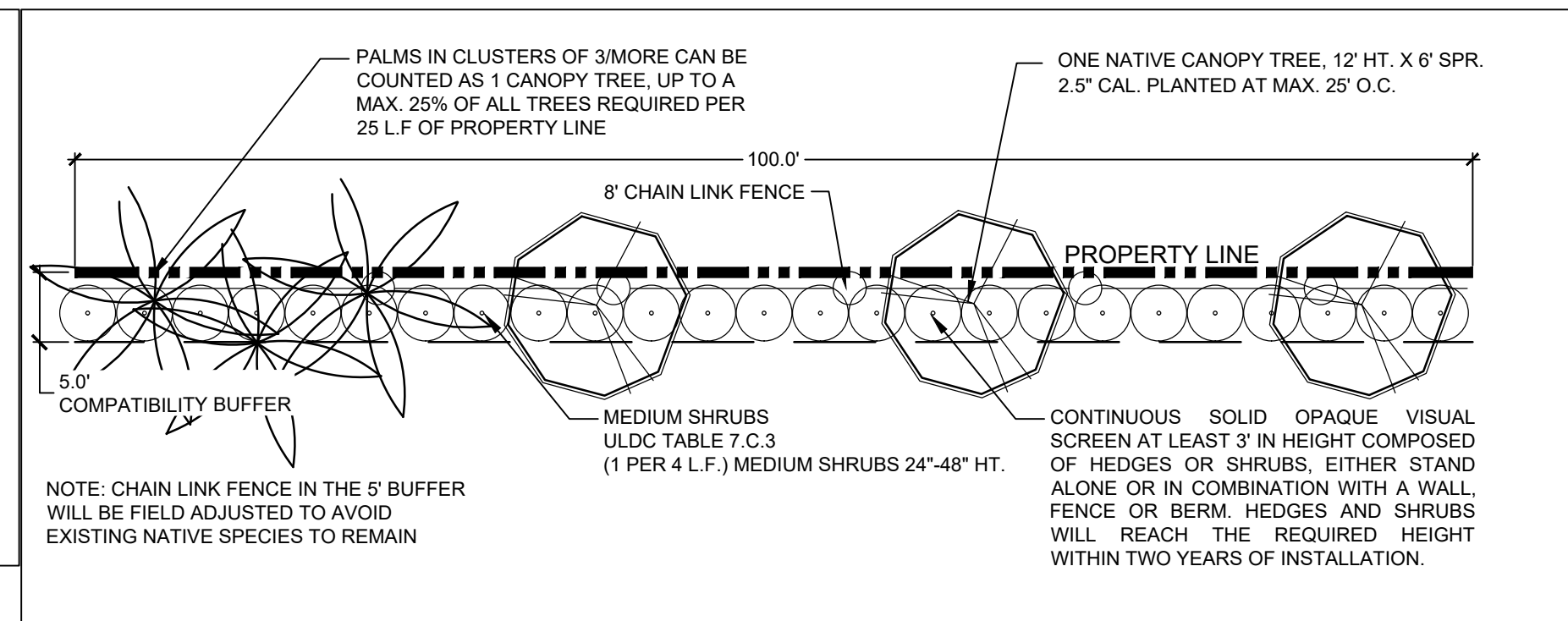

PARKING CALCULATION AREA DETAIL

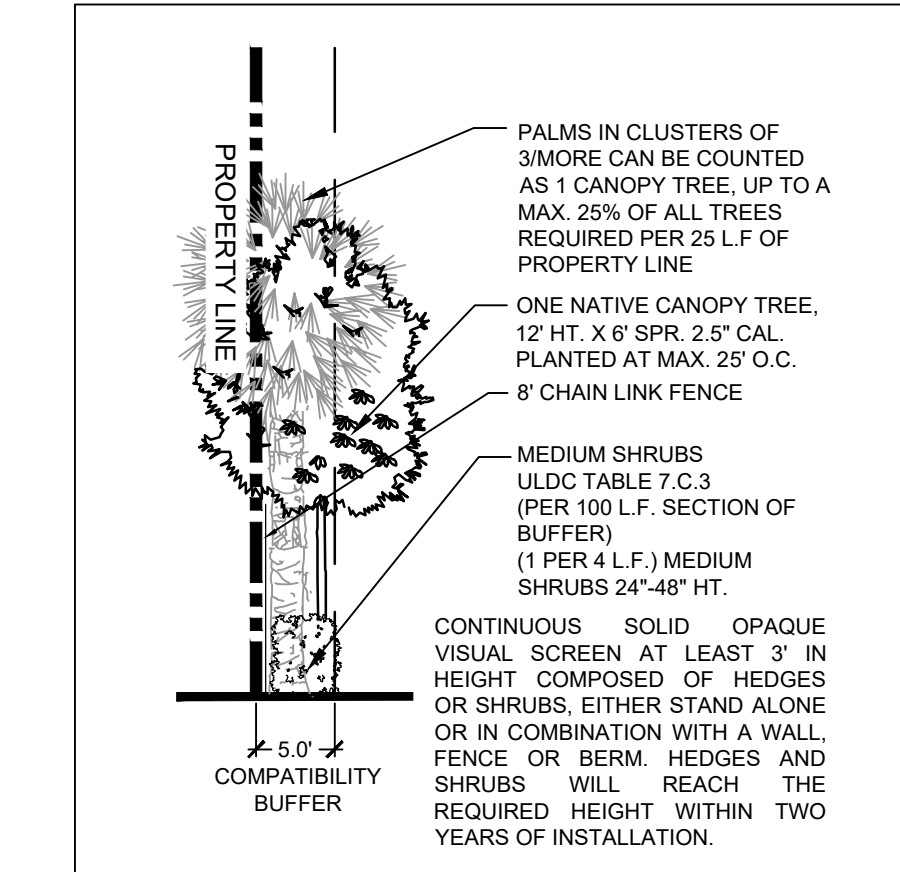
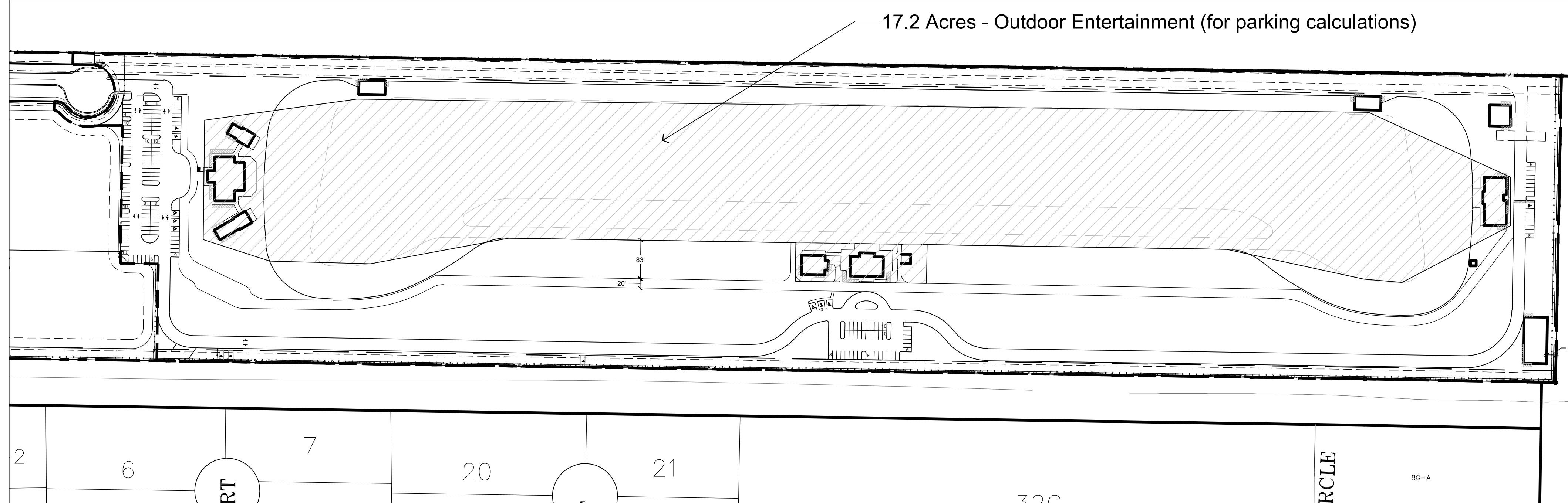

SPECIAL EVENT DETAIL

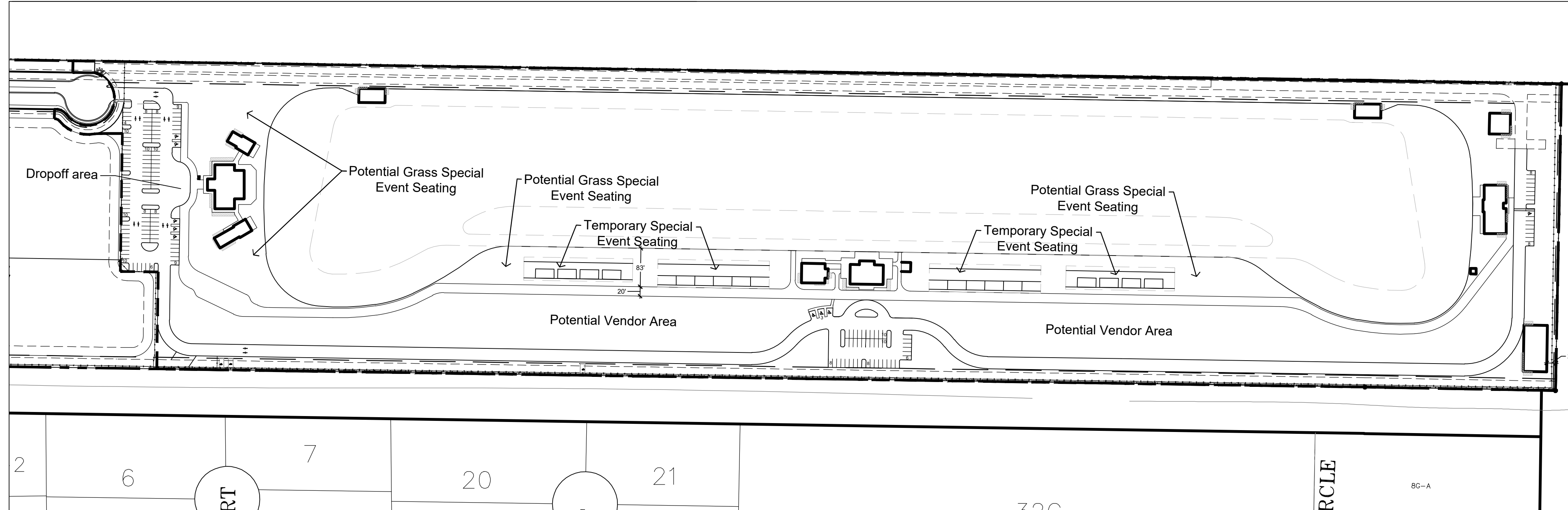

MASTER SIGN PROGRAM

PROPOSED FREESTANDING SIGNS

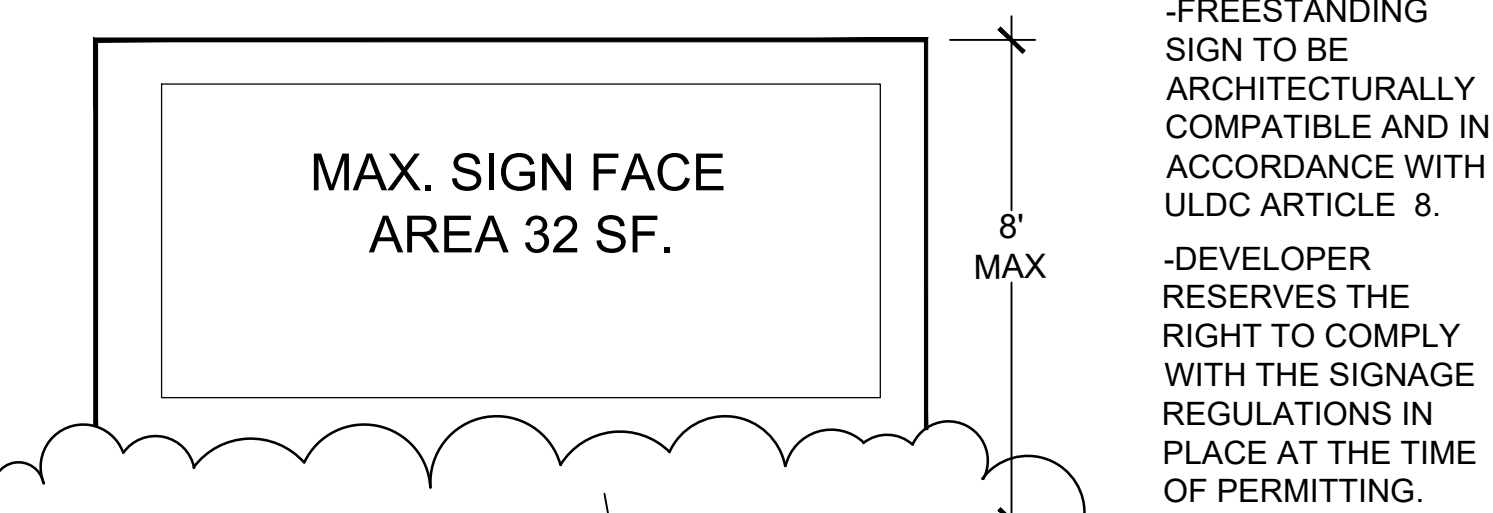

MAXIMUM NUMBER OF SIGNS = 1
MAXIMUM HEIGHT 8'
MAXIMUM SIGN FACE AREA PER SIGN = 32 SF

BUILDING FACADE SIGNS PER CODE

PBC Amendments:

PBC Zoning Stamp:

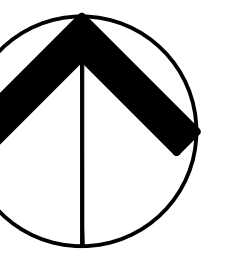

0 100' 200' 400'
Scale: 1" = 200'-0"

Date:	11-15-16
Project No.:	80-026-149
Designed By:	SCM
Drawn By:	KK
Checked By:	KW/JB
Revision Dates:	
01-18-17	Submit PAC
05-26-17	Re-Submit DOA
05-26-17	Re-Submit DOA
07-24-17	Resubmit Site Plan
08-10-17	Resubmit Site Plan