



This Fire Department Safety Sheet is to educate development and property owners of the basic minimum requirements for Traffic Calming Devices.



Palm Beach County does not allow "speed bumps" - regardless of the location, commercial or residential. However, the County does recognize the need to have devices installed in our roadways to make drivers better aware of the need to slow down.

To help achieve this, the County Engineer and Fire Marshal have approved the following two devices, both of which meet the Florida Department of Transportation "FDOT" Standards. This page consists of basic requirements for the installation of Rumble Strips and the back of this page consists of the basic requirements for Speed Humps.

Keep in mind that both require plans to be submitted, permit approval prior to installation and inspection after completion.

For more details, contact the County Engineer or the Fire Marshal's Office.

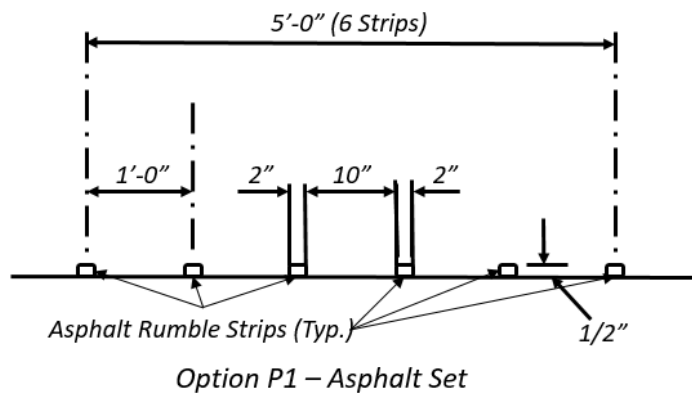
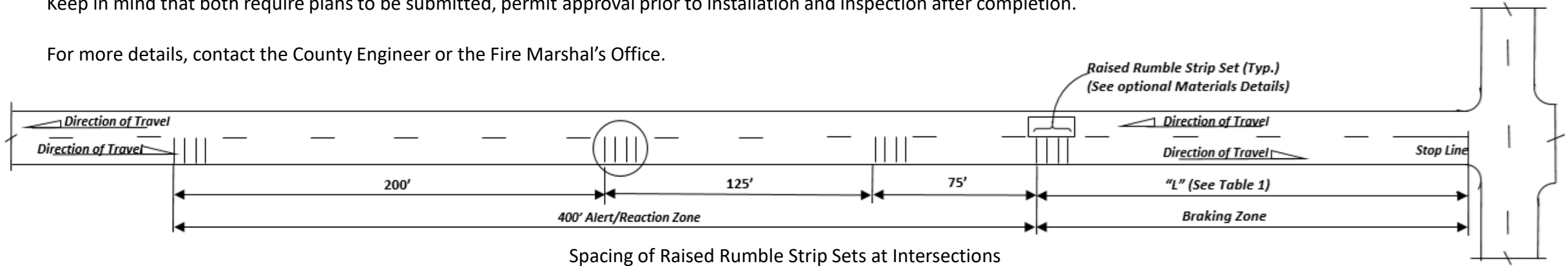

Posted Speed (mph)	'L' (Feet)
<= 30	150
35	200
40	250
45	300
50	350
55	410
60	470
65	550

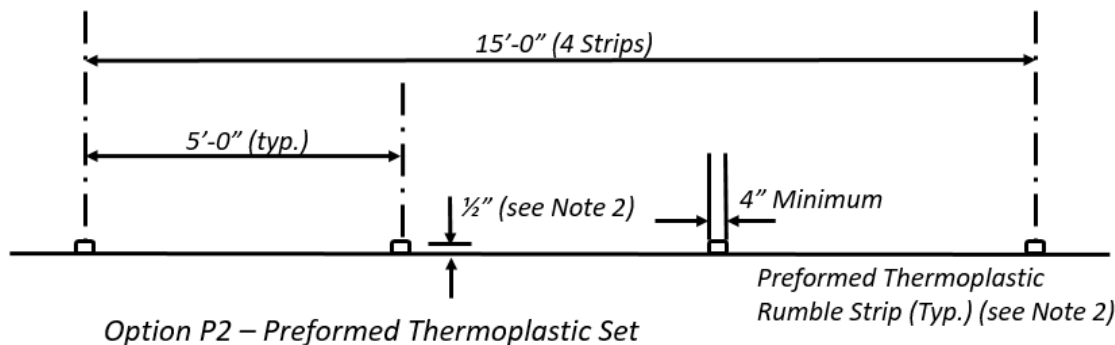

NOTES:

1. Construct permanent raised rumble strips where shown in the Plans and in accordance with FDOT Specification 546
2. Performed Thermoplastic Set:
 - a. Use multiple applications to achieve desired 1/2" thickness.
 - b. Use color white.

SPEED HUMP (DUTCH DESIGN)

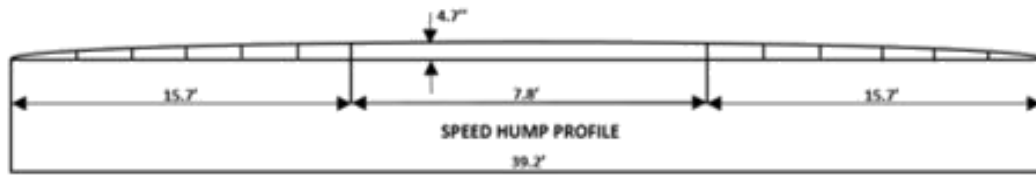

ROAD HUMP SIGNING & MARKING

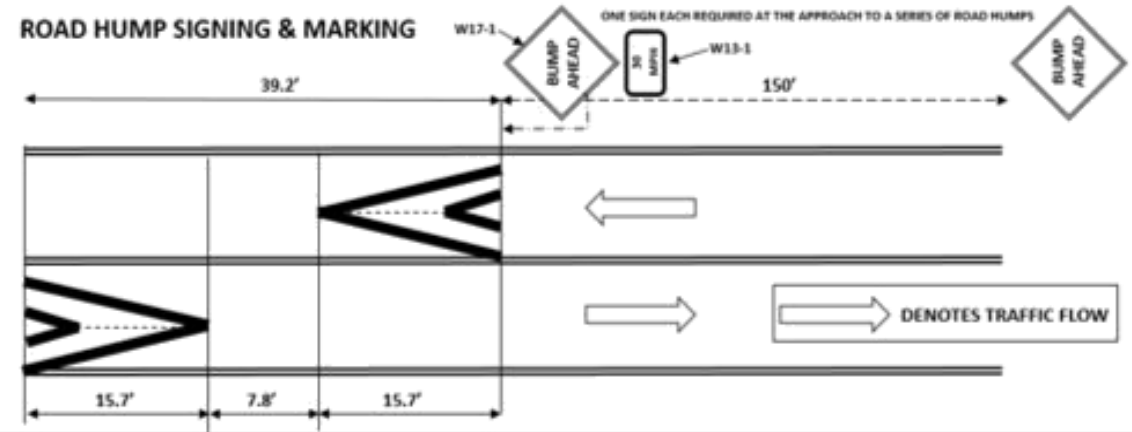

SEMINOLE SPEED HUMP

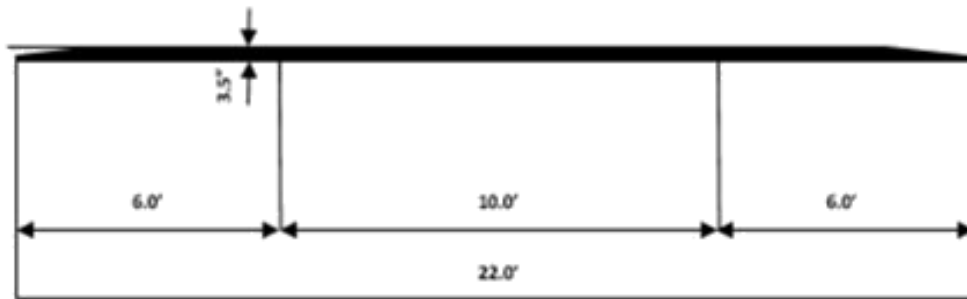

ROAD HUMP SIGNING & MARKING

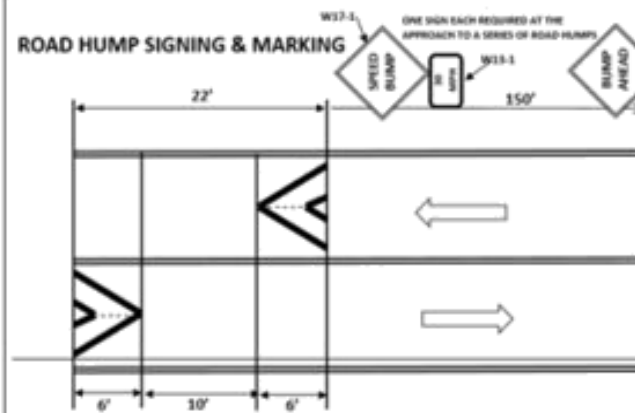

ROAD HUMP PAVEMENT MARKING

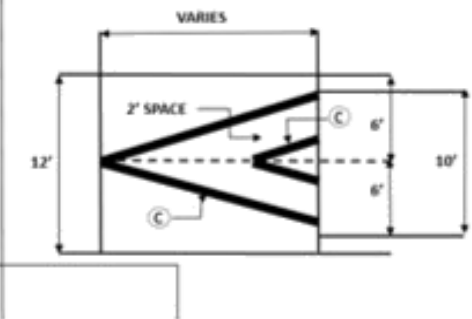

I.T.E. SPEED HUMP

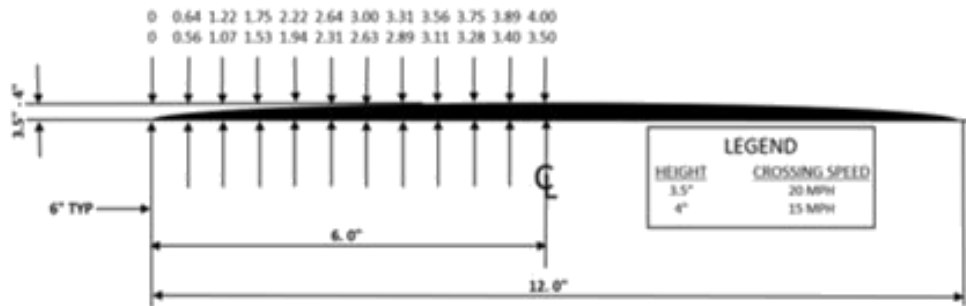

ROAD HUMP SIGNING & MARKING

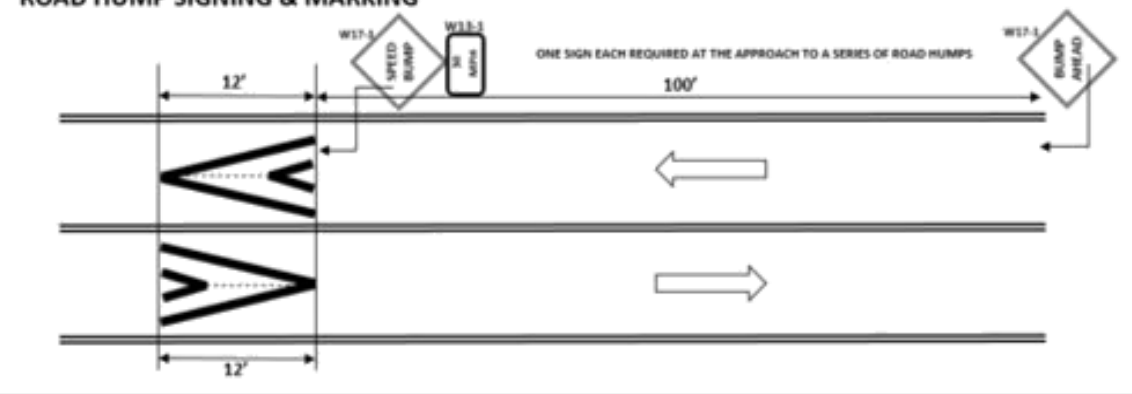

CONSTRUCTION PROCEDURES

IT IS RECOMMENDED THAT A TEMPLATE BE CONSTRUCTED TO VERIFY THE ACCURACY OF THE HUMP PROFILE AND TO ENSURE THAT THE DESIRED VERTICAL DIMENSIONS ARE ATTAINED WITHIN REASONABLE TOLERANCES (NORMALLY ONE-HALF INCH OR LESS PROVIDED THE HUMP DOES NOT EXCEED 4 INCHES). IF THE PROFILE IS INCORRECT, HUMP CHARACTERISTICS WILL BE CHANGED THAT MIGHT IMPACT TRAFFIC SAFETY OR CREATE INEFFECTIVE SPEED CONTROL. IT IS RECOMMENDED THAT THE ROAD SURFACE BE EXCAVATED AT TAMPERING EDGES TO PREVENT SPALLING. HUMPS MAY BE INSTALLED IN TWO LIFTS TO IMPROVE ACCURACY AND SHAPE

COORDINATION WITH STREET GEOMETRY

A THOROUGH ON-SITE ANALYSIS OF ROADWAY GEOMETRICS SHALL BE PERFORMED TO ENSURE THAT SPEED HUMPS WILL NOT BE INTRODUCED AT A CRITICAL POINT IN THE ROADWAY SYSTEM. E.G. A SEVERE COMBINATION OF HORIZONTAL, VERTICAL CURVATURE AND / OR STREET GRADIENT

COORDINATION WITH TRAFFIC OPERATIONS

SPEED HUMPS SHALL NOT BE INSTALLED WITHIN 400' FT. OF A TRAFFIC SIGNAL OR STOP SIGN OR WITHIN AN INTERSECTION OR DRIVEWAY. MINIMUM DISTANCE BETWEEN ROAD HUMPS IS 400' AND THE MAXIMUM SHOULD BE 800'. TO BE CONSTRUCTED ONLY WHEN APPROVED BY PALM BEACH COUNTY ENGINEER.



PALM BEACH COUNTY, FLORIDA TRAFFIC DIVISION			
ROAD SPEED HUMP DETAILS			
NO.	DATE	REVISIONS	BY APP.
DRAWN BY: OCT 4 16 2010		SCALE: N. T. S.	
CHECKED BY:		DATE: T-P-18	