

THIS PORTION 50' x 150' INCLUDED IN D. 860-47  
 To D.O.T. OR 965-385  
 \*6-2-08 checked for any abandonment, etc for Congress X of Sun Club in Public Records - nothing.

PLAN BEACH PLANTATION: PB 10-20  
 SE 01 SUMMIT PARK OF COMMERCE (89) PB61P148  
 NE 02 SFWMD GUN CLUB RD PL (99) PB82P195

TR 8, BLK 3, For INFO: PAR 2  
 - SEE OR 9681-1715 = SITE LEASE AGREEMENT  
 - OR 9859-1993 = DEVELOPMENT ORDER MODIFICATION (PAR 2)  
 - OR 10084-101 = TIC, E. & RESTORANT  
 - OR 10 960-1264 = DECLARATION OF COASTAL EASEMENT (PAR 2) EASMT.

TRACT 3 & E 355' OF TRACT 4 OF BLK 1 IS CONTROL & SOUTHERN FLOOD CONTROL DISTRICT (Now SOUTH FLORIDA WATER MANAGEMENT)

TRACT 1 OF BLK 2 & W 315' OF TRACT 4, BLK 1, LEASED TO DEPT. OF UTILITIES SERVICES (SEE R 76-717) LEASE

TRACTS 2 & 3 OF BLK 2 IS LAKE LYTAL PARK AREA AT PRESENT

TRACT 4 OF BLK 2 IS OPEN FOR FUTURE DISPOSITION

GUN CLUB RD. FOR BDR/W SEE D. 856-30: ALL SECT. 6-44-43 WAS DEEDED TO P.B.C. (PAR 33). THIS INCLUDED GUN CLUB R/W

NOTE: ALL TRS. NORTH OF GUN CLUB RD. & SOUTH OF CANAL INCLUDED IN DEED OF CORRECTION RELEASE AS PAR 4 - SEE D. 1165-323

NOTE: RES. 86-890: FOR PROVISION OF COMPUTER CABLES TO LIBRARY: 10' TEMPORARY EASMT N. OF SUMMIT R/W

NOTE: NOT TO BE REPRODUCED IN ANY FORM EXCEPT BY EXPRESS WRITTEN CONSENT FROM THE PALM BEACH COUNTY PROPERTY APPRAISER

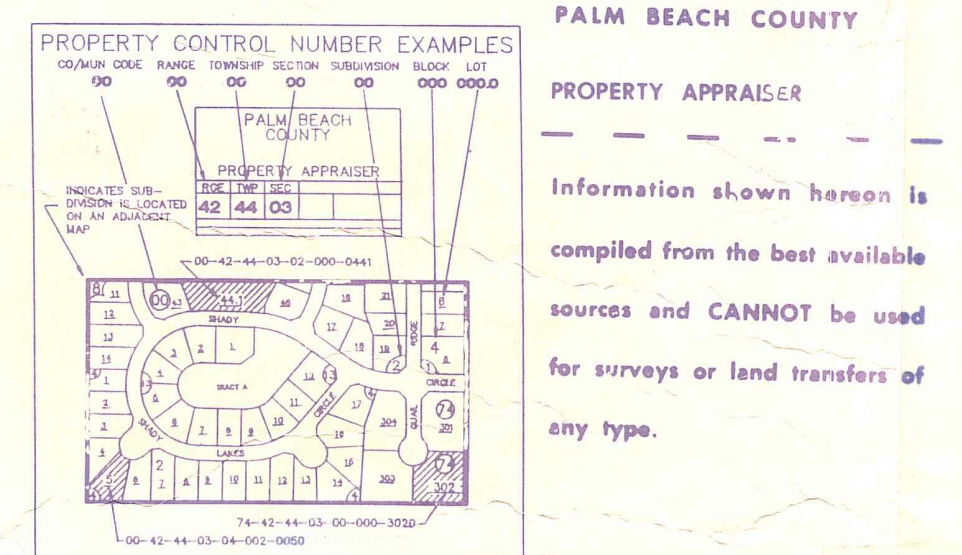

PALM BEACH COUNTY  
 GARY R. NIKOLITS  
 PROPERTY APPRAISER

RGE	TWP	SEC	AERIAL
43	44	6	NO 705
SCALE 1" = 200'			
DRAWN BY [Signature]			
UPDATED			

Palm Beach County (County) makes no representation or warranties whatsoever on the attached / enclosed information reflected herein pertaining to easements, rights-of-way, setback lines, reservations, agreements, and other similar matters. The information provided herein should not be relied upon by the requesting party to confirm the existence / non-existence of facts contained herein.