

Notes:
 NEW PALM BCH. HGTS. PB 6-73
 Revisory interest in all streets in New P.B. Heights P.B. 6-73, quit-claimed & released to P.B. Co. DB 1145-55. (FILED: 5/25/94)
 Disposed To TOWN OF JUNO BEACH ALL STREETS AS SHOWN IN PB-6-73 (sub. 14) PB 25-122 (sub 11) PB 26-44 (sub 12) ALL BY OR 8847-471 OR 9167-814
 Donald Ross Rd. Accepted maintenance of Donald Ross from ALTAMONTE A-134 to Prosperity Farms Rd. by RES. 93-256 (RW RIC)

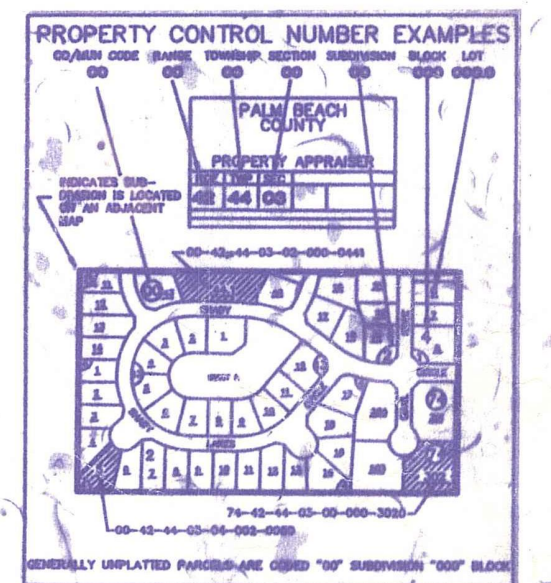

Palm Beach County (County) makes no representation or warranties whatsoever on the attached / enclosed information reflected herein pertaining to easements, rights-of-way, setback lines, reservations, agreements, and other similar matters. The information provided herein should not be relied upon by the requesting party to confirm the existence / non-existence of facts contained herein.

ATLANTIC OCEAN

- SE 01 JUNO BCH PB 22-49 (28)
- SE 02 " " FIRST ADD PB 22-51 (28)
- SE 03 " " REPL PB 24-17 (28)
- SE 04 OCEAN VIEW RIDGE PB 25-98 (28)
- SE 05 BEACHBOUND PB 26-32 (23)
- SE 06 " REPL PB 26-171 (28)
- SE 07 JUNO BCH SHOPPING CENTER PB 24-83 (28)
- NE 08 " HGTS. PB 24-122 (28)
- NE 09 MALBO PB 22-40 (28)
- NE 10 NEW PALM BCH HGTS. PB 6-73 (28)
- NE 11 PALM BEACH HGTS. THE PL. 1 PB 25-122 (28)
- NE 12 " " PL. 2 PB 26-44 (28)
- SE 13 SEA VIEW RIDGE PB 25-126 (28)
- NE 14 SURFSIDE PARK PB 18-92 (28)
- NE 15 " " PL. 3 PB 23-40 (28)
- SE 16 GREENBRIER CONDO APTS. AMENDMT. PB 22-49 (28)
- SE 17 THE BARCLAY CONDO APTS. PB 22-49 (28)
- SE 18 COLONY CONDO APTS. PB 22-49 (28)
- SE 19 SEMINOLE CONDO APTS. PB 22-49 (28)
- NE 20 JUNO BY THE SEA CONDO (28)
- NE 21 " " NORTH CONDO (28)
- NE 22 THE SANDS CONDO (28)
- NE 23 ROYAL HOMESTEAD APTS CONDO (28)
- NE 24 JUNO BY THE SEA (THE SURF CONDO) (28)
- NE 25 BRIGADOON CONDO (28)
- NE 26 TOMKUS (1977) PB32P32 (28)
- NE 27 JUNO BY THE SEA NORTH, THE MANOR CONDO (28)
- SE 28 WEXFORD COURT PB42 P177 (2) TWNS (28)
- NE 29 HORIZON CONDO (82)
- SE 30 COTÉ DE LA MER (1983) PB 44 P144 (28)
- NE 31 TER MARSCHE PLAZA PB45P20 (83) (28)
- SE 32 JUNO OCEAN CLUB CONDO (1988) (28)
- SE 33 JUNO SHORES RESORT CONDO (1987) (28)
- SE 34 JUNO BCH SHOPPING CENTER REPL. LG. 10 & 14 PB40P105 (1984) (28)
- SE 35 PELICAN WALK (1984) PB40P51 (28)
- SE 36 PELICAN WALK I CONDO (1985) (28)
- NE 37 PARK PLACE CONDO (1985) (28)
- NE 38 SEA SUNRISE MOTEL CONDO (1985) (28)
- SE 39 VENTA CONDO (1985) (28)
- SE 40 U & R CONDO (1985) (28)
- SW 41 SEMINOLE PLAZA (87) (28)
- SE 42 NYDAL TWNHS (88) PB58P93 (28)
- NE 43 HOWARD JOHNSON'S JUNO BCH (89) PB60P97 (28)
- SE 44 ALICANTE (89) PB61P46 (28)
- SE 45 PELICAN WALK I CONDO (89) (28)
- AMND. DEC. OR 5949 PGS 656 & 660
- NE 46 OCEANVIEW UNITED METHODIST CHURCH (90) PB61P80 (28)
- NE 47 700 OCEAN DRIVE (90) PB62P161 (28)
- NE 48 SEASIDE OF JUNO BEACH (91) PB65 P68 (28)
- SE 49 WILNIS CONDO (92) (28)
- NE 50 BEACH FRONT AT JUNO CONDO (92) (28)

PALM BEACH COUNTY
 N-10
 PROPERTY APPRAISER

RGE	TWP	SEC	AERIAL
43	41	28	NO

SCALE 1" = 200'
 DRAWN BY
 UPDATED

2-2
 To P.B.C.
 OR 9039-271

707 2.10 AC
 705 6.02 AC
 SEMINOLE PLAZA
 1-0 5.13 AC

