

Palm Beach County (County) makes no representation or warranties whatsoever on the attached / enclosed information reflected herein pertaining to easements, rights-of-way, setback lines, reservations, agreements, and other similar matters. The information provided herein should not be relied upon by the requesting party to confirm the existence / non-existence of facts contained herein.

SW 01 MOORES LANDING (UNREC) AM 100
w/2 02 RIVER PB 52 P 153 (87)
SW 03 ADMIRALS COVE PL 3 PAR E (90) PB 65 P 3

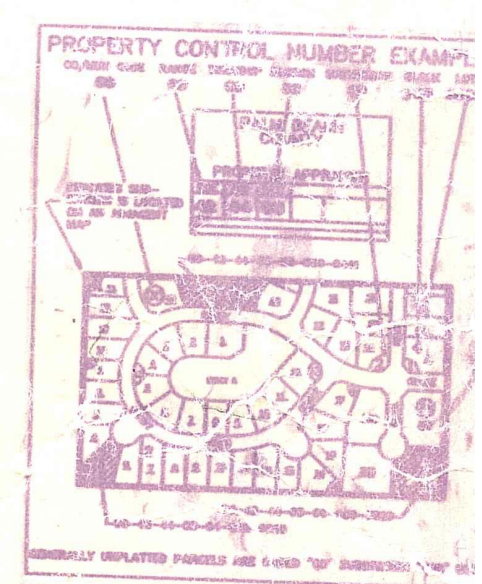

NOTE: PART OF WVA OF SECTION 16, TOWNSHIP 30 S, RANGE 41 E, COUNTY OF PALM BEACH, FLORIDA.

NOTE: SEE TO BE RECORDED IN ANY FORM EXCEPT BY EXPRESS.

17-41-43
70
34-41-43

PROPERTY CONTROL NUMBER EXAM				
RGE	TWP	SEC	AERIAL	
43	41	17	No 1108	
SCALE 1" = 200'				
DRAWN BY				
UPDATED BY				

CMB dated 4-28-1931
66' Total 33' each side
of Section Line
SEE NOTE IN sect. 16-41-43

Abandoned (66')
DB 1037-421

THIS PARCEL 4124'x 1052' 116' FOR PD RJW
7022 FOR PD RJW
DB 1037-421

18 FRED SMALL
OR 4524-1448

19-20 sec. 5E. 18