

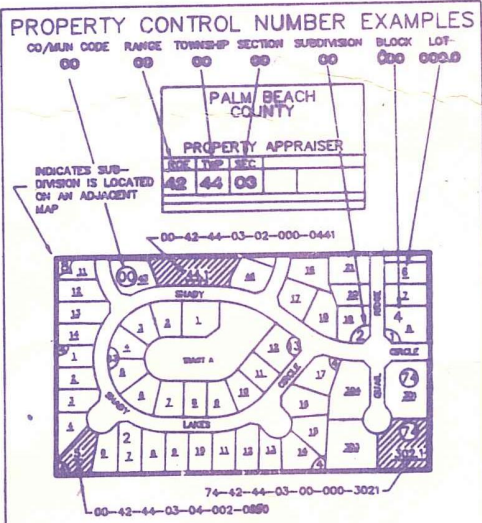

Palm Beach County (County) makes no representation or warranties whatsoever on the attached / enclosed information reflected herein pertaining to easements, rights-of-way, setback lines, reservations, agreements, and other similar matters. The information provided herein should not be relied upon by the requesting party to confirm the existence / non-existence of facts contained herein.

- NE 01 EASTPOINTE COUNTRY CLUB PB32P7 1971
- NE 02 EASTPOINTE COUNTRY CLUB NO. 2 PB33P150
- NE 03 EASTPOINTE COUNTRY CLUB No. 3 (1979) PB34P15
- NW 04 EASTPOINTE COUNTRY CLUB No. 4 (1979) PB34P73
- NE 05 EASTPOINTE COUNTRY CLUB No. 5 (1979) PB34 P128
- 06 EASTPOINTE BLVD. (1979) PB35 P133
- 07 EASTPOINTE COUNTRY CLUB No. 5A (1979) PB35 P153
- 08 EASTPOINTE COUNTRY CLUB No. 7 (1979) PB35 P195
- 09 EASTPOINTE COUNTRY CLUB No. 8 (1979) PB36 P11
- 10 EASTPOINTE COUNTRY CLUB PL. 8A (81) PB39 P86 TH 01-50
- 11 EASTPOINTE COUNTRY CLUB PL. 7A (81) PB39 P95 TH 01-50
- 12 EASTPOINTE COUNTRY CLUB PL. 7B (81) PB40 P100 TH 01-50
- 13 EASTPOINTE SUBDIVISION PL. 9 (81) PB41 P1 TH 01-52
- 14 EASTPOINTE SUBDIVISION PL. 11 (82) PB41 P166
- 15 EASTPOINTE SUBDIVISION PL. 12 (82) PB41 P168
- 16 PINEWOOD CONDO (983) (1987)
- SE 17 EASTPOINTE COUNTRY CLUB PL. 7 C (89) PE45 P170
- SW 18 EASTPOINTE SUBDIVISION PL. 9-A (89) FB49 P3
- SW 19 EASTPOINTE SUB PL. 12-A (89) PB49 P124
- SW 20 EASTPOINTE SUB PL. 12-B (89) PB53 P102
- NW 21 EASTPOINTE SUB PL. 14 (89) FE56 F29
- NW 22 EASTPOINTE SUB PL. 14-A (89) PB59 P136
- NW 23 EASTPOINTE SUB PL. 11A (89) PB59 P176
- SW 24 EASTPOINTE SUB PL. 12-C (89) PB61 P61
- S 25 EASTPOINTE SUB PL. 13A (89) PB61 P99
- NW 26 EASTPOINTE SUB PL. 14B (89) PB61 P116

NOTE:
 NOT TO BE REPRODUCED IN ANY FORM EXCEPT BY EXPRESS WRITTEN CONSENT FROM THE PALM BEACH COUNTY PROPERTY APPRAISER
 Information shown herein is compiled from the best available sources and CANNOT be used for surveys or land transfers of any type.



PALM BEACH COUNTY
 N-9
 PROPERTY APPRAISER

RGE	TWP	SEC	AERIAL
42	41	27	NO 63-18
SCALE 1"=200'			
DRAWN BY		GRICE 2-11-78	
UPDATED			

36	31	32	33	34	35	36	31
1	6	5	4	3	2	1	6
12	7	8	9	10	11	12	7
13	18	17	16	15	14	13	18
24	19	20	21	22	23	24	19
25	30	29	28	27	26	25	30
36	31	32	33	34	35	36	31
1	6	5	4	3	2	1	6

30' Drainage Esmt. OR 2988-874

CODED 42-41-34

SEE SEC 34

CODED 00-42-41-34-01

H-7