



**Palm Beach County (County) makes no representation or warranties whatsoever on the attached / enclosed information reflected herein pertaining to easements, rights-of-way, setback lines, reservations, agreements, and other similar matters. The information provided herein should not be relied upon by the requesting party to confirm the existence / non-existence of facts contained herein.**

- NW 01 MALLET HILL OF WELLINGTON COUNTRY-PLACE (196C) PB 37 P123
- NW 02 CIVIC CENTER OF WELLINGTON COUNTRY-PLACE (1980) PB 38 P190
- NE 03 SOUTHFIELDS - PHASE I OF PALM BEACH POLO & COUNTRY CLUB - WELLINGTON COUNTRYPLACE (1981) PB 39 P19
- SE 04 SOUTHFIELDS - PHASE II OF PALM BEACH POLO & COUNTRY CLUB - WELLINGTON COUNTRYPLACE (1981) PB 39 P23
- TAKEN BY SW 05 SOUTHFIELDS - PHASE II OF PB POLO & COUNTRY CLUB - WELLINGTON COUNTRYPLACE - REPL OF PAR F (1982) PB 42 PH6
- SW 06 COMMERCIAL SITE - WELLINGTON COUNTRYPLACE 1983 PB 45 P12
- SE 07 GREENBROOK EQUESTRIAN VILLAS PB 56 P 37
- SE 08 SOUTHFIELDS PH 2 OF PB POLO & C C - WELLINGTON COUNTRY PL REPL OF TR 1 OF REPL OF PAR F (91) PB 66 P 46

⊗ ROADS REMOVED FROM RD. MAINTENANCE INVENTORY AS RESULT OF WELLINGTON INCORPORATION ON NOV. 7, 1995

NOTE:  
ALL OF SECTION IN WELLINGTON 73  
▲ PARCEL RESTRICTED  
PER: UNITY OF TITLE

NOTE:  
NOT TO BE REPRODUCED IN ANY FORM EXCEPT BY EXPRESS WRITTEN CONSENT FROM THE PALM BEACH COUNTY ASSESSOR.  
Information shown hereon is compiled from the best available sources and CANNOT be used for surveys or land transfers of any type.

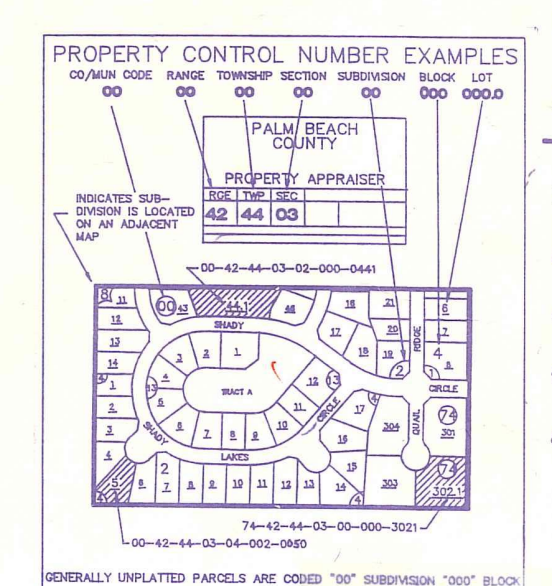

**PALM BEACH COUNTY**  
**GARY R. NIKOLITS**  
PROPERTY APPRAISER

36	31	32	33	34	35	36	31	RGE	TWP	SEC	AERIAL
1	8	9	4	3	2	1	4	41	44	21	N056-75
12	7	8	9	10	11	12	7	SCALE	1"=200'		
13	18	17	16	15	14	13	18	DRAWN BY	GRICE 11-23-74		
24	19	20	21	22	23	24	19	UPDATED	02/1/75		
25	30	29	28	27	26	25	30				
36	31	32	33	34	35	36	31				

PAR "B" To P.B. by P.A. 45-12  
R.B.C. TO THE VILLAGE OF WELLINGTON - OR 13060-1168

OR 5574-30

PAR "H" AS R.B. 39-05 RES. 83-161 = 120'