

RESOLUTION NO. R-2002- 1470

RESOLUTION APPROVING ZONING PETITION Z/COZ2000-061A
OFFICIAL ZONING MAP AMENDMENT (REZONING)
WITH A CONDITIONAL OVERLAY ZONE (COZ)
PETITION OF MAJORIE & PAUL MELOCHE
BY LAND DESIGN SOUTH, AGENT
(ABLES RESIDENCE)

WHEREAS, the Board of County Commissioners, as the governing body of Palm Beach County, Florida, pursuant to the authority vested in Chapter 163 and Chapter 125, Florida Statutes, is authorized and empowered to consider petitions relating to zoning; and

WHEREAS, the notice and hearing requirements, as provided for in Article 5 (Development Review Procedures) of the Palm Beach County Unified Land Development Code (Ordinance 92-20), have been satisfied; and

WHEREAS, Zoning Petition Z/COZ2000-061A was presented to the Board of County Commissioners at a public hearing conducted on August 22, 2002; and

WHEREAS, the Board of County Commissioners has considered the evidence and testimony presented by the petitioner and other interested parties, the recommendations of the various county review agencies, and the recommendation of the Zoning Commission; and

WHEREAS, the Board of County Commissioners made the following findings of fact:

1. This official zoning map amendment (rezoning) is consistent with the Palm Beach County Comprehensive Plan;
2. This official zoning map amendment (rezoning) is consistent with the requirements of the Palm Beach County Unified Land Development Code;
3. This official zoning map amendment (rezoning) with approved conditions is compatible with surrounding uses and zones, as defined in the Palm Beach County Unified Land Development Code, is generally consistent with existing uses and zones surrounding the subject land, and is the appropriate zoning district for the land;
4. This official zoning map amendment (rezoning) with approved conditions does not result in significantly adverse impacts on the natural environment, including but not limited to water, air, stormwater management, wildlife, vegetation, wetlands, and the natural functioning of the environment;
5. This official zoning map amendment (rezoning) with approved conditions will result in a logical and orderly development pattern;
6. This official zoning map amendment (rezoning) complies with Article 11, (Adequate Public Facilities) of the Palm Beach County Unified Land Development Code, Ordinance 92-20, as amended; and,
7. This official zoning map amendment (rezoning) is consistent with the requirements of all other applicable local land development regulations.

WHEREAS, Article 5, Section 5.3.D.9 (Action by Board of County Commissioners) of the Palm Beach County Unified Land Development Code requires that the action of the Board of County Commissioners be adopted by resolution.

NOW, THEREFORE, BE IT RESOLVED BY THE BOARD OF COUNTY COMMISSIONERS OF PALM BEACH COUNTY, FLORIDA, that Zoning Petition Z/COZ2000-061A, the petition of Majorie & Paul Meloche by Land Design South, agent, for an Official Zoning Map Amendment rezoning from the Agricultural Residential Zoning District to the Residential Transitional Urban Zoning District with a CONDITIONAL OVERLAY ZONE on a parcel of land legally described in EXHIBIT A, attached hereto and made a part hereof, and generally located as indicated on a vicinity sketch attached as EXHIBIT B, attached hereto and made a part hereof, was approved on August 22, 2002, subject to the conditions of the CONDITIONAL OVERLAY ZONE described in EXHIBIT C, attached hereto and made a part hereof.

Commissioner Aaronson moved for the approval of the Resolution.

The motion was seconded by Commissioner McCarty and, upon being put to a vote, the vote was as follows:

Warren H. Newell, Chairman	-	Aye
Carol A. Roberts, Vice Chair	-	Aye
Karen T. Marcus	-	Aye
Mary McCarty	-	Aye
Burt Aaronson	-	Aye
Tony Masilotti	-	Absent
Addie L. Greene	-	Aye

The Chair thereupon declared that the resolution was duly passed and adopted on August 22, 2002.

Filed with the Clerk of the Board of County Commissioners on 5 day of September, 2002

APPROVED AS TO FORM
AND LEGAL SUFFICIENCY

PALM BEACH COUNTY, FLORIDA
BY ITS BOARD OF COUNTY
COMMISSIONERS

DOROTHY H. WILKEN, CLERK

BY:

COUNTY ATTORNEY

BY:

DEPUTY CLERK

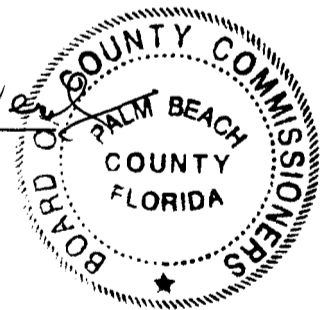

EXHIBIT A
LEGAL DESCRIPTION

The North 229.70 feet of the following described parcel: The East 1/2 of the West 1/2 of the Southeast 1/4 of the Southeast 1/4 (less the North 25 feet and the South 54 feet for road right of way), of Section 35, Township 44 South, Range 42 East, said lands situate, lying and being in Palm Beach County, Florida

EXHIBIT B
VICINITY SKETCH

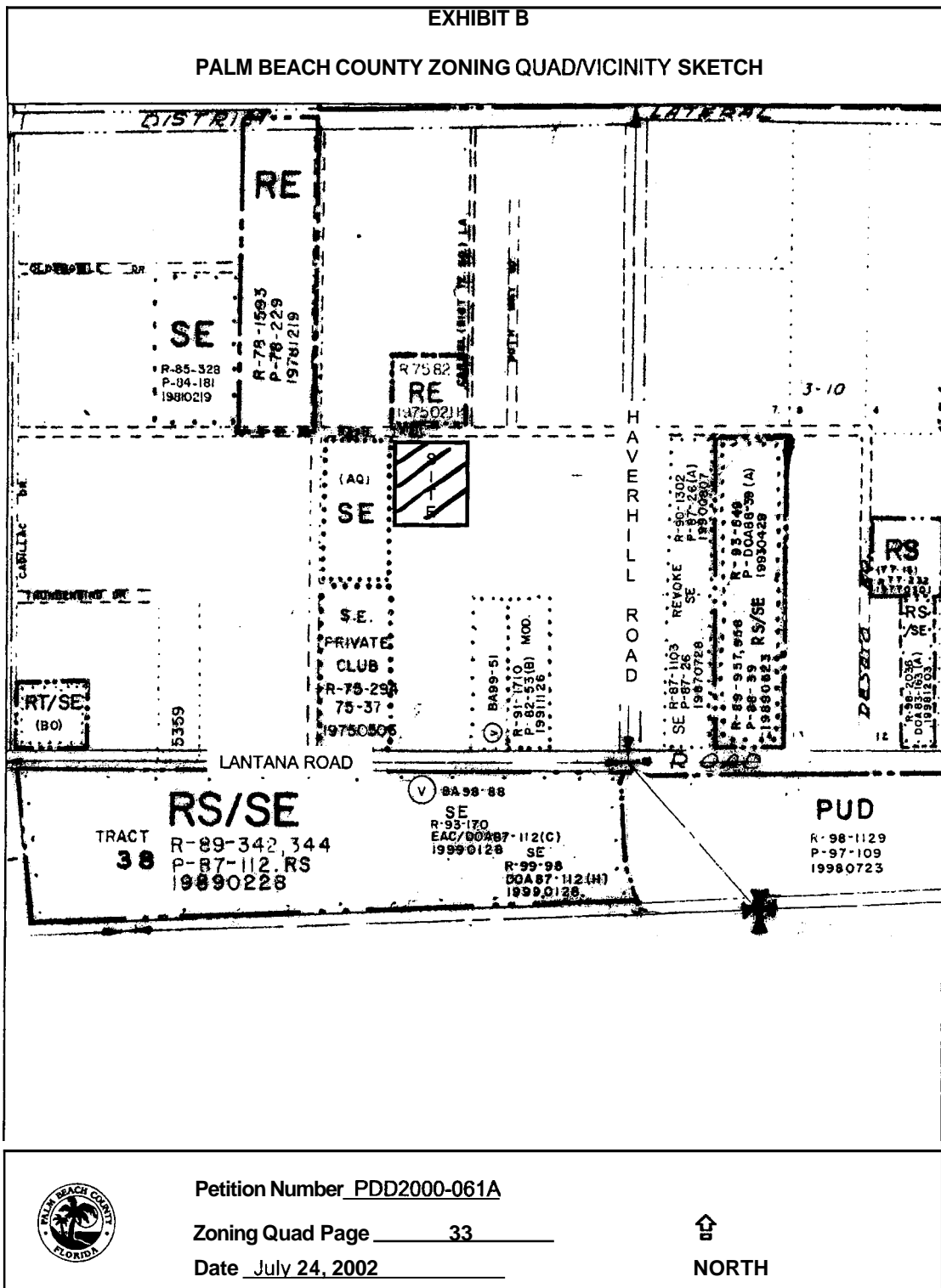

EXHIBIT C

CONDITIONS OF APPROVAL

There are no conditions of approval for A, B, C and D.

E. ENGINEERING

1. The property owner shall convey to Palm Beach County Land Development Division additional right of way for Nash Road, 30 feet from centerline on or before April 15, 2003 or prior to the issuance of a building permit, whichever shall first occur. Right of way conveyance shall be along the projects entire frontage and shall be free of all encumbrances and encroachments. Developer shall provide Palm Beach County with sufficient documentation acceptable to the Right of Way Acquisition Section to ensure that the property is free of all encumbrances and encroachments. (DATE/BLDG PERMIT: MONITORING – Eng)

F. COMPLIANCE

1. In granting this approval, the Board of County Commissioners relied upon the oral and written representations of the petitioner both on the record and as part of the application process. Deviations from or violation of these representations shall cause the approval to be presented to the Board of County Commissioners for review under the compliance condition of this approval. (ONGOING: MONITORING – Zoning)
2. Failure to comply with any of the conditions of approval for the subject property at any time may result in:
 - a. The issuance of a stop work order; the issuance of a cease and desist order; the denial or revocation of a building permit; the denial or revocation of a Certificate of Occupancy; the denial of any other permit, license or approval to any developer, owner, lessee, or user of the subject property; the revocation of any other permit, license or approval from any developer, owner, lessee, or user of the subject property; revocation of any concurrency; and/or
 - b. The revocation of the Official Map Amendment, Conditional Use, Requested Use, Development Order Amendment, and/or any other zoning approval; and/or
 - c. A requirement of the development to conform with the standards of the ULDC at the time of the finding of non-compliance, or the addition or modification of conditions reasonably related to the failure to comply with existing conditions; and/or
 - d. Referral to code enforcement; and/or
 - e. Imposition of entitlement density or intensity.

Staff may be directed by the Executive Director of PZ&B or a Code Enforcement Special Master to schedule a Status Report before the body which approved the Official Zoning Map Amendment, Conditional Use, Requested Use, Development Order Amendment, and/or other zoning approval, in accordance with the provisions of Section 5.8 of the ULDC, in response to any flagrant violation and/or continued violation of any condition of approval.

Appeals of any departmental administrative actions hereunder may be taken to the Palm Beach County Board of Adjustment or as otherwise provided in the Unified Land Development Code (ULDC), as amended. Appeals of any revocation of an Official Zoning Map Amendment,

Conditional Use, Requested Use, Development Order Amendment or other actions based on a Board of County Commission decision shall be by petition for writ of certiorari to the Fifteenth Judicial Circuit. (ONGOING: MONITORING – Zoning)