

RESOLUTION No. R-2001-0600

RESOLUTION APPROVING ZONING PETITION Z2000-079  
OFFICIAL ZONING MAP AMENDMENT (REZONING)  
WITH A CONDITIONAL OVERLAY ZONE (COZ)  
PETITION OF DON AND BOBBYE LYONS  
BY BERNARD CONKO, AGENT  
(NEW TOWING YARD)

WHEREAS, the Board of County Commissioners, as the governing body of Palm Beach County, Florida, pursuant to the authority vested in Chapter 163 and Chapter 125, Florida Statutes, is authorized and empowered to consider petitions relating to zoning; and

WHEREAS, the notice and hearing requirements, as provided for in Article 5 (Development Review Procedures) of the Palm Beach County Unified Land Development Code (Ordinance 92-20), have been satisfied; and

WHEREAS, Zoning Petition Z2000-079 was presented to the Board of County Commissioners at a public hearing conducted on April 26, 2001; and

WHEREAS, the Board of County Commissioners has considered the evidence and testimony presented by the petitioner and other interested parties, the recommendations of the various county review agencies, and the recommendation of the Zoning Commission; and

WHEREAS, the Board of County Commissioners made the following findings of fact:

1. This official zoning map amendment (rezoning) is consistent with the Palm Beach County Comprehensive Plan;
2. This official zoning map amendment (rezoning) is consistent with the requirements of the Palm Beach County Unified Land Development Code;
3. This official zoning map amendment (rezoning) with approved conditions is compatible with surrounding uses and zones, as defined in the Palm Beach County Unified Land Development Code, is generally consistent with existing uses and zones surrounding the subject land, and is the appropriate zoning district for the land;
4. This **official** zoning map amendment (rezoning) with approved conditions does not result in significantly adverse impacts on the natural environment, including but not limited to water, air, stormwater management, wildlife, vegetation, wetlands, and the natural functioning of the environment;
5. This official zoning map amendment (rezoning) with approved conditions will result in a logical and orderly development pattern;
6. This official zoning map amendment (rezoning) complies with Article 11, (Adequate Public Facilities) of the Palm Beach County Unified Land Development Code, Ordinance 92-20, as amended; and,
7. This official zoning map amendment (rezoning) is consistent with the requirements of all other applicable local land development regulations.

WHEREAS, Article 5, Section 5.3.D.9 (Action by Board of County Commissioners) of the Palm Beach County Unified Land Development Code requires that the action of the Board of County Commissioners be adopted by resolution.

NOW, THEREFORE, BE IT RESOLVED BY THE BOARD OF COUNTY COMMISSIONERS OF PALM BEACH COUNTY, FLORIDA, that Zoning Petition Z2000-079, the petition of Don and Bobbye Lyons by Bernard Conko, agent, for an Official Zoning Map Amendment (Z) from Residential Single Family (RS) to Light Industrial (IL) with a CONDITIONAL OVERLAY ZONE (COZ) on a parcel of land legally described in EXHIBITA, attached hereto and made a part hereof, and generally located as indicated on a vicinity sketch attached as EXHIBIT B, attached hereto and made a part hereof, was approved on April 26, 2001, subject to the conditions of the CONDITIONAL OVERLAY ZONE (COZ) described in EXHIBIT C, attached hereto and made a part hereof.

Commissioner Masilotti moved for the approval of the Resolution.

The motion was seconded by Commissioner McCarty and, upon being put to a vote, the vote was as follows:

Warren H. Newell, Chair	-	Aye
Carol A. Roberts, Vice Chair	-	Absent
Karen T. Marcus		Aye
Mary McCarty		Aye
Burt Aaronson		Aye
Tony Masilotti	-	Aye
Addie L. Greene		Absent

The Chair thereupon declared that the resolution was duly passed and adopted on April 26, 2001.

APPROVED AS TO FORM  
AND LEGAL SUFFICIENCY

PALM BEACH COUNTY, FLORIDA  
BY ITS BOARD OF COUNTY  
COMMISSIONERS

DOROTHY H. WILKEN, CLERK

BY:   
COUNTY ATTORNEY

BY:   
DEPUTY CLERK

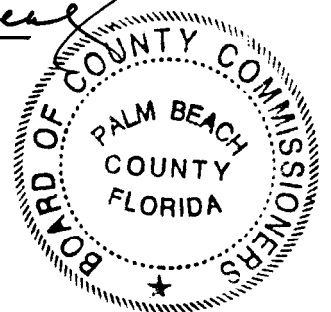
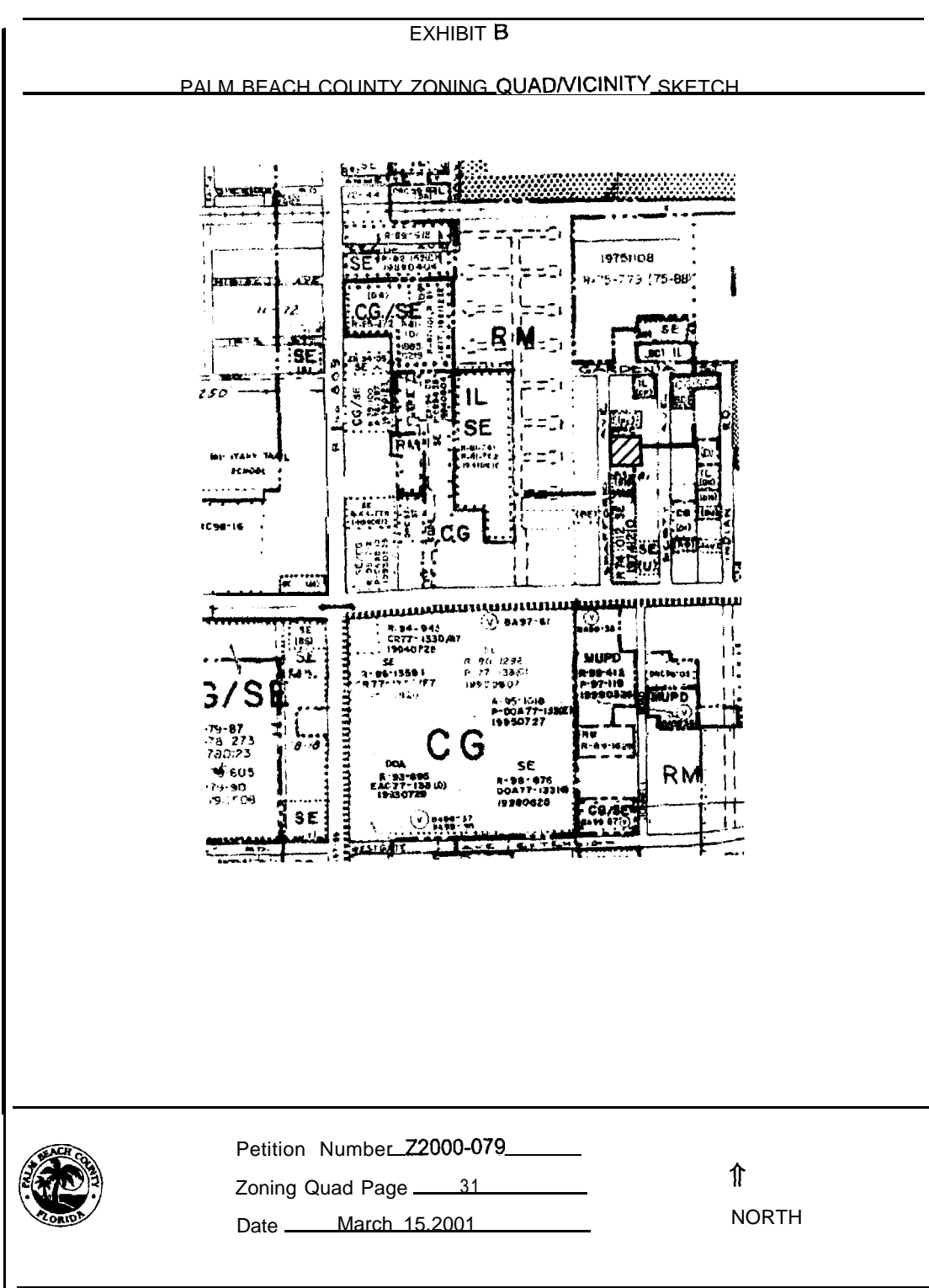

EXHIBIT A  
LEGAL DESCRIPTION

LOTS 18 AND 19 LYING IN "OKEECHOBEE GARDEN ESTATES", ACCORDING TO THE PLAT THEREOF ON FILE IN THE OFFICE OF THE CLERK OF THE CIRCUIT COURT IN AND FOR PALM BEACH COUNTY, FLORIDA, RECORDED IN PLAT BOOK 23, PAGE 181, AND THE WARRANTY DEED RECORDED IN OFFICIAL RECORD BOOK 4488, PAGE 0698, PUBLIC RECORDS OF PALM BEACH COUNTY, FLORIDA. CONTAINING 0.636 ACRES MORE OR LESS.

EXHIBIT B  
VICINITY SKETCH



Petition Number Z2000-079

Zoning Quad Page 31

Date March 15, 2001

↑  
NORTH

## EXHIBIT C

### CONDITIONS OF APPROVAL

#### A. ALL PETITIONS

1. All previous resolutions (R-85-714, R-85-71 5 (Petition 85-I 1) and R-89-I 046, R-89-I 047 (Petition 88-I 25)), shall remain in full force and effect. (ONGOING: MONITORING-Zoning)
2. Development of the site is limited to the uses and site design as approved by the Board of County Commissioners. The approved site plan is dated March 1, 2001. All modifications must be approved by the Board of County Commissioners unless the proposed changes are required to meet conditions of approval or are in accordance with the ULDC. (ONGOING: ZONING)

#### B. HEALTH

1. Generation and disposal of any hazardous effluent into sanitary sewer system shall be prohibited unless adequate pretreatment facilities approved by the Florida Department of Environmental Protection and the agency responsible for sewage works are constructed and used by project tenants or owners generating such effluent. (ONGOING: HEALTH/CODE ENF)
2. Any toxic or hazardous waste which may be generated at this site shall be handled and disposed of in accordance with Rule 62-730 FAC. (ONGOING: HEALTH/CODE ENFORCEMENT)
3. All necessary precautions will be taken to prevent any leaching into the soil or ground water of any toxic or hazardous materials that may be released from any stored vehicles. (ONGOING: HEALTH/CODE ENF)

#### C. LANDSCAPING

1. Fifty percent (50%) of the canopy trees required to be planted in the perimeter buffer shall meet the following minimum standards at installation:
  - a. Tree height: fourteen (14) feet;
  - b. Trunk diameter: 3.5 inches measured 4.5 feet above grade;
  - c. Canopy diameter: seven (7) feet. Diameter shall be determined by the average canopy radius at 3 points measured from the trunk to the outermost branch tip. Each radius shall measure at least 3.5 feet in length; and,
  - d. Credit may be given for existing or relocated trees provided they meet current ULDC requirements. (CO: LANDSCAPE - Zoning)
2. All palms required to be planted on site by this approval shall meet the following minimum standards at installation:
  - a. Palm heights: twelve (12) feet clear trunk;
  - b. Clusters: staggered heights twelve (12) to eighteen (18) feet; and,
  - c. Credit may be given for existing or relocated palms provided they meet current ULDC requirements. (CO: LANDSCAPE - Zoning)

D. LANDSCAPING ALONG THE WEST PROPERTY LINE (SPAFFORD AVENUE FRONTAGE)

1. Landscaping and buffering along the west property line shall be upgraded to include:
  - a. a minimum fifteen (15) foot wide right-of-way landscape buffer strip;
  - b. one (1) canopy tree planted every twenty (20) feet on center;
  - c. one (1) palm or pine tree for each thirty (30) linear feet of the property line with a maximum spacing of sixty (60) feet between clusters; and,
  - d. twenty-four (24) inch high shrub or hedge material spaced no more than twenty-four (24) inches on center at installation, to be maintained at a minimum height of thirty-six (36) inches. (CO: LANDSCAPE)

E. ENGINEERING

1. Use of the existing onsite structure shall be limited to a security caretakers quarters until such time as legal positive outfall is established. (ONGOING)

F. LANDSCAPING ALONG THE NORTH PROPERTY LINE

1. Landscaping and buffering along the north property line shall be upgraded to include:
  - a. a minimum five (5) foot wide right-of-way landscape buffer strip;
  - b. an eight foot (8) high green or black vinyl-coated chain link fence with slat inserts;
  - c. one (1) canopy tree planted every thirty (30) feet on center;
  - d. one (1) palm or pine tree for each thirty (30) linear feet of the property line with a maximum spacing of sixty (60) feet between clusters; and,
  - e. twenty-four (24) inch high shrub or hedge material spaced no more than twenty-four (24) inches on center at installation, to be maintained at a minimum height of thirty-six (36) inches. (CO: LANDSCAPE)

G. LANDSCAPING ALONG THE SOUTH AND EAST PROPERTY LINES

1. Landscaping and buffering along the south and east property lines shall be upgraded to include:
  - a. a minimum ten (10) foot wide right-of-way landscape buffer strip;
  - b. an eight foot (8) high green or black vinyl-coated chain link fence with slat inserts;
  - c. one (1) canopy tree planted every thirty (30) feet on center;
  - d. one (1) palm or pine tree for each thirty (30) linear feet of the property line with a maximum spacing of sixty (60) feet between clusters; and,
  - e. twenty-four (24) inch high shrub or hedge material spaced no more than twenty-four (24) inches on center at installation, to be maintained at a minimum height of thirty-six (36) inches. (CO: LANDSCAPE)

H. LIGHTING

1. All outdoor lighting used to illuminate the subject property and identification sign shall be of minimum necessary to satisfy the Palm Beach County Security Code, low intensity, shielded and directed down away from adjacent properties and streets. (CO/Ongoing: BLDG./CODE ENF-ZONING)

2. All outdoor lighting fixtures shall not exceed twenty-five (25) feet in height measured from finished grade to highest point. (CO: BLDG.-ZONING)
3. All outdoor lighting shall be extinguished no later than 11:00 p.m. excluding security lighting only. (ONGOING: CODE ENF)
4. The lighting conditions above shall not apply to proposed security or lowvoltage landscape/accent type lights used to emphasize plant material. (ONGOING: CODE ENF)

I. SIGNS

1. Freestanding signs fronting on Spafford Avenue shall be limited as follows:
  - a. Maximum sign height six (6) feet;
  - b. Maximum sign face area per side- sixty (60) square feet;
  - c. Maximum number of signs- one (1)
  - d. Style- monument identification only. (CO: BLDG.)

J. VEHICLE STORAGE

1. The maximum number of vehicles allowed to be stored on site shall be fifty (50).

K. COMPLIANCE

1. In granting this approval, the Board of County Commissioners relied upon the oral and written representations of the petitioner both on the record and as part of the application process. Deviations from or violation of these representations shall cause the approval to be presented to the Board of County Commissioners for review under the compliance condition of this approval. (ONGOING: MONITORING - Zoning)
2. Failure to comply with any of the conditions of approval for the subject property at any time may result in:
  - a. The issuance of a stop work order; the issuance of a cease and desist order; the denial or revocation of a building permit; the denial or revocation of a Certificate of Occupancy; the denial of any other permit, license or approval to any developer, owner, lessee, or user of the subject property; the revocation of any other permit, license or approval from any developer, owner, lessee, or user of the subject property; revocation of any concurrency; and/or
  - b. The revocation of the Official Map Amendment, Conditional Use, Requested Use, Development Order Amendment, and/or any other zoning approval; and/or
  - c. A requirement of the development to conform with the standards of the ULDC at the time of the finding of non-compliance, or the addition or modification of conditions reasonably related to the failure to comply with existing conditions; and/or
  - d. Referral to code enforcement; and/or
  - e. Imposition of entitlement density or intensity.

Staff may be directed by the Executive Director of PZ&B or a majority vote of the Code Enforcement Board to schedule a Status Report before the body which approved the Official Zoning Map Amendment, Conditional Use, Requested Use, Development Order Amendment, and/or other zoning approval, in accordance with the provisions of Section 5.8 of the ULDC, in

response to any flagrant violation and/or continued violation of any condition of approval.

Appeals of any departmental administrative actions hereunder may be taken to the Palm Beach County Board of Adjustment or as otherwise provided in the Unified Land Development Code (ULDC), as amended. Appeals of any revocation of an Official Zoning Map Amendment, Conditional Use, Requested Use, Development Order Amendment or other actions based on a Board of County Commission decision shall be by petition for writ of certiorari to the Fifteenth Judicial Circuit. (MONITORING)