

RESOLUTION NO. R-~~81-754~~

RESOLUTION APPROVING ZONING PETITION

WHEREAS, the Board of County Commissioners, as the governing body,, pursuant to the authority vested in Chapter 163 and Chapter 125, Florida Statutes, is authorized and empowered to consider petitions relating to zoning; and

WHEREAS, the notice and hearing requirements as provided for in Chapter 402.5 of 'the Palm Beach County Zoning Code Ordinance No. 73-2 have been satisfied; and

WHEREAS, Petition No. ~~81-75~~ was presented to the Board of County Commissioners of Palm Beach County at its public hearing conducted on 28 May 1981; and

WHEREAS, the Board of County Commissioners has considered the evidence and testimony presented by the applicant and other interested parties and the recommendations of the various county review agencies and the recommendations of the Planning Commission; and

WHEREAS, the Board of County Commissioners made the following findings of fact:

1. The proposal would be in harmony and compatible with the present and future development of the area concerned

NOW, THEREFORE, BE IT RESOLVED BY THE BOARD OF COUNTY COMMISSIONERS OF PALM BEACH COUNTY, FLORIDA, assembled in regular session this ~~16th~~ day of JUNE, 1981, that Petition No. 81-75 the petition of BOARD OF COUNTY COMMISSIONERS OF PALM ~~BEACH~~ COUNTY by Frank Foster, Chairman, for the REZONING, FROM CG-GENERAL COMMERCIAL DISTRICT, IN PART, AND RM-RESIDENTIAL MULTIPLE FAMILY DISTRICT (MEDIUM DENSITY), IN PART, TO PO-PUBLIC OWNERSHIP DISTRICT of the Southwest 1/4 of the Southeast 1/4 of the Northwest 1/4 and the Southeast 1/4 of the Southeast 1/4 of the Northwest 1/4: less the

North 280 feet of the West 297 feet of the East 350 feet, in Section 36, Township 43 South, Range 42 East. Said property located on the west side of Military Trail (S.R. 809), approximately .4 mile south of Belvedere Road, was approved as advertised.

Commissioner Koehler, moved for approval of the petition. The motion was seconded by Commissioner Evatt, and upon being put to a vote, the vote was as follows:

Frank Foster, Chairman  
Norman Gregory, Vice Chairman -  
Bill Bailey, Member  
Dennis Koehler, Member  
Peggy B. Evatt, Member

AYE  
AYE  
ABSENT  
AYE  
AYE

The foregoing resolution was declared duly passed and adopted this 16th day of JUNE, 1981, confirming action of 28 May 1981.

PALM BEACH COUNTY, FLORIDA  
BY ITS BOARD OF COUNTY  
COMMISSIONERS

JOHN B. DUNKLE, Clerk

By:

Ruth Van Oltzen  
Deputy Clerk

APPROVE AS TO FORM  
AND LEGAL SUFFICIENCY

J. Brundley  
County Attorney



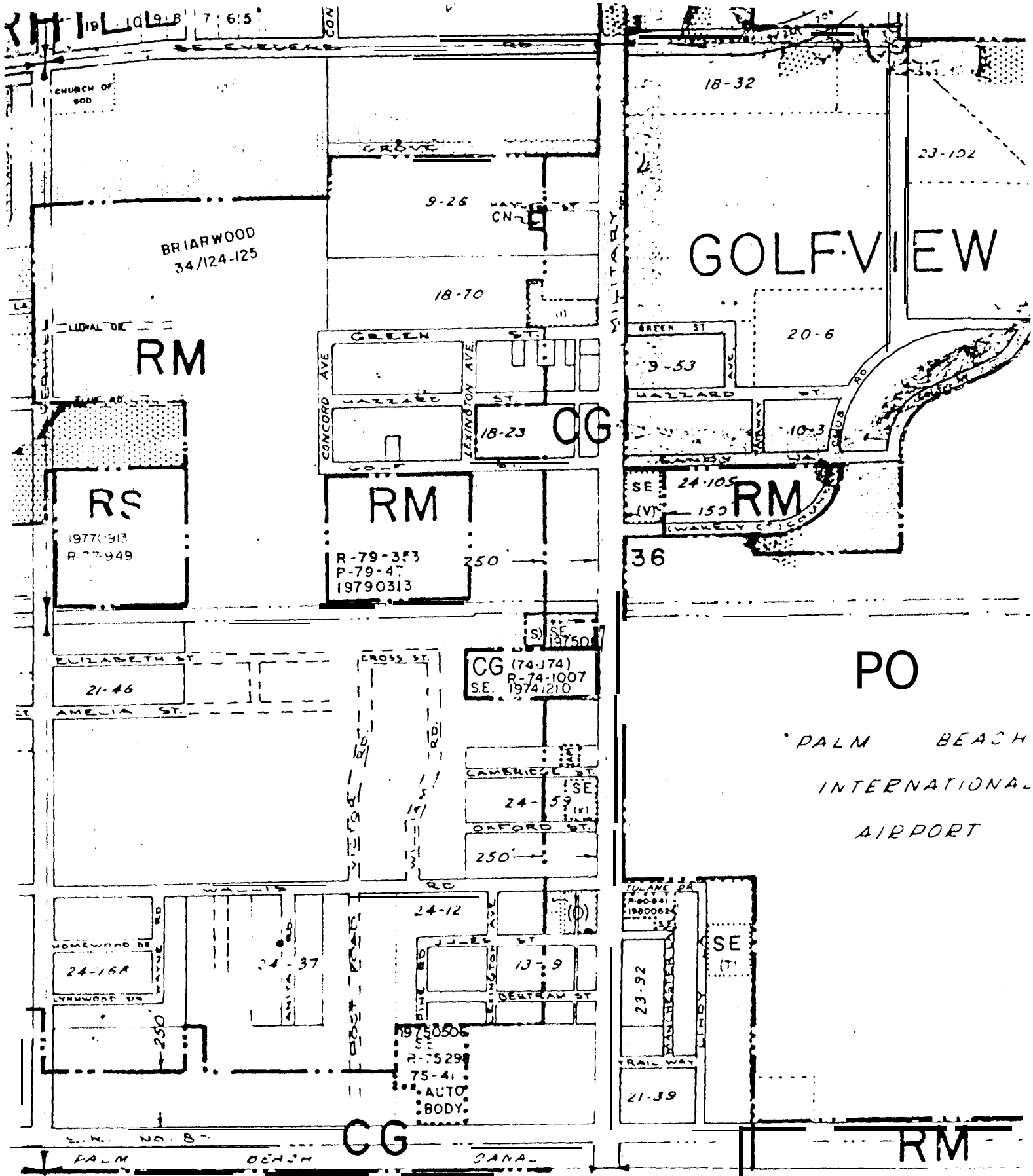

19-1019-B 7 6:5

CHURCH OF GOD

BRIARWOOD  
34/124-125

RM

RS

1977-913  
R-77-949

RM

R-79-353  
P-79-47  
19790313

CG (74-174)  
R-74-1007  
S.E. 19741210

SE 24-59 (K)

19750506  
R-75-298  
75-41  
• AUTO  
• BODY

CG

GOLF VIEW

RM

PO

PALM BEACH  
INTERNATIONAL  
AIRPORT

RM

3000

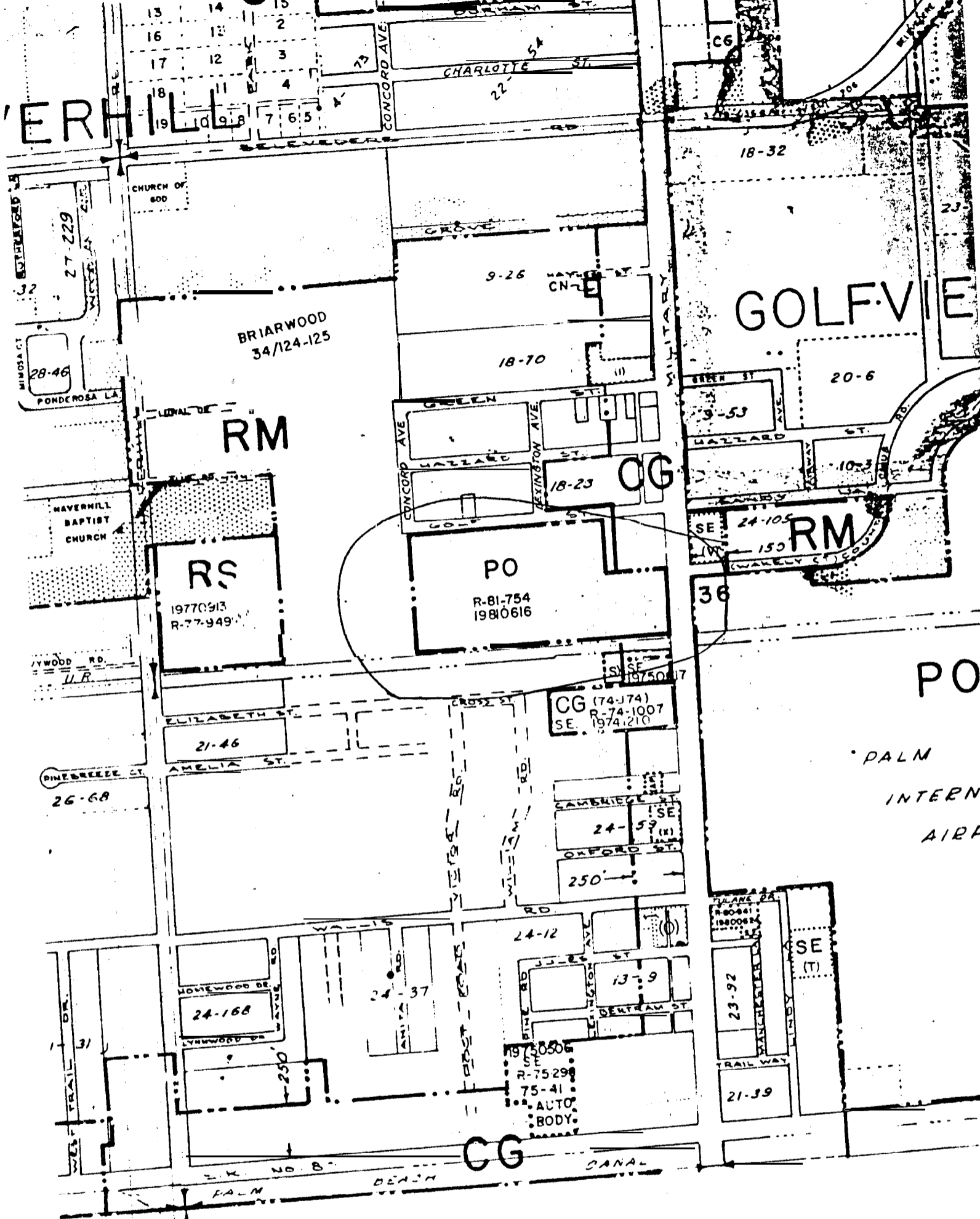

ERHILL

GOLFVIEW

RM

RS

19770913  
R-77-949

PO

R-81-754  
19810616

OG

RM

PO

PALM  
INTERNATIONAL  
AIRPORT

CG

31

- 13
- 14
- 15
- 16
- 17
- 18
- 19
- 10
- 9
- 8
- 7
- 6
- 5
- 2
- 3
- 4

BRIARWOOD  
34/124-125

9-26

18-70

18-32

20-6

18-23

24-105

36

CG (74-174)  
R-74-1007  
SE 1974.210

21-46

24-59

250

24-12

13-9

24-168

19750506  
R-7529  
75-41  
AUTO  
BODY

23-92

21-39

PALM BEACH CANAL

3000