



*Doc. Board/BL
P.B.C. EMERG. MGMT Building Dept*

Federal Emergency Management Agency

Washington, D.C. 20472

JUN 18 1996

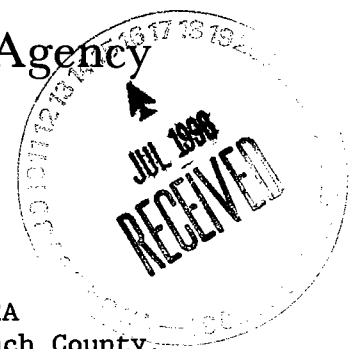

Mr. Ken L. Foster, Chairman
Palm Beach County Board of Commissioners
301 North Olive #1201
West Palm Beach, Florida 33401

IN REPLY REFER TO:
Case No.: 96-04-532A
Community: Palm Beach County,
Florida (Unincorporated
Areas)
Community No.: 120192
Map Panel No.: 0240 B

T-218-65-RS **42-47-27-27-000**
126 H43

Dear Mr. Foster:

This is in reference to a letter dated February 12, 1996, from Mr. Gregory S. Mire of CCL Consultants, Inc., requesting that the Federal Emergency Management Agency determine whether the property listed below is located within a Special Flood Hazard Area (SFHA), an area that would be inundated by the 1% annual chance flood. This property has been elevated by the placement of fill.

Property Description: Club Royale, as shown on Plat 81108876, Book 42, Pages 148 and 149, and recorded in the Palm Beach County Recorder's Office

Street Address: 6530, 6562, ~~6628~~, and 6662 Boca Del Mar Drive

Community: Palm Beach County (Unincorporated Areas)

State: Florida *NO SUCH ADDRESS*

On April 17, 1996, we received all of the information necessary to process Mr. Mire's request. After comparing this information with the National Flood Insurance Program (NFIP) map for Palm Beach County, Florida (Unincorporated Areas), we have determined that although portions of the property would be inundated by a 1% annual chance flood, the existing structures, building Nos 1, 2, 3 and the recreation building, on this property would not. Therefore, this letter revises the map for Palm Beach County, Florida (Unincorporated Areas) (NFIP Map Number 120192, Panel 0240 B, dated October 15, 1982), to remove these structures from the SFHA. These structures are located in Zone B, where flood insurance is available at low rates. Because portions of the property are located within the SFHA, any future construction or substantial improvement on this property remains subject to Federal, State, and local regulations for floodplain management.

It should be noted that this property could be inundated by a flood greater than the 1% annual chance flood or by local flooding conditions not shown on the NFIP map. Also, although we have based our determination on the information presently available, flood conditions may change or new information may be generated that would supersede this determination.

If a flood insurance policy has been issued under the NFIP covering the building on the aforementioned property and that policy was required by the mortgage company in conjunction with Federal flood insurance requirements, then flood insurance coverage is no longer required under those Federal requirements.

Accordingly, if a lender imposed the flood insurance requirement, that lender will have to determine whether or not to continue that requirement. The lender may determine, as a business decision, that it wishes to continue the flood insurance requirement in order to protect its collateral security on the loan.

Even though the structure are not located in an SFHA, as mentioned above, they could be flooded by a flooding event of greater magnitude than a 1% annual chance flood. In fact, more than twenty-five percent of all losses in the NFIP occur to buildings located outside the SFHA in Zone B, C, or X. More than one fourth of all policies purchased under the NFIP protect buildings located in these zones. That risk is just not as great as the flood risk to buildings located in SFHAs. In order to offer flood insurance protection to owners of such buildings, the NFIP offers two types of flood insurance policies: the Standard Policy and a policy for flood insurance at low rates. The low-rate policy is available for buildings located outside the SFHA with little or no loss history. The Standard Policy is available for all other buildings. Individual flood risk situations and insurance needs should be discussed with an insurance agent or company before making a final decision regarding flood insurance coverage.

A copy of this Letter of Map Revision is being forwarded to your community's official NFIP map repository where, in accordance with regulations adopted by your community, it should be attached to the community's official record copy of the NFIP map, which is available for public inspection.

To ensure continued eligibility to participate in the NFIP, your community must enforce its floodplain management regulations using, at a minimum, the flood elevations and zone designations shown on your community's NFIP map, including the revision made effective by this letter. This response to the request is based on the minimum criteria established by the NFIP. State and community officials, based on knowledge of local conditions and in the interest of public safety, may set higher standards for construction in the floodplain. If the State of Florida or your community has adopted more restrictive or comprehensive floodplain management criteria, these criteria take precedence over the minimum Federal criteria.

This revision has been made pursuant to Section 206 of the Flood Disaster Protection Act of 1973 (P.L. 93-234) and is in accordance with the National Flood Insurance Act of 1968, as amended (Title XIII of the Housing and Urban Development Act of 1968, P.L. 90-448) 42 U.S.C. 4001-4128, and 44 CFR Part 65.

This revision is effective as of the date of this letter. However, a request for reconsideration must be made within 30 days. Any requests for reconsideration must be based on scientific or technical data.



*Doc. BORDWBL
P.B.C. EMERG. MGMT Building Dept*

Federal Emergency Management Agency

Washington, D.C. 20472

JUN 18 1996

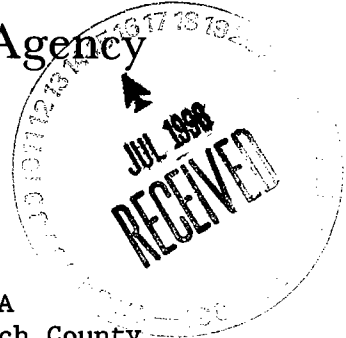

Mr. Ken L. Foster, Chairman
Palm Beach County Board of Commissioners
301 North Olive #1201
West Palm Beach, Florida 33401

IN REPLY REFER TO:
Case No.: 96-04-532A
Community: Palm Beach County,
Florida (Unincorporated
Areas)
Community No.: 120192
Map Panel No.: 0240 B

T-218-65-RS

*42-47-27-27-000
126 H43*

Dear Mr. Foster:

This is in reference to a letter dated February 12, 1996, from Mr. Gregory S. Mire of CCL Consultants, Inc., requesting that the Federal Emergency Management Agency determine whether the property listed below is located within a Special Flood Hazard Area (SFHA), an area that would be inundated by the 1% annual chance flood. This property has been elevated by the placement of fill.

Property Description:	Club Royale, as shown on Plat 81108876, Book 42, Pages 148 and 149, and recorded in the Palm Beach County Recorder's Office
Street Address:	6530, 6562, 6628 , and 6662 Boca Del Mar Drive
Community:	Palm Beach County (Unincorporated Areas)
State:	Florida

NO SUCH ADDRESS

On April 17, 1996, we received all of the information necessary to process Mr. Mire's request. After comparing this information with the National Flood Insurance Program (NFIP) map for Palm Beach County, Florida (Unincorporated Areas), we have determined that although portions of the property would be inundated by a 1% annual chance flood, the existing structures, building Nos 1, 2, 3, and the recreation building, on this property would not. Therefore, this letter revises the map for Palm Beach County, Florida (Unincorporated Areas) (NFIP Map Number 120192, Panel 0240 B, dated October 15, 1982), to remove these structures from the SFHA. These structures are located in Zone B, where flood insurance is available at low rates. Because portions of the property are located within the SFHA, any future construction or substantial improvement on this property remains subject to Federal, State, and local regulations for floodplain management.

It should be noted that this property could be inundated by a flood greater than the 1% annual chance flood or by local flooding conditions not shown on the NFIP map. Also, although we have based our determination on the information presently available, flood conditions may change or new information may be generated that would supersede this determination.

If a flood insurance policy has been issued under the NFIP covering the building on the aforementioned property and that policy was required by the mortgage company in conjunction with Federal flood insurance requirements, then flood insurance coverage is no longer required under those Federal requirements.

Accordingly, if a lender imposed the flood insurance requirement, that lender will have to determine whether or not to continue that requirement. The lender may determine, as a business decision, that it wishes to continue the flood insurance requirement in order to protect its collateral security on the loan.

Even though the structure are not located in an SFHA, as mentioned above, they could be flooded by a flooding event of greater magnitude than a 1% annual chance flood. In fact, more than twenty-five percent of all losses in the NFIP occur to buildings located outside the SFHA in Zone B, C, or X. More than one fourth of all policies purchased under the NFIP protect buildings located in these zones. That risk is just not as great as the flood risk to buildings located in SFHAs. In order to offer flood insurance protection to owners of such buildings, the NFIP offers two types of flood insurance policies: the Standard Policy and a policy for flood insurance at low rates. The low-rate policy is available for buildings located outside the SFHA with little or no loss history. The Standard Policy is available for all other buildings. Individual flood risk situations and insurance needs should be discussed with an insurance agent or company before making a final decision regarding flood insurance coverage.

A copy of this Letter of Map Revision is being forwarded to your community's official NFIP map repository where, in accordance with regulations adopted by your community, it should be attached to the community's official record copy of the NFIP map, which is available for public inspection.

To ensure continued eligibility to participate in the NFIP, your community must enforce its floodplain management regulations using, at a minimum, the flood elevations and zone designations shown on your community's NFIP map, including the revision made effective by this letter. This response to the request is based on the minimum criteria established by the NFIP. State and community officials, based on knowledge of local conditions and in the interest of public safety, may set higher standards for construction in the floodplain. If the State of Florida or your community has adopted more restrictive or comprehensive floodplain management criteria, these criteria take precedence over the minimum Federal criteria.

This revision has been made pursuant to Section 206 of the Flood Disaster Protection Act of 1973 (P.L. 93-234) and is in accordance with the National Flood Insurance Act of 1968, as amended (Title XIII of the Housing and Urban Development Act of 1968, P.L. 90-448) 42 U.S.C. 4001-4128, and 44 CFR Part 65.

This revision is effective as of the date of this letter. However, a request for reconsideration must be made within 30 days. Any requests for reconsideration must be based on scientific or technical data.

3

If you have any questions or if we can be of further assistance, please contact Helen Cohn at (202) 646-3457, or by facsimile at (202) 646-4596.

Sincerely,



Michael K. Buckley, P.E., Chief
Hazard Identification Branch
Mitigation Directorate

cc: State Coordinator
Mr. Gregory S. Mire, P.L.S.
Community Map Repository
Region

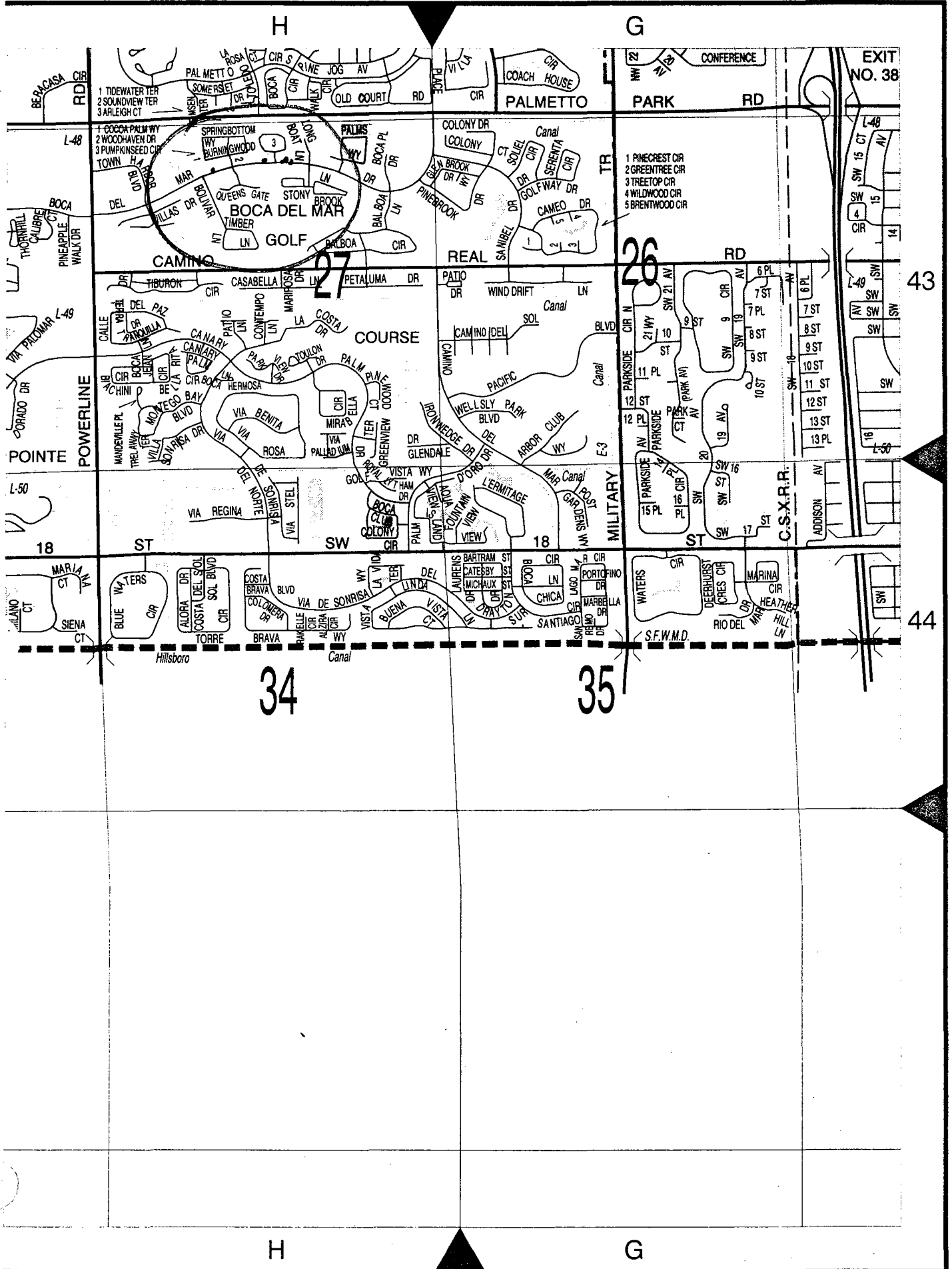

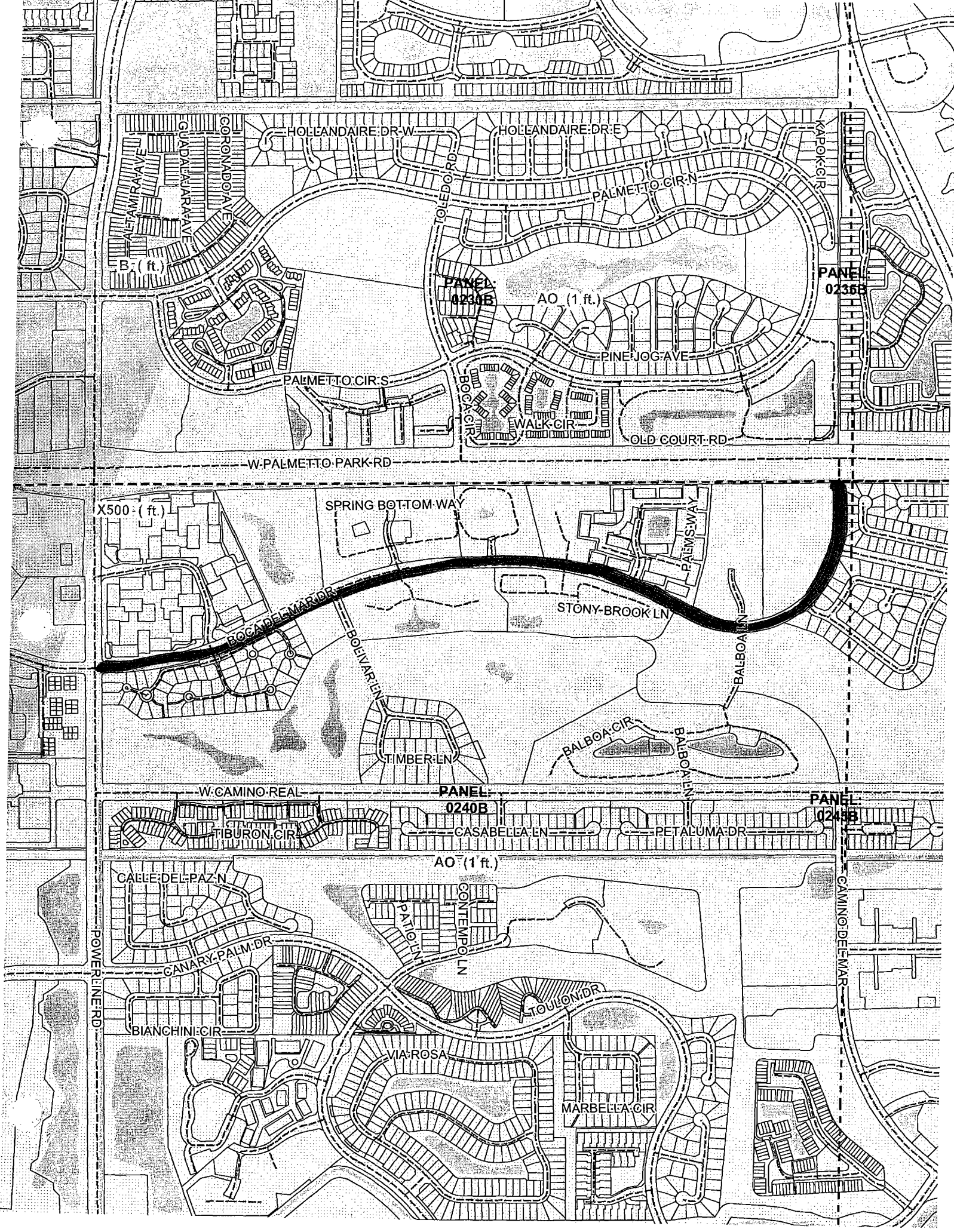

HOLLANDAIRE DR W
HOLLANDAIRE DR E
PALMETTO CIR N
PALMETTO CIR S
W PALMETTO PARK RD
PANEL 0230B
PANEL 0236B
AO (1 ft.)
PINE JOG AVE
OLD COURT RD

X500 (ft.)
SPRING BOTTOM WAY
BOCA DEL MAR DR
BOIVARD LN
STONY BROOK LN
BALBOA LN
BALBOA CIR
BALBOA LN
TIMBER LN
W CAMINO REAL
PANEL 0240B
PANEL 0245B
AO (1 ft.)

CALLE DEL PAZ N
CANARY PALM DR
BIANCHINI CIR
PATON LN
CONTEMPO LN
TOULON DR
VIA ROSA
MARBELLA CIR
CAMINO DEL MAR



Gary R. Nikolits, CFA
 Palm Beach County Property Appraiser
 Public Access System

all PENS → B

[Back to Search](#)

Rows 1 to 50 displayed

Click on row to see more information

[Next](#)

Owner Name	Situs Address	Parcel Control Number
<u>LODER MARC &</u>	6530 BOCA DEL MAR DR 131	00424727290001310
<u>RABIN ARNO</u>	6530 BOCA DEL MAR DR 132	00424727290001320
<u>RABIN MARY</u>	6530 BOCA DEL MAR DR 132	00424727290001320
<u>LEIBOWITZ FRANCES A</u>	6530 BOCA DEL MAR DR 133	00424727290001330
<u>GROVES JOHN D & JOSEPHINE</u>	6530 BOCA DEL MAR DR 134	00424727290001340
<u>RUSTAD NIESA C</u>	6530 BOCA DEL MAR DR 135	00424727290001350
<u>ARMIJO ROBERT D</u>	6530 BOCA DEL MAR DR 136	00424727290001360
<u>JUSTIN SHIRLEY S</u>	6530 BOCA DEL MAR DR 137	00424727290001370
<u>JACOBY KENNETH & META J</u>	6530 BOCA DEL MAR DR 138	00424727290001380
<u>JACOBY META J</u>	6530 BOCA DEL MAR DR 138	00424727290001380
<u>WATERS DOUGLAS &</u>	6530 BOCA DEL MAR DR 231	00424727290002310
<u>WATERS MARGARET</u>	6530 BOCA DEL MAR DR 231	00424727290002310
<u>PACHUTA MARGORIE R</u>	6530 BOCA DEL MAR DR 232	00424727290002320
<u>MILICZKY BERNADETTE R</u>	6530 BOCA DEL MAR DR 233	00424727290002330
<u>MELLO LUCIANA FERRARI</u>	6530 BOCA DEL MAR DR 234	00424727290002340
<u>FAKLER JOHN L</u>	6530 BOCA DEL MAR DR 235	00424727290002350
<u>FAKLER JEAN</u>	6530 BOCA DEL MAR DR 235	00424727290002350
<u>KALOMIRIS GEORGE & MARY</u>	6530 BOCA DEL MAR DR 236	00424727290002360
<u>KAWER BENJAMIN & ESTHER I</u>	6530 BOCA DEL MAR DR 237	00424727290002370
<u>HENKEN PHYLLIS</u>	6530 BOCA DEL MAR DR 238	00424727290002380
<u>SUNDAY STEPHEN F &</u>	6530 BOCA DEL MAR DR 331	00424727290003310
<u>SUNDAY SUSAN J</u>	6530 BOCA DEL MAR DR 331	00424727290003310
<u>AMOIA ANN D</u>	6530 BOCA DEL MAR DR 332	00424727290003320
<u>ROSENTHAL WILLIAM & MARY</u>	6530 BOCA DEL MAR DR 333	00424727290003330
<u>ROSENTHAL MARY</u>	6530 BOCA DEL MAR DR 333	00424727290003330
<u>LEVI KIRK L &</u>	6530 BOCA DEL MAR DR 334	00424727290003340
<u>LEVI BARBARA A</u>	6530 BOCA DEL MAR DR 334	00424727290003340
<u>HURWITZ HELEN &</u>	6530 BOCA DEL MAR DR 335	00424727290003350
<u>CARLETON GAIL S</u>	6530 BOCA DEL MAR DR 335	00424727290003350
<u>REICHNER CAROLYN R</u>	6530 BOCA DEL MAR DR 336	00424727290003360
<u>KIP DEBORAH &</u>	6530 BOCA DEL MAR DR 337	00424727290003370
<u>KIP RICHARD</u>	6530 BOCA DEL MAR DR 337	00424727290003370
<u>DOBROFSKY P & ESTHER ET AL</u>	6530 BOCA DEL MAR DR 338	00424727290003380
<u>SILVERBERG LARRY &</u>	6530 BOCA DEL MAR DR 431	00424727290004310
<u>ZIFF RUTH B</u>	6530 BOCA DEL MAR DR 432	00424727290004320
<u>BAUMWELL FLORENCE</u>	6530 BOCA DEL MAR DR 433	00424727290004330
<u>FREELAND LOURYCE &</u>	6530 BOCA DEL MAR DR 434	00424727290004340
<u>BARATZ BONITA</u>	6530 BOCA DEL MAR DR 434	00424727290004340
<u>MYERS JACK J</u>	6530 BOCA DEL MAR DR 435	00424727290004350

<u>SPIESS ALLEN E JR</u>	6530 BOCA DEL MAR DR 435	00424727290004350
<u>LADIAS PETER H &</u>	6530 BOCA DEL MAR DR 436	00424727290004360
<u>LADIAS ANGELA N</u>	6530 BOCA DEL MAR DR 436	00424727290004360
<u>LANE BARBARA</u>	6530 BOCA DEL MAR DR 437	00424727290004370
<u>AXELROD IRIS</u>	6530 BOCA DEL MAR DR 438	00424727290004380
<u>LEVINE MARY</u>	6530 BOCA DEL MAR DR 531	00424727290005310
<u>FROMM EILEEN</u>	6530 BOCA DEL MAR DR 532	00424727290005320
<u>PICARDI RACHEL T</u>	6530 BOCA DEL MAR DR 533	00424727290005330
<u>PICARDI RACHEL T TR</u>	6530 BOCA DEL MAR DR 533	00424727290005330
<u>COHAN EUGENE & JOAN</u>	6530 BOCA DEL MAR DR 534	00424727290005340
<u>COHAN JOAN</u>	6530 BOCA DEL MAR DR 534	00424727290005340

Next

[| Home |](#)
[| Back |](#)
[| Search |](#)

Please send us your feedback

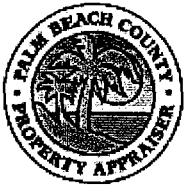
Copyright © 2002 by Palm Beach County Property Appraiser
 All Rights Reserved



Gary R. Nikolits, CFA
Palm Beach County Property Appraiser
Public Access System

Back to Search

Rows 51 to 79 displayed

Click on row to see more information



Owner Name	Situs Address	Parcel Control Number
<u>GRILLO ALFRED T & THERESA</u>	6530 BOCA DEL MAR DR 535	00424727290005350
<u>GRILLO THERESA</u>	6530 BOCA DEL MAR DR 535	00424727290005350
<u>MITCHELL ANN</u>	6530 BOCA DEL MAR DR 536	00424727290005360
<u>GROSKINSKY HENRY J &</u>	6530 BOCA DEL MAR DR 537	00424727290005370
<u>GROSKINSKY ALMA P</u>	6530 BOCA DEL MAR DR 537	00424727290005370
<u>STUMACHER JUDITH L TR</u>	6530 BOCA DEL MAR DR 538	00424727290005380
<u>SWEENEY THOMAS M &</u>	6530 BOCA DEL MAR DR 631	00424727290006310
<u>SWEENEY DAWN</u>	6530 BOCA DEL MAR DR 631	00424727290006310
<u>YAROSS ANITA J</u>	6530 BOCA DEL MAR DR 632	00424727290006320
<u>MILLER KENNETH B & BONNIE J</u>	6530 BOCA DEL MAR DR 633	00424727290006330
<u>FRUCHTER SUZANNE C</u>	6530 BOCA DEL MAR DR 634	00424727290006340
<u>BARSHOV RUTH</u>	6530 BOCA DEL MAR DR 635	00424727290006350
<u>LATOREE LOHELIA</u>	6530 BOCA DEL MAR DR 636	00424727290006360
<u>MENDELSON JAC K & ELEANOR</u>	6530 BOCA DEL MAR DR 637	00424727290006370
<u>MENDELSON ELEANOR</u>	6530 BOCA DEL MAR DR 637	00424727290006370
<u>GELB MILTON</u>	6530 BOCA DEL MAR DR 638	00424727290006380
<u>GELB HELEN</u>	6530 BOCA DEL MAR DR 638	00424727290006380
<u>JARJURA ANNA M</u>	6530 BOCA DEL MAR DR 731	00424727290007310
<u>OBRIEN JOYCE</u>	6530 BOCA DEL MAR DR 732	00424727290007320
<u>MARKOWITZ GERALD TR</u>	6530 BOCA DEL MAR DR 733	00424727290007330
<u>RUBIN RITA G TR</u>	6530 BOCA DEL MAR DR 733	00424727290007330
<u>HARTRICK MARY A REV TRUST</u>	6530 BOCA DEL MAR DR 734	00424727290007340
<u>ITTS RENEE</u>	6530 BOCA DEL MAR DR 735	00424727290007350
<u>BONGIORNO ADOLPH A &</u>	6530 BOCA DEL MAR DR 736	00424727290007360
<u>BONGIORNO FLORA M</u>	6530 BOCA DEL MAR DR 736	00424727290007360
<u>BONGIORNO ADOLPH A TR</u>	6530 BOCA DEL MAR DR 736	00424727290007360
<u>BONGIORNO FLORA M TR</u>	6530 BOCA DEL MAR DR 736	00424727290007360
<u>SHUMANSKI JEAN</u>	6530 BOCA DEL MAR DR 737	00424727290007370
<u>FRANKLIN MARC B</u>	6530 BOCA DEL MAR DR 738	00424727290007380



[| Home |](#) [| Back |](#) [| Search |](#)
Please send us your feedback

Copyright © 2002 by Palm Beach County Property Appraiser
 All Rights Reserved



Gary R. Nikolits, CFA
Palm Beach County Property Appraiser
Public Access System

[Back to Search](#)

Rows 1 to 50 displayed

Click on row to see more information

[Next](#)

Owner Name	Situs Address	Parcel Control Number
TAYLOR ROBERT &	6562 BOCA DEL MAR DR 121	00424727290001210
TAYLOR CAROL G	6562 BOCA DEL MAR DR 121	00424727290001210
SHERECK NORMA	6562 BOCA DEL MAR DR 1220	00424727290001220
STRATTAN MILDRED M	6562 BOCA DEL MAR DR 1230	00424727290001230
ARCE WILLIAM F &	6562 BOCA DEL MAR DR 1240	00424727290001240
ARCE LORI A	6562 BOCA DEL MAR DR 1240	00424727290001240
GAGE DONNA LEE	6562 BOCA DEL MAR DR 1250	00424727290001250
WEPPNER A VIRGINIA	6562 BOCA DEL MAR DR 126	00424727290001260
WEPPNER A VIRGINIA TR	6562 BOCA DEL MAR DR 126	00424727290001260
SHOLLENBERGER DENNIS W	6562 BOCA DEL MAR DR 1270	00424727290001270
SHOLLENBERGER JUNE G	6562 BOCA DEL MAR DR 1270	00424727290001270
MOSS WILLIAM & FRED A	6562 BOCA DEL MAR DR 1280	00424727290001280
MOSS FRED A	6562 BOCA DEL MAR DR 1280	00424727290001280
FRANKEL JUDITH A	6562 BOCA DEL MAR DR 2210	00424727290002210
VANNORTWICK THOMAS H TR	6562 BOCA DEL MAR DR 2220	00424727290002220
DOWNHILL ROBERT E & KAREN R	6562 BOCA DEL MAR DR 223	00424727290002230
DOWNHILL KAREN R	6562 BOCA DEL MAR DR 223	00424727290002230
BENNER JEAN B	6562 BOCA DEL MAR DR 224	00424727290002240
BENNER JEAN B TR	6562 BOCA DEL MAR DR 224	00424727290002240
GREENE JANE M	6562 BOCA DEL MAR DR 225	00424727290002250
FENNELL GEORGE E	6562 BOCA DEL MAR DR 226	00424727290002260
LANDY ROSALYN M	6562 BOCA DEL MAR DR 2270	00424727290002270
GRIFFIN DONALD C	6562 BOCA DEL MAR DR 2280	00424727290002280
LEVIN HOWARD S &	6562 BOCA DEL MAR DR 3210	00424727290003210
BIRO RANDY TR	6562 BOCA DEL MAR DR 3210	00424727290003210
LEVIN SHIRLEE	6562 BOCA DEL MAR DR 3210	00424727290003210
LEVIN SHIRLEE TR	6562 BOCA DEL MAR DR 3210	00424727290003210
LEVIN HOWARD S TR	6562 BOCA DEL MAR DR 3210	00424727290003210
ATEN PATRICIA A	6562 BOCA DEL MAR DR 322	00424727290003220
SAWYER DONALD G &	6562 BOCA DEL MAR DR 3230	00424727290003230
SAWYER STELLA G	6562 BOCA DEL MAR DR 3230	00424727290003230
SWEENEY THOMAS M &	6562 BOCA DEL MAR DR 324	00424727290003240
SWEENEY DAWN	6562 BOCA DEL MAR DR 324	00424727290003240
MARQUARDT WILLIAM F &	6562 BOCA DEL MAR DR 3250	00424727290003250
MARQUARDT DONNA M	6562 BOCA DEL MAR DR 3250	00424727290003250
GIUDICI PETER R	6562 BOCA DEL MAR DR 3250	00424727290003250
GIUDICI CYNTHIA S	6562 BOCA DEL MAR DR 3250	00424727290003250
SMITH CONSTANCE E	6562 BOCA DEL MAR DR 3260	00424727290003260
PANTINO FAMILY TRUST	6562 BOCA DEL MAR DR 3270	00424727290003270

<u>WEXLER BARBARA</u>	6562 BOCA DEL MAR DR 328	00424727290003280
<u>METZ MARGARET L</u>	6562 BOCA DEL MAR DR 421	00424727290004210
<u>COLLINS DOROTHY A</u>	6562 BOCA DEL MAR DR 4220	00424727290004220
<u>COLLINS ROBERT SCOTT TR</u>	6562 BOCA DEL MAR DR 4220	00424727290004220
<u>COLLINS DOROTHY A TR</u>	6562 BOCA DEL MAR DR 4220	00424727290004220
<u>STERN NORBERT MICHAEL</u>	6562 BOCA DEL MAR DR 42	00424727290004230
<u>MILLER ANA L</u>	6562 BOCA DEL MAR DR 424	00424727290004240
<u>MAKRANCY EMORY D &</u>	6562 BOCA DEL MAR DR 425	00424727290004250
<u>MAKRANCY ELIZABETH F</u>	6562 BOCA DEL MAR DR 425	00424727290004250
<u>VANZYVERDEN JEAN</u>	6562 BOCA DEL MAR DR 4260	00424727290004260
<u>COOPER PAMILA</u>	6562 BOCA DEL MAR DR 4270	00424727290004270

[Next](#)[| Home |](#) [| Back |](#) [| Search |](#)

Please send us your feedback

Copyright © 2002 by Palm Beach County Property Appraiser
All Rights Reserved



Gary R. Nikolits, CFA
Palm Beach County Property Appraiser
Public Access System

Back to Search

Rows 51 to 85 displayed

Click on row to see more information



Owner Name	Situs Address	Parcel Control Number
<u>LOVISA HANS TR</u>	6562 BOCA DEL MAR DR 4280	00424727290004280
<u>NEMORE HENRY L & HARRIETTE</u>	6562 BOCA DEL MAR DR 5210	00424727290005210
<u>HARRIETTE NEMORE</u>	6562 BOCA DEL MAR DR 5210	00424727290005210
<u>KLINE MORRIS & CHARLOTTE</u>	6562 BOCA DEL MAR DR 5220	00424727290005220
<u>KLINE CHARLOTTE</u>	6562 BOCA DEL MAR DR 5220	00424727290005220
<u>AMIEL ANDRE &</u>	6562 BOCA DEL MAR DR 5230	00424727290005230
<u>SIMY M AMIEL</u>	6562 BOCA DEL MAR DR 5230	00424727290005230
<u>MARQUISEE LOUIS A</u>	6562 BOCA DEL MAR DR 524	00424727290005240
<u>MARQUISEE LOUIS A TR</u>	6562 BOCA DEL MAR DR 524	00424727290005240
<u>BRANDEL MARY N</u>	6562 BOCA DEL MAR DR 525	00424727290005250
<u>MARANGOS PETER J</u>	6562 BOCA DEL MAR DR 5260	00424727290005260
<u>MARANGOS FRANCES</u>	6562 BOCA DEL MAR DR 5260	00424727290005260
<u>WACHS DAVID I & ILEEN</u>	6562 BOCA DEL MAR DR 527	00424727290005270
<u>WACHS ILEEN</u>	6562 BOCA DEL MAR DR 527	00424727290005270
<u>KAPLAN HOWARD S & SHIRLEY</u>	6562 BOCA DEL MAR DR 5280	00424727290005280
<u>NERLICH MAXINE L</u>	6562 BOCA DEL MAR DR 6210	00424727290006210
<u>SCLAFANI JOHN</u>	6562 BOCA DEL MAR DR 622	00424727290006220
<u>CASAL OBDULIA A</u>	6562 BOCA DEL MAR DR 623	00424727290006230
<u>FUCARILE THOMAS M JR</u>	6562 BOCA DEL MAR DR 6240	00424727290006240
<u>DUMOT MICHEL L JOURDAN &</u>	6562 BOCA DEL MAR DR 6250	00424727290006250
<u>CHAPARRO ADRIANA</u>	6562 BOCA DEL MAR DR 6250	00424727290006250
<u>GOLD MICHAEL</u>	6562 BOCA DEL MAR DR 626	00424727290006260
<u>DONLON FRANK J JR & JO ANN</u>	6562 BOCA DEL MAR DR 6270	00424727290006270
<u>MCDONOUGH ANN K</u>	6562 BOCA DEL MAR DR 628	00424727290006280
<u>COSTA JOSEPH W & HELEN</u>	6562 BOCA DEL MAR DR 721	00424727290007210
<u>COSTA HELEN</u>	6562 BOCA DEL MAR DR 721	00424727290007210
<u>VERRUSO JANICE N</u>	6562 BOCA DEL MAR DR 722	00424727290007220
<u>CASTELLANOS JAVIER &</u>	6562 BOCA DEL MAR DR 7230	00424727290007230
<u>CASTELLANOS KATHERINA</u>	6562 BOCA DEL MAR DR 7230	00424727290007230
<u>BERGER ROBERT & ANTOINETTA R</u>	6562 BOCA DEL MAR DR 7240	00424727290007240
<u>LIGHTER STEPHANIE</u>	6562 BOCA DEL MAR DR 725	00424727290007250
<u>RUSH RICHARD L &</u>	6562 BOCA DEL MAR DR 726	00424727290007260
<u>RUSH SUSAN A</u>	6562 BOCA DEL MAR DR 726	00424727290007260
<u>TOOVEY VALERIE A</u>	6562 BOCA DEL MAR DR 7270	00424727290007270
<u>POLLACK MURIEL &</u>	6562 BOCA DEL MAR DR 728	00424727290007280



[| Home |](#) [| Back |](#) [| Search |](#)



Please send us your feedback



Gary R. Nikolits, CFA
Palm Beach County Property Appraiser
Public Access System

[Back to Search](#)

Rows 1 to 50 displayed

Click on row to see more information

[Next](#)

Owner Name	Situs Address	Parcel Control Number
LEGGAT VIRGINIA R	6662 BOCA DEL MAR DR 1110	00424727290001110
SIMON HERMAN	6662 BOCA DEL MAR DR 112	00424727290001120
SIMON LUCILLE	6662 BOCA DEL MAR DR 112	00424727290001120
SANTIAGO STEVEN &	6662 BOCA DEL MAR DR 113	00424727290001130
ALLISON TAUB	6662 BOCA DEL MAR DR 113	00424727290001130
FRIEDMAN ROBERT O	6662 BOCA DEL MAR DR 1140	00424727290001140
OSWALD DELORES J	6662 BOCA DEL MAR DR 115	00424727290001150
DUFTY ANGELINE	6662 BOCA DEL MAR DR 1160	00424727290001160
MOSCHKOVICH ROSA TR	6662 BOCA DEL MAR DR 1170	00424727290001170
BOGARD ADELE M TR	6662 BOCA DEL MAR DR 118	00424727290001180
MILLER JONATHAN D &	6662 BOCA DEL MAR DR 211	00424727290002110
BERNAT LUCY R	6662 BOCA DEL MAR DR 212	00424727290002120
BUNIN JUNE B	6662 BOCA DEL MAR DR 213	00424727290002130
CLARK RONALD C	6662 BOCA DEL MAR DR 2140	00424727290002140
CLARK RUTH I	6662 BOCA DEL MAR DR 2140	00424727290002140
BOHRI JAMES DAVID &	6662 BOCA DEL MAR DR 2150	00424727290002150
BOHRI MARY BETH	6662 BOCA DEL MAR DR 2150	00424727290002150
TRAUB SEYMOUR	6662 BOCA DEL MAR DR 2160	00424727290002160
KELLY WILLIAM M SR &	6662 BOCA DEL MAR DR 217	00424727290002170
CALCAGNO SANDRA	6662 BOCA DEL MAR DR 217	00424727290002170
SWEENEY FRANCIS &	6662 BOCA DEL MAR DR 218	00424727290002180
SWEENEY ARLINE	6662 BOCA DEL MAR DR 218	00424727290002180
WEPPNER DANIEL B & JOANNE F	6662 BOCA DEL MAR DR 311	00424727290003110
JOANNE F WEPPNER	6662 BOCA DEL MAR DR 311	00424727290003110
DAHLIN ED	6662 BOCA DEL MAR DR 312	00424727290003120
SILBER SARA	6662 BOCA DEL MAR DR 3130	00424727290003130
SILBER SARA TR	6662 BOCA DEL MAR DR 3130	00424727290003130
HUTCHINSON MARY	6662 BOCA DEL MAR DR 3140	00424727290003140
HUTCHINSON MARY TR	6662 BOCA DEL MAR DR 3140	00424727290003140
FORSTOT S LANCE & LYNNE	6662 BOCA DEL MAR DR 3150	00424727290003150
DOVAS ANGELO	6662 BOCA DEL MAR DR 3160	00424727290003160
KAPEL SUSAN S	6662 BOCA DEL MAR DR 3170	00424727290003170
ANDERSON GOLDIE	6662 BOCA DEL MAR DR 3180	00424727290003180
ROSVALLY LUCY M	6662 BOCA DEL MAR DR 4110	00424727290004110
MCNAMARA ANN E	6662 BOCA DEL MAR DR 4120	00424727290004120
ARCHER KAREN B	6662 BOCA DEL MAR DR 4130	00424727290004130
BOLNO MADELEINE T	6662 BOCA DEL MAR DR 4140	00424727290004140
MARDER RUTH L TR	6662 BOCA DEL MAR DR 4150	00424727290004150
KLEGER LAWRENCE A	6662 BOCA DEL MAR DR 4160	00424727290004160



Gary R. Nikolits, CFA
 Palm Beach County Property Appraiser
 Public Access System

Back to Search

Rows 51 to 77 displayed

Click on row to see more information



Owner Name	Situs Address	Parcel Control Number
<u>WARDWELL DUANE E &</u>	6662 BOCA DEL MAR DR 5160	00424727290005160
<u>WARDWELL ANN M</u>	6662 BOCA DEL MAR DR 5160	00424727290005160
<u>CUGLIETTA GEORGIANNA F</u>	6662 BOCA DEL MAR DR 5170	00424727290005170
<u>MARSHALL MARILU</u>	6662 BOCA DEL MAR DR 518	00424727290005180
<u>JOSEPHER MORRIS & RHODA</u>	6662 BOCA DEL MAR DR 611	00424727290006110
<u>JOSEPHER RHODA</u>	6662 BOCA DEL MAR DR 611	00424727290006110
<u>BICHELMAN NORMAN & DIANE</u>	6662 BOCA DEL MAR DR 6120	00424727290006120
<u>DIANE BICHELMAN</u>	6662 BOCA DEL MAR DR 6120	00424727290006120
<u>FREEMAN GLENN &</u>	6662 BOCA DEL MAR DR 6130	00424727290006130
<u>FREEMAN NILA</u>	6662 BOCA DEL MAR DR 6130	00424727290006130
<u>GORDON EVELYN D &</u>	6662 BOCA DEL MAR DR 614	00424727290006140
<u>HAROLD S GORDON</u>	6662 BOCA DEL MAR DR 614	00424727290006140
<u>MARDER MYRON DAVID TR</u>	6662 BOCA DEL MAR DR 6150	00424727290006150
<u>REGALBUTO CHARLES M</u>	6662 BOCA DEL MAR DR 616	00424727290006160
<u>SILVA ROBERT F & VERONICA M</u>	6662 BOCA DEL MAR DR 6170	00424727290006170
<u>CARLSON RAYMOND L &</u>	6662 BOCA DEL MAR DR 6180	00424727290006180
<u>CARLSON CAROL</u>	6662 BOCA DEL MAR DR 6180	00424727290006180
<u>LONERGAN JOHN A</u>	6662 BOCA DEL MAR DR 711	00424727290007110
<u>ASHTON MARY ANNE</u>	6662 BOCA DEL MAR DR 712	00424727290007120
<u>KIRBY TIMOTHY</u>	6662 BOCA DEL MAR DR 7130	00424727290007130
<u>TARDY FRANK G &</u>	6662 BOCA DEL MAR DR 7140	00424727290007140
<u>TARDY CLARA M</u>	6662 BOCA DEL MAR DR 7140	00424727290007140
<u>MARDER RUTH L TR</u>	6662 BOCA DEL MAR DR 7150	00424727290007150
<u>RIXON PAUL A JR & ROSEMARY K</u>	6662 BOCA DEL MAR DR 716	00424727290007160
<u>RIXON ROSEMARY K</u>	6662 BOCA DEL MAR DR 716	00424727290007160
<u>BOWMAN DOROTHY</u>	6662 BOCA DEL MAR DR 7170	00424727290007170
<u>GAGLIARDI THOMAS EST</u>	6662 BOCA DEL MAR DR 718	00424727290007180



[| Home |](#) [| Back |](#) [| Search |](#)



Please send us your feedback

Copyright © 2002 by Palm Beach County Property Appraiser
 All Rights Reserved