

# OLD MARSH GOLF CLUB REPLAT No. 7 (a P.U.D.)

BEING A REPLAT OF LOT 178, OLD MARSH GOLF CLUB (a P.U.D.), ACCORDING TO THE PLAT THEREOF, RECORDED IN PLAT BOOK 58, PAGE 62 AND LOT A, OLD MARSH GOLF CLUB MINOR REPLAT, ACCORDING TO THE PLAT THEREOF, RECORDED IN PLAT BOOK 85, PAGE 191, PUBLIC RECORDS OF PALM BEACH COUNTY, FLORIDA, LYING IN SECTION 28, TOWNSHIP 41 SOUTH, RANGE 42 EAST, PALM BEACH COUNTY, FLORIDA  
APRIL, 2000

# 134

COUNTY OF PALM BEACH )  
STATE OF FLORIDA ) ss  
The Plat was filed for record at 2:36 P.M.,  
This day of November, 2001,  
and duly recorded in Plat Book No. 92  
at page 3-134-135.  
EDGOTHY H. WILSON, Clerk of Circuit Court  
by Sally Hamadeh s/c.

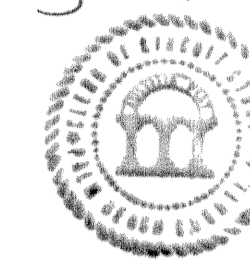

SHEET 1 OF 2

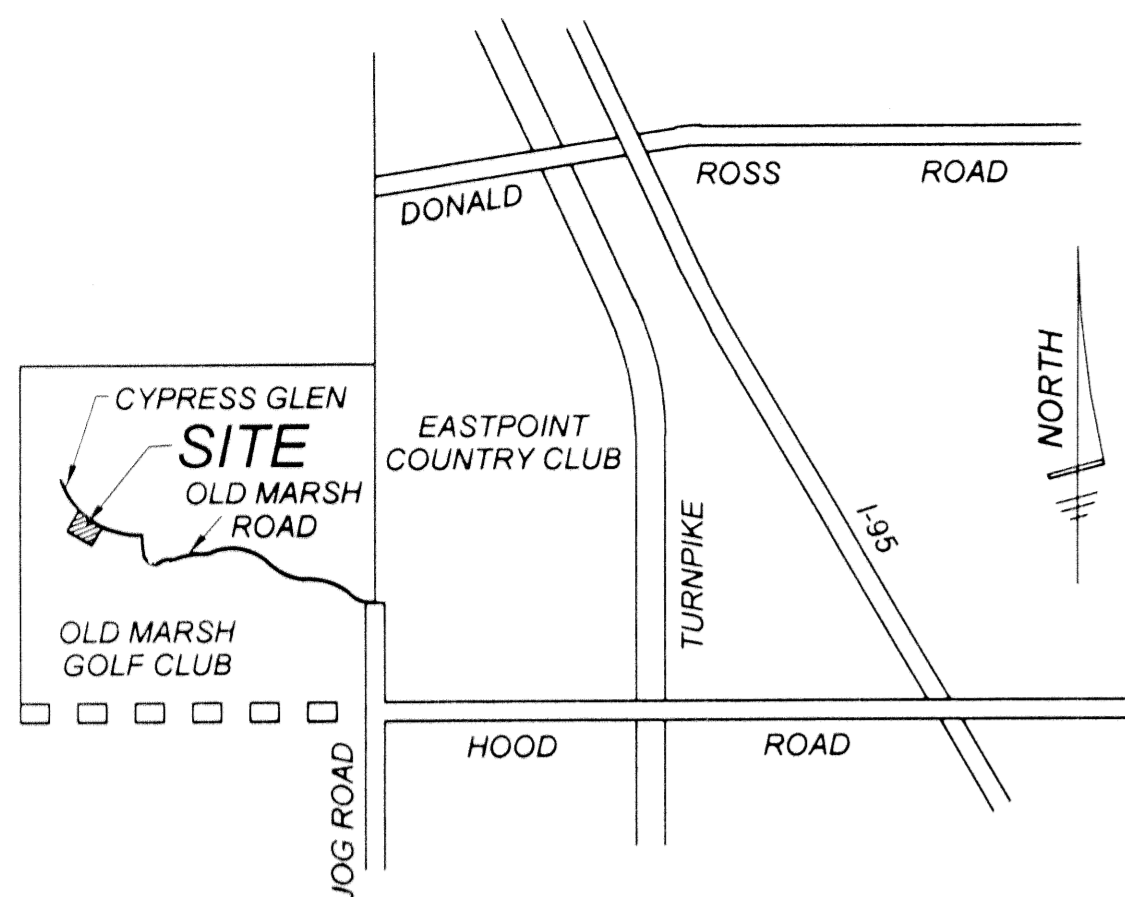

VICINITY SKETCH  
(NOT TO SCALE)

### DEDICATION

KNOW ALL MEN BY THESE PRESENTS that FRANK P. DOYLE & RICHARD BERKOWITZ, OR THEIR SUCCESSORS, TRUSTEES OF THE FRANK P. DOYLE AMENDED AND RESTATED REVOCABLE TRUST U/D/T 8/13/93, owners of the land shown hereon, being in Section 28, Township 41 South, Range 42 East, Palm Beach County, Florida, shown hereon as OLD MARSH GOLF CLUB REPLAT NO. 7 (a P.U.D.), being a replat of Lot 178, OLD MARSH GOLF CLUB, (a P.U.D.) according to the plat thereof, recorded in Plat Book 58, Page 62, and Lot A, OLD MARSH GOLF CLUB MINOR REPLAT, according to the plat thereof, recorded in Plat Book 85, Page 191, Public Records of Palm Beach County, Florida, lying in Section 28, Township 41 South, Range 42 East, Palm Beach County, Florida, being more particularly described as follows:

### DESCRIPTION

Lot 178, OLD MARSH GOLF CLUB (a P.U.D.), according to the plat thereof, recorded in Plat Book 58, Page 62, Public Records of Palm Beach County, Florida, lying in Section 28, Township 41 South, Range 42 East, Palm Beach County, Florida.

### TOGETHER WITH:

Lot A, OLD MARSH GOLF CLUB MINOR REPLAT, according to the plat thereof, recorded in Plat Book 85, Page 191, Public Records of Palm Beach County, Florida, lying in Section 28, Township 41 South, Range 42 East, Palm Beach County, Florida.

Containing in all, 1.544 acres, more or less.

has caused the same to be surveyed and platted as shown hereon and do hereby dedicate as follows:

### LOT 178A

LOT 178 A, as shown hereon, is hereby reserved to FRANK P. DOYLE & RICHARD BERKOWITZ, OR THEIR SUCCESSORS, TRUSTEES OF THE FRANK P. DOYLE AMENDED AND RESTATED REVOCABLE TRUST U/D/T 8/13/93, their successors and assigns, for residential purposes and other purposes not inconsistent with this reservation and is the perpetual maintenance obligation of said FRANK P. DOYLE & RICHARD BERKOWITZ, OR THEIR SUCCESSORS, TRUSTEES OF THE FRANK P. DOYLE AMENDED AND RESTATED REVOCABLE TRUST U/D/T 8/13/93, their successors and assigns, without recourse to Palm Beach County, Florida.

IN WITNESS WHEREOF, We FRANK P. DOYLE & RICHARD BERKOWITZ, OR THEIR SUCCESSORS, TRUSTEES OF THE FRANK P. DOYLE AMENDED AND RESTATED REVOCABLE TRUST U/D/T 8/13/93, do hereunto set our hands and seals this 4th day of October, 2001.

WITNESS: Carol Collins  
Carol Collins  
Printed Name

By: Frank P. Doyle  
Frank P. Doyle  
as Trustee

WITNESS: Ivana Money  
Ivana Money  
Printed Name

WITNESS: Carol Collins  
Carol Collins  
Printed Name

By: Richard Berkowitz  
Richard Berkowitz  
as Trustee

WITNESS: Ivana Money  
Ivana Money  
Printed Name

### ACKNOWLEDGEMENT

State of Conn.  
County of Fairfield

BEFORE me personally appeared Frank P. Doyle, trustee of the FRANK P. DOYLE AMENDED AND RESTATED REVOCABLE TRUST U/D/T 8/13/93, who is personally known to me or has produced as identification, and who executed the foregoing instrument, and acknowledged before me that he executed said instrument for the purposes expressed therein.

WITNESS my hand and official seal this 4th day of October, 2001.

My Commission Expires: April 30, 2002

Ivana Money  
Signature of Notary Public

My Commission No.: None

Ivana Money  
Printed name of Notary Public

### ACKNOWLEDGEMENT

State of Conn.  
County of Fairfield

BEFORE me personally appeared Richard Berkowitz, trustee of the FRANK P. DOYLE AMENDED AND RESTATED REVOCABLE TRUST U/D/T 8/13/93, who is personally known to me or has produced as identification, and who executed the foregoing instrument, and acknowledged before me that he executed said instrument for the purposes expressed therein.

WITNESS my hand and official seal this 4th day of October, 2001.

My Commission Expires: April 30, 2002

Ivana Money  
Signature of Notary Public

My Commission No.: None

Ivana Money  
Printed name of Notary Public

### TITLE CERTIFICATION

I, Wilton L. White, Esquire, a duly licensed attorney in the State of Florida, do hereby certify that I have examined the title to the hereon described property; that I find the title to the property is vested to FRANK P. DOYLE & RICHARD BERKOWITZ, OR THEIR SUCCESSORS, TRUSTEES OF THE FRANK P. DOYLE AMENDED AND RESTATED REVOCABLE TRUST U/D/T 8/13/93, that the current taxes have been paid; that there are no mortgages of record, and that there are encumbrances of record but those encumbrances do not prohibit the creation of the subdivision depicted by this plat.

Date: Oct 18, 2001

By: Wilton L. White  
Wilton L. White, Esquire  
Attorney-at-law licensed in Florida  
Florida Bar No. 0722531

### COUNTY APPROVAL

### COUNTY ENGINEER:

This plat is hereby approved for record pursuant to Palm Beach County Ordinance 95-33, and in accordance with Sec. 177.071(2), F.S., this 28 day of Nov, 2001, and has been reviewed by a Professional Surveyor & Mapper employed by Palm Beach County in accordance with Sec. 177.081 (1), F.S.

George T. Webb  
George T. Webb, P.E.  
County Engineer

### SURVEYOR'S CERTIFICATE

This is to certify that the plat shown hereon is a true and correct representation of a survey made under my responsible direction and supervision, that said survey is accurate to the best of my knowledge and belief; that Permanent Reference Monuments (P.R.M.'s) have been placed as required by law and, further that the survey data complies with all the requirements of Chapter 117, Florida Statutes, as amended, and ordinances of Palm Beach County, Florida.

Craig L. Wallace  
Craig L. Wallace  
Professional Surveyor and Mapper  
Florida Certificate No. 3357  
901 Northpoint Parkway, Suite 117  
West Palm Beach, Florida 33407

### NORTHERN PALM BEACH COUNTY IMPROVEMENT DISTRICT ACKNOWLEDGEMENT

The Northern Palm Beach County Improvement District hereby acknowledges that there are no dedications to nor maintenance responsibilities being incurred by said district on this plat and that the Northern Palm Beach County Improvement District Water Management Maintenance Easement (Wetland Preservation Area - 5) recorded in Plat Book 58, Page 62, is shown hereon.

Northern Palm Beach County Improvement District

Date: SEPT. 26, 2001

By: Sally Hamadeh  
A. Sally Hamadeh, President  
Board of Supervisors

Attest: Peter L. Pimentel  
Peter L. Pimentel, Secretary  
Board of Supervisors

### NOTES

- Coordinates shown are grid.
- Datum = NAD 83, 1980 adjustment.
- Zone = Florida East
- Linear unit = US foot
- Coordinate system 1983 State Plane Transverse Mercator Projection
- All distances are ground.
- Scale factor = 1.000026987
- Ground distance x scale factor = grid distance
- Bearings shown hereon are based on the West line of the Southwest Quarter of Section 28, Township 41 South, Range 42 East, as shown on the Plat of OLD MARSH GOLF CLUB (Plat Book 58, Page 62) which bears North 01° 44' 05" East and all other bearings are relative thereto.
- No building or any kind of construction, trees or shrubs shall be placed on any easement without prior written consent of all easement beneficiaries and all applicable county approvals or permits as required for such encroachments.
- This plat, as recorded in its graphic form, is the official depiction of the subdivided lands described herein and will in no circumstances be supplanted in authority by any other graphic or digital form of the plat, whether graphic or digital. There may be additional restrictions that are not recorded on this plat that may be found in the public records of this county.
- This instrument prepared by: Craig L. Wallace  
Wallace Surveying Corporation  
901 Northpoint Parkway, Suite 117  
West Palm Beach, Florida 33407  
561/640-4551

SUBDIVISION OLD MARSH GOLF CLUB REPL-7  
BOOK 92  
PAGE 124  
FLOOD ZONE B  
FLOOD HAZ # 115B  
ZONING RE  
QUAD # 42  
ZIP CODE 33412  
SHEET 1 OF 2  
TAX 797  
PLAT NAME OLD MARSH GOLF CLUB

NOTARY STAMP/SEAL:	NOTARY STAMP/SEAL:	NPBCID:	SURVEYOR SEAL:	ENGINEER SEAL:
<b>OLD MARSH GOLF CLUB REPLAT No. 7 (a P.U.D.)</b>				
<b>WALLACE SURVEYING</b> CORP. LICENSED BUSINESS # 4561 901 NORTHPOINT PARKWAY, SUITE 117 WEST PALM BEACH, FLORIDA 33407 1-561-640-4551				
FIELD:	JOB No.: 99-1201	F.B.:	PG.:	
OFFICE: R.C.	DATE: APRIL, 2000	DWG No.:	99-1201	
CK'D:	REF:	SHEET 1 OF 2		