

TOWNE PARK TRACT "C" REPLAT

A PLANNED UNIT DEVELOPMENT BEING A PART OF TOWNE PARK PUD
 BEING A REPLAT OF TRACT C, "TOWNE PARK PLAT THREE",
 AS RECORDED IN PLAT BOOK 91, PAGES 144 THROUGH 149 OF THE PUBLIC RECORDS OF PALM BEACH
 COUNTY, FLORIDA, LYING IN SECTION 6, TOWNSHIP 45 SOUTH, RANGE 42 EAST, PALM BEACH COUNTY, FLORIDA

THIS INSTRUMENT PREPARED BY
 DAVID P. LINDLEY
 OF
CAULFIELD and WHEELER, INC.
 SURVEYORS - ENGINEERS - PLANNERS
 7301-A WEST PALMETTO PARK ROAD, SUITE 100A
 BOCA RATON, FLORIDA 33433 - (561)392-1991
 SEPTEMBER - 2000

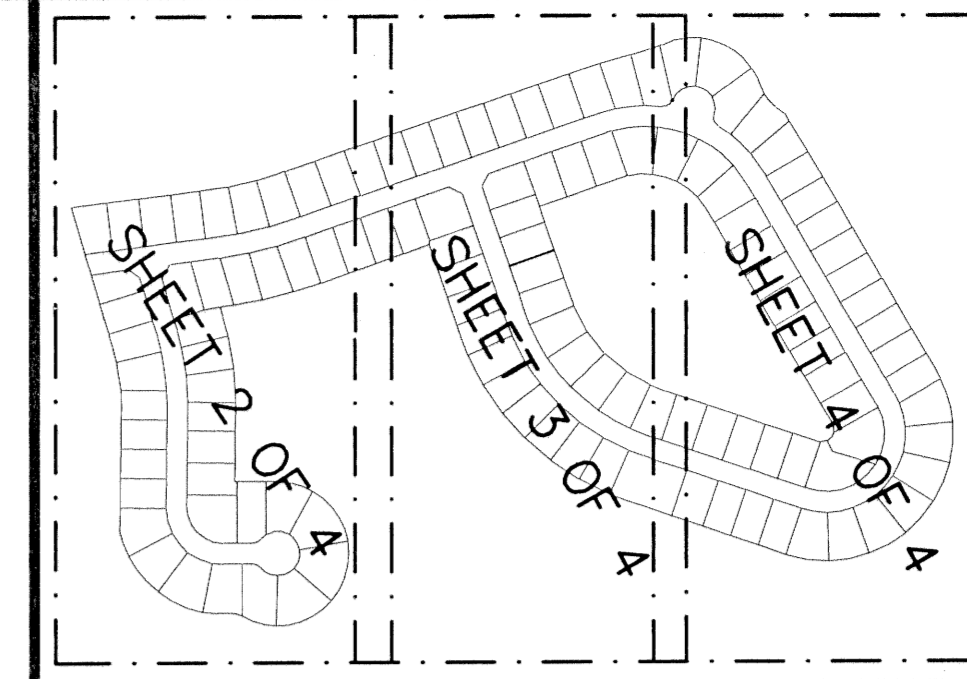

173

STATE OF FLORIDA
 COUNTY OF PALM BEACH
 THIS PLAT WAS FILED FOR
 RECORD AT _____ M.
 THIS _____ DAY OF _____
 A.D. 2001 AND DULY RECORDED
 IN PLAT BOOK _____ ON
 PAGES _____ AND _____

DOROTHY H. WILKEN
 CLERK CIRCUIT COURT

BY: _____
 DEPUTY CLERK

SHEET 4 OF 4

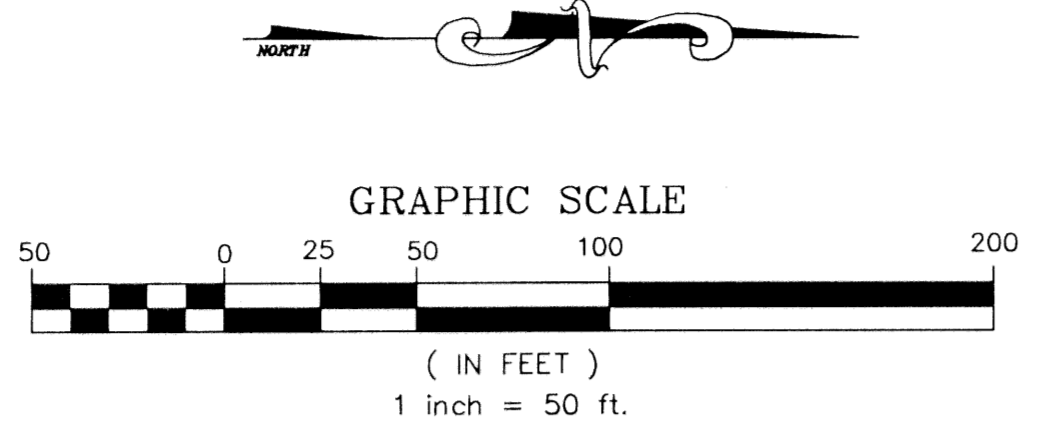

MATCH LINE
 SHEET 3 OF 4

MATCH LINE
 SHEET 3 OF 4

MATCH LINE
 SHEET 3 OF 4



TRACT W
 WATER MANAGEMENT/ DRAINAGE TRACT
 TO BE OWNED AND MAINTAINED BY
 THE BELLAGGIO RESIDENTS
 ASSOCIATION, INC., ITS SUCCESSORS
 AND OR ASSIGNS, WITHOUT RECOURSE
 TO PALM BEACH COUNTY SUBJECT TO
 EXISTING LITTORAL ZONE RESTRICTIVE
 COVENANT AGREEMENT, AS RECORDED
 IN ORB 12434, PAGE 1645
 PUBLIC RECORDS OF PALM BEACH
 COUNTY, FLORIDA

COORDINATE TABLE

PRM	NORTHING	EASTING
1	818523.60	917190.28
2	818566.45	917519.57
3	818608.02	917694.05
4	818664.17	918421.99
5	818916.18	918592.93
6	818922.38	918608.48
7	818922.69	918847.33
8	818773.08	918883.41
9	818756.29	918906.42
10	818145.10	919271.48
11	817698.98	918914.28
12	817824.29	918533.48
13	818219.79	918129.82
14	818437.56	918053.19
15	818343.89	917786.99
16	818288.05	917549.86
17	818265.48	917556.76
18	818044.39	917589.07
19	817866.23	917587.93
20	817866.96	917691.58
21	817546.66	917609.41
22	817552.85	917581.03
23	817746.12	917312.15
24	818046.15	917314.07
25	818185.08	917293.77

CURVE NO.	CHORD BEARING	CHORD DISTANCE
C1	N44°36'50"W	160.88'
C2	N07°54'40"W	181.16'
C3	N77°00'15"E	208.56'
C4	S69°42'47"E	392.43'
C5	S39°05'16"W	309.17'
C6	N45°10'51"W	441.49'

NOTES COORDINATES, BEARINGS AND DISTANCES

COORDINATES SHOWN ARE GRID
 DATUM = NAD 83 1990 ADJUSTMENT
 ZONE = FLORIDA EAST
 LINEAR UNIT = US SURVEY FEET
 COORDINATE SYSTEM 1983 STATE PLANE
 TRANSVERSE MERCATOR PROJECTION
 ALL DISTANCES ARE GROUND
 SCALE FACTOR = 1.0000195
 GROUND DISTANCE X SCALE FACTOR = GRID DISTANCE
 BEARINGS AS SHOWN HEREON ARE GRID DATUM, NAD 83 1990
 ADJUSTMENT, FLORIDA EAST ZONE.

N71°01'07"E (PLAT BEARING) 00°24'17" = BEARING ROTATION
 N70°36'50"E (GRID BEARING) (PLAT TO GRID)
 NORTH LINE THIS PLAT COUNTERCLOCKWISE

Towne Park Replat
 PAGE 173
 RECORD NUMBER 170A
 TOWNSHIP 45 S
 RANGE 42 E
 SECTION 6
 PLAT BOOK 91, PAGES 144-149