

(A PART OF A RESIDENTIAL PLANNED DEVELOPMENT)
 BEING A RE-PLAT OF PARCEL "D-1", ANDROS ISLE, RECORDED IN PLAT BOOK 61, PAGE 87-93, AND LYING IN SECTION 20, TOWNSHIP 43 SOUTH, RANGE 42 EAST, CITY OF WEST PALM BEACH, PALM BEACH COUNTY, FLORIDA

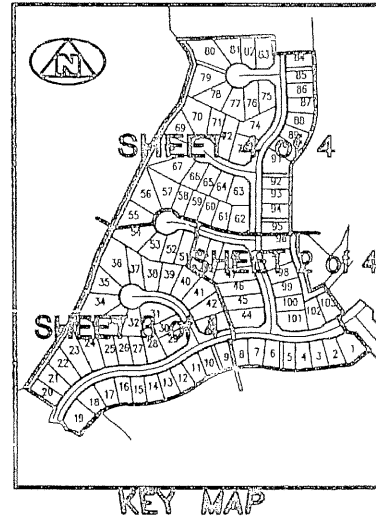
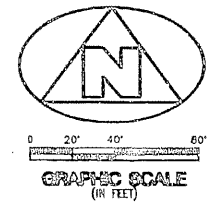

- SURVEYING NOTES AND LEGEND:**
1. THE BASE BEARING (BB) FOR THIS PLAT IS THE ASSUMED BEARING OF S33°27'44" W AS SHOWN HEREON.
 2. IN THOSE INSTANCES WHERE UTILITY/DRAINAGE STRUCTURES ARE CONSTRUCTED IN CONFLICT WITH THE PLATTED PERMANENT CONTROL POINTS (P.C.P.), STRADDLERS MONUMENTED AS PERMANENT CONTROL POINTS SHALL BE SET TO REFERENCE THE PLATTED P.C.P. POSITION.
 3. LINES WHICH INTERSECT CURVES ARE NOT RADIAL, UNLESS OTHERWISE NOTED.
 4. (R) DENOTES RADIAL.
 5. C/L DENOTES A CENTERLINE.
 6. (P.M.) DENOTES A SET #2424 PERMANENT REFERENCE MONUMENT (P.R.M.).
 7. (P.C.P.) DENOTES A SET #2424 PERMANENT CONTROL POINT (P.C.P.).
 8. (F.M.) DENOTES A FOUND #2424 PERMANENT REFERENCE MONUMENT (P.R.M.).
 9. (F.C.P.) DENOTES A FOUND #2424 PERMANENT CONTROL POINT (P.C.P.).

THIS INSTRUMENT WAS PREPARED BY WM. R. VAN CAMPEN, R.L.S., IN AND FOR THE OFFICES OF BENCH MARK LAND SURVEYING & MAPPING, INC., 4152 WEST BLUE HERON BOULEVARD, SUITE 121, RIVIERA BEACH, FLORIDA.

BENCH MARK
 Land Surveying and Mapping, Inc.
 4152 West Blue Heron Blvd., Suite 121, Riviera Beach, FL 33404
 Fax (407) 844-2959 Phone (407) 844-2102

RECORD PLAT
ANDROS ISLE PARCEL "D-1"

DWN	AW	FB	DATE 12-01-98	WO.#	AK001
CKD	FILE P30201-4.dwg	SCALE 1" = 40'	SHEET 3 OF 4		