

Clerk's Memo: Aerial Map: Poor Quality

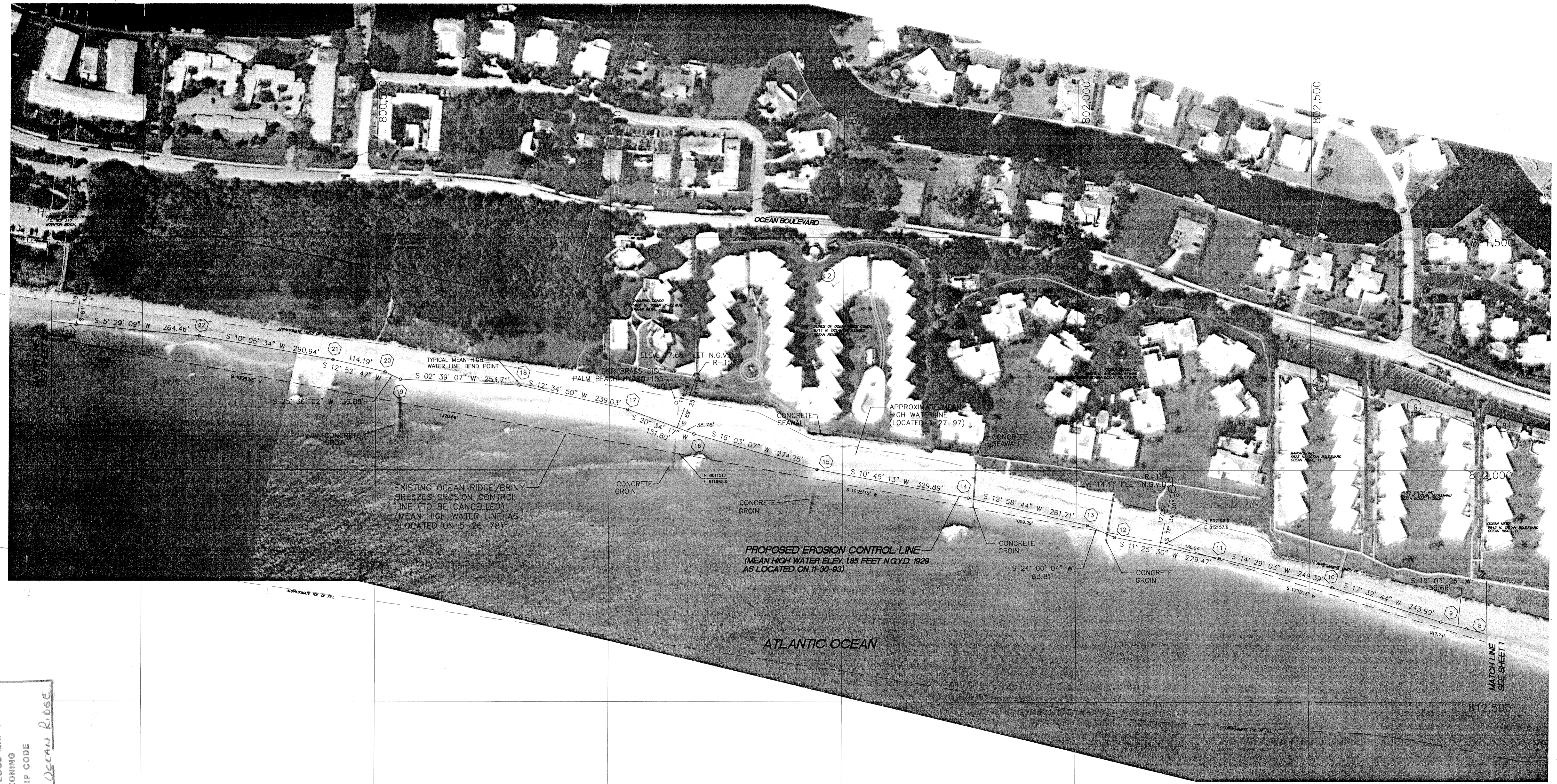

SCALE: 1" = 100'

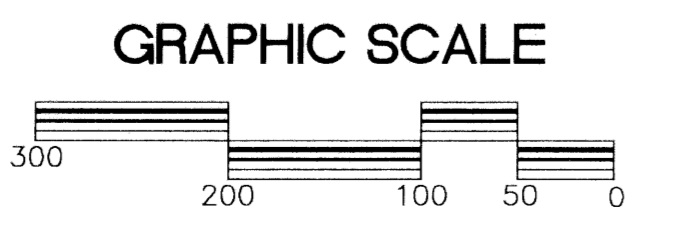

NOTE: ALL R-MONUMENTS ARE STANDARD 4" x 4" CONCRETE MARKERS UNLESS OTHERWISE NOTED.

REVISED ADDED ANNOTATIONS PER FDP
 REVISED ADDED PROP. LIMITS OF FILL PER PLANS
 BY OLSEN ASSOC.
 REVISED ADDED EROSION CONTROL LINE FOR MAY '78
 REVISED NEW OWNER NAMES AND PARCEL 23A
 REVISED LENGTH OF EROSION CONTROL LINE AND P.O.B.
 REVISED TITLE PER D.N.R. REQUIREMENTS
 REVISED TO CORRESPOND WITH DESCRIPTION
 REVISED TO REFLECT EROSION CONTROL LINE
 REVISED TITLE TO SHOW EROSION CONTROL LINE

6-23-97
 6-9-97
 1-28-97
 1-19-96
 2-6-95
 5-6-94
 4-11-94
 2-17-94
 2-4-94

SUBDIVISION * HIGH WATER SURVEY
 BOOK 80 PAGE 182
 FLOOD MAP *
 ZONING
 QUAD *
 SE
 PUD NAME * TOWN OF OCEAN RIDGE

MORGAN & EKLUND, INC.
 PROFESSIONAL SURVEY CONSULTANTS

1850 43RD AVENUE, SUITE C-8
 VERO BEACH, FL 32960
 PHONE: (407) 569-2218
 FAX: (407) 569-2480

1500 S.E. 3RD COURT
 SUITE 203
 DEERFIELD BEACH, FL 33441
 PHONE: (305) 421-6882
 FAX: (305) 421-0451

CERTIFICATE OF SURVEYOR - I HEREBY CERTIFY THAT THE INFORMATION SHOWN HEREON IS IN ACCORDANCE WITH A RECENT FIELD SURVEY MADE UNDER MY DIRECTION, AND THAT IT IS TRUE AND CORRECT TO THE BEST OF MY KNOWLEDGE AND BELIEF, AND MEETS THE MINIMUM TECHNICAL STANDARDS AS SET FORTH BY THE FLORIDA BOARD OF PROFESSIONAL LAND SURVEYORS IN CHAPTER 61G, F.S.

[Signature]
 JOHN R. MORGAN, II, P.S.M.
 REGISTERED SURVEYOR AND MAPPER 3520
 STATE OF FLORIDA

UPDATED MEAN HIGH WATERLINE SURVEY				COMMISSION NO.
FOR THE TOWN OF OCEAN RIDGE				3533.00
PALM BEACH COUNTY, FLORIDA				SCALE
DRAWN BY	CHECKED BY	FIELD BOOK	DATE OF SURVEY	1" = 100'
P.A.R.	J.R.M.	PB 33 PAGE NO. 56-65	11-30-93	DATE
				12-20-93
				SHEET 3 OF 4