

PIPERS GLEN A-2A

0298007

39

A PART OF PIPERS GLEN, A P. U. D.
 LYING IN SECTION 2, TOWNSHIP 46 SOUTH, RANGE 42 EAST, PALM BEACH COUNTY, FLORIDA. BEING A REPLAT OF
 A PORTION OF THE PLAT OF SOUTHPOINTE PLAT 2 (P.B. 51, PGS. 56-59) TOGETHER WITH A PORTION
 OF THE PLAT OF PIPERS GLEN A-3 (PB. 61 PGS. 171-174); PUBLIC RECORDS OF PALM BEACH COUNTY, FLORIDA

JANUARY 1994

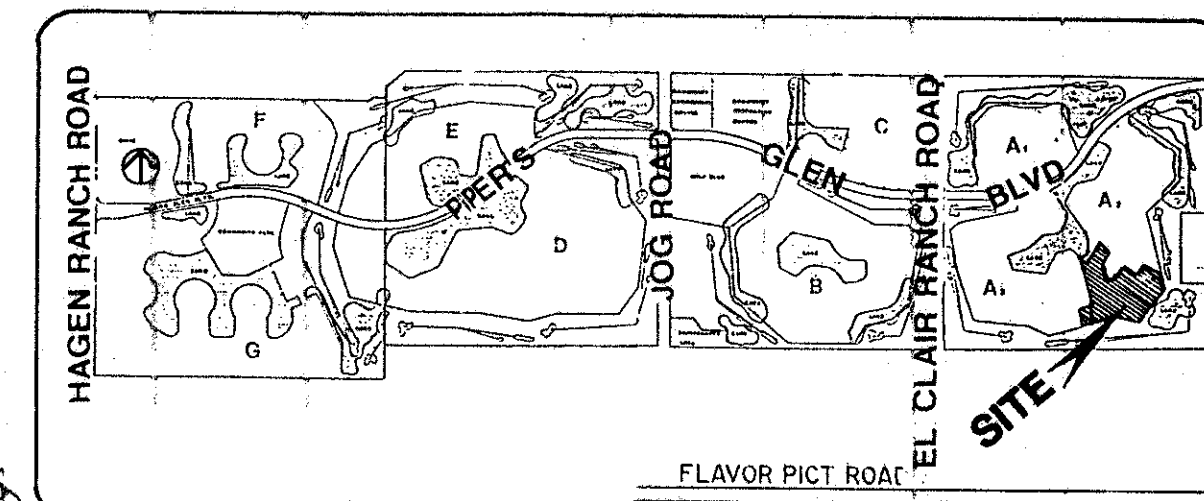
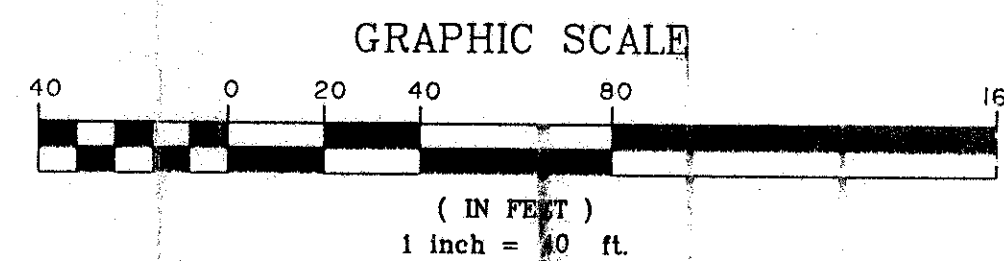

LOCATION MAP
N.T.S.

PET. 80-212D
 ALWC. #0001
 5/9/3/K

LEGEND

- - PERMANENT REFERENCE MONUMENT (SET) #2633
- S.F. - SQUARE FEET
- - PERMANENT REFERENCE MONUMENT (FOUND) (NO NUMBER)
- P.U.D. - PLANNED UNIT DEVELOPMENT
- - PERMANENT CONTROL POINT
- (N.R.) - NON RADIAL
- U.E. - UTILITY EASEMENT
- P.O.C. - POINT OF COMMENCEMENT
- D.E. - DRAINAGE EASEMENT
- R - RADIUS
- P.O.B. - POINT OF BEGINNING
- L - LENGTH OF LINE
- Δ - CENTRAL ANGLE
- ⊙ - CENTER LINE
- P.B. - PLAT BOOK
- PG. - PAGE

0298-007

THIS INSTRUMENT PREPARED BY C. A. RAYMAN, INC.



Shalloway, Foy,
 Rayman & Newell, Inc.

ENGINEERS - PLANNERS - SURVEYORS
 1201 BELVEDERE ROAD, WEST PALM BEACH, FLORIDA 33405, (407) 655-1151

Date	12/15/93	SHEET	2
Drawn	C. A. R.		2
Checked	G. RAYMAN	JOB NO.	92119

T12-456

SUBDIVISION - Pipers Glen A-2A
 BOOK 74 PAGE 39
 FLOOD ZONE B
 QUAD # 36
 SE 80-212 ZIP CODE 33437
 PUD NAME SAME
 7/1/93

BEARING BASE:
 THE EAST LINE OF THE PLAT OF PIPERS GLEN A-3 AS RECORDED IN PLAT BOOK 61, PAGES 171-174 IS TAKEN AS BEING N15°00'00"W AND ALL OTHER BEARINGS ARE RELATIVE THERETO.

GOLF COURSE
 P.B. 43, PGS. 97-101
 PIPERS GLEN PLAT NO. 1

