

# PLAT OF BENT TREE P.U.D. PHASE 1

IN PART OF SECTION 2, TOWNSHIP 42 SOUTH, RANGE 42 EAST  
CITY OF PALM BEACH GARDENS, PALM BEACH COUNTY, FLORIDA

SHEET NO. 3 OF 5

GEE & JENSON  
ENGINEERS - ARCHITECTS - PLANNERS, INC.  
WEST PALM BEACH, FLORIDA  
MARCH 1994

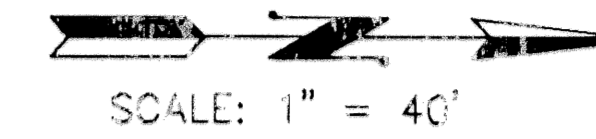
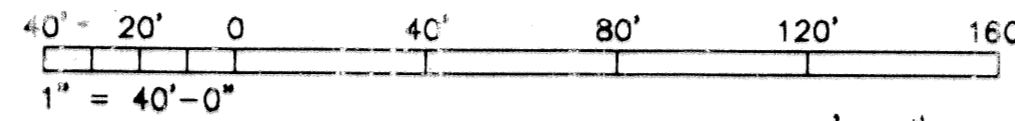

STATE OF FLORIDA  
COUNTY OF PALM BEACH  
This plat was filed for  
record at \_\_\_\_\_ M. this day  
of \_\_\_\_\_ 1994, and duly  
recorded in Plat Book No. \_\_\_\_\_  
on Pages \_\_\_\_\_ thru \_\_\_\_\_  
DOROTHY WILKEN  
Clerk Circuit Court  
By \_\_\_\_\_ D.C.



CURVE	RADIUS	LENGTH	TANGENT	CHORD	BEARING	DELTA
C2	500.00'	128.98'	64.85'	128.62'	S80°58'25"E	14°46'48"
C3	200.00'	312.72'	198.56'	281.82'	N46°50'35"E	89°35'12"
C8	250.00'	260.00'	143.14'	248.44'	N58°09'24"W	59°35'15"

SUBDIVISION \* Bent Tree P.U.D. Ph  
BOOK 73 PAGE 91  
FILED DATE 3/23/94  
CITY OF PALM BEACH  
SE 215172  
PUD NAME C/PB GARDENS

COMPUTED \_\_\_\_\_  
DRAWN \_\_\_\_\_  
CHECKED \_\_\_\_\_  
APPROVED \_\_\_\_\_  
JOB NO. 92-258

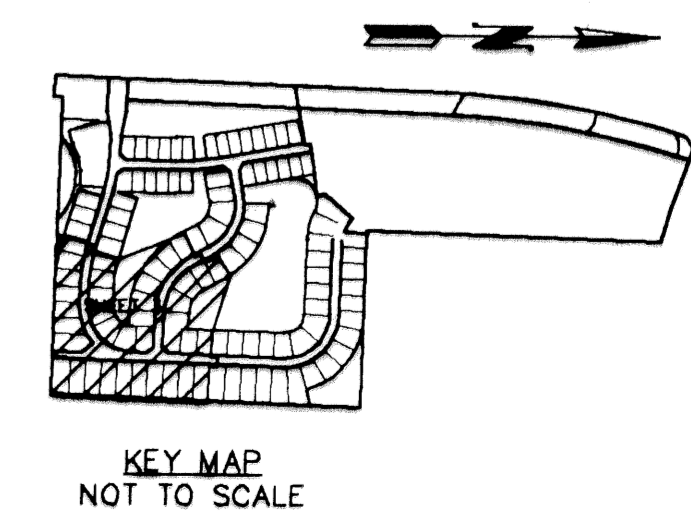

SHADY LAKES  
P.B. 43 PG. 6-8