

# PLAT OF FOXHALL PHASE I P.U.D.

BEING A REPLAT OF THE SOUTH ONE-HALF OF TRACTS 17 AND 18 AND ALL OF TRACTS 31 AND 32, OF THE SUBDIVISION OF SECTION 11, TOWNSHIP 43 SOUTH, RANGE 42 EAST, AS RECORDED IN PLAT BOOK 20, PAGE 53, PUBLIC RECORDS OF PALM BEACH COUNTY, FLORIDA.

JULY 1987

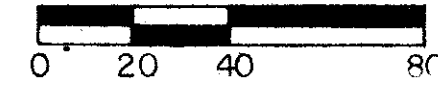

SHEET 2 OF 3

1. DENOTES PERMANENT REFERENCE MONUMENT (P.R.M.) SET/FOUND.
2. BEARINGS BASED ON S01°28'53"W ALONG THE EAST LINE OF SECTION 11, PER PALM BEACH COUNTY SURVEY SECTION MAP 11/43/42.
3. DENOTES PERMANENT CONTROL POINT (P.C.P.) TO BE SET.
4. ACCESS DRIVES ARE IMGRESS-EGRESS EASEMENTS IN FAVOR OF THE NORTHERN PALM BEACH COUNTY WATER CONTROL DISTRICT.
5. PALM BEACH COUNTY SHALL HAVE THE RIGHT, BUT NOT THE OBLIGATION, TO MAINTAIN ANY PORTION OF THE PRIVATELY DEDICATED DRAINAGE SYSTEM THAT SERVES TO DRAIN SURFACE WATERS FROM ANY PUBLIC LANDS.
6. THE NORTHERN PALM BEACH COUNTY WATER CONTROL DISTRICT SHALL HAVE THE RIGHT, BUT NOT THE OBLIGATION, TO MAINTAIN WATER MANAGEMENT FACILITIES IN ANY PORTION OF THE DRAINAGE TRACTS AS SHOWN HEREON.
7. NO BUILDINGS NOR ANY KIND OF CONSTRUCTION SHALL BE PLACED ON UTILITY OR DRAINAGE EASEMENTS.
8. NO STRUCTURES, TREES, OR SHRUBS SHALL BE PLACED ON DRAINAGE EASEMENTS.
9. LANDSCAPING ON UTILITY EASEMENTS OTHER THAN FOR SEWER AND WATER SHALL REQUIRE PRIOR APPROVAL OF ALL UTILITIES OCCUPYING SAME.
10. WHERE A DRAINAGE EASEMENT AND ANY OTHER TYPE OF EASEMENT CROSS, ANY AND ALL USES FOR DRAINAGE PURPOSES SHALL TAKE PRECEDENCE.
11. BUILDING SETBACKS AND SEPARATION SHALL CONFORM TO APPLICABLE REQUIREMENTS OF THE PALM BEACH COUNTY ZONING CODE.
12. WATER MANAGEMENT TRACTS "A" AND "B" SHALL BE THE MAINTENANCE RESPONSIBILITY OF THE FOXHALL HOMEOWNERS ASSOCIATION, INC. ITS SUCCESSORS AND/OR ASSIGNS.
13. NO PERMANENT STRUCTURES SHALL BE LOCATED WITHIN THE 25' BUFFER.

13. WEST HAVENHILL ASSOCIATES (DECLARANT) IN RECORDING THIS PLAT OF FOXHALL PHASE I P.U.D. HAS DESIGNATED CERTAIN AREAS OF INTENDED FOR USE BY THE HOMEOWNERS IN FOXHALL PHASE I AREAS ARE NOT DESIGNATED HEREBY FOR USE BY THE GENERAL PUBLIC HOMEOWNERS IN FOXHALL PHASE I AS MORE FULLY PROVIDED IN THE DECLARATION OF COVENANTS, AND RESTRICTIONS APPLICABLE TO THE COVENANTS, AND RESTRICTIONS IS HEREBY INCORPORATED AND MADE A PART OF THIS PLAT.
14. THERE SHALL BE NO BUILDINGS, STRUCTURES, CONSTRUCTION OF ANY TYPE, TREES OR SHRUBS PLACED ON ANY PORTION OF THE WATER PERMIT FORD, BY THE NORTHERN PALM BEACH COUNTY WATER CONTROL DISTRICT.
15. THERE MAY BE ADDITIONAL RESTRICTIONS THAT ARE NOT RECORDED ON THIS PLAT THAT MAY BE FOUND IN THE PUBLIC RECORDS OF THIS COUNTY.

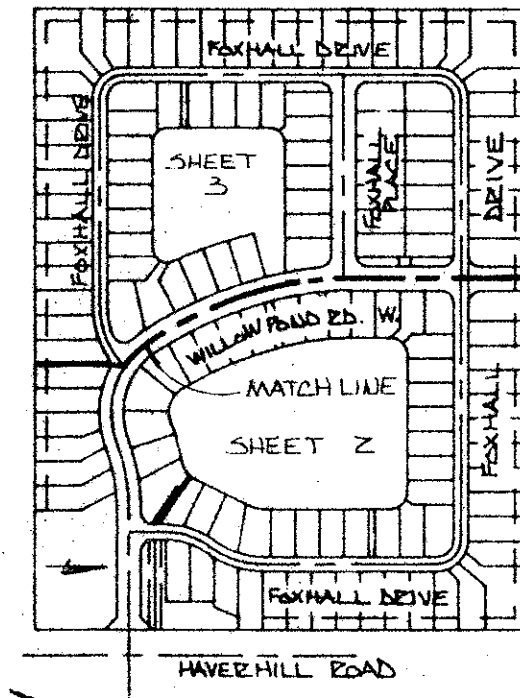

PLAT OF THE SUBDIVISION OF SECTION 11  
PLAT BOOK 20, PAGE 53

*Handwritten notes:*  
SUBDIVISION - Foxhall I  
PAGE 13  
FLOOD MAP # 195B  
ZONING RS  
ZIP CODE 33477  
33444  
General 10/27/07  
CE PUD  
PUD NAME  
TAZ 174

