

49/146

A PLANNED UNIT DEVELOPMENT Fountains South

146

TRACT B-5

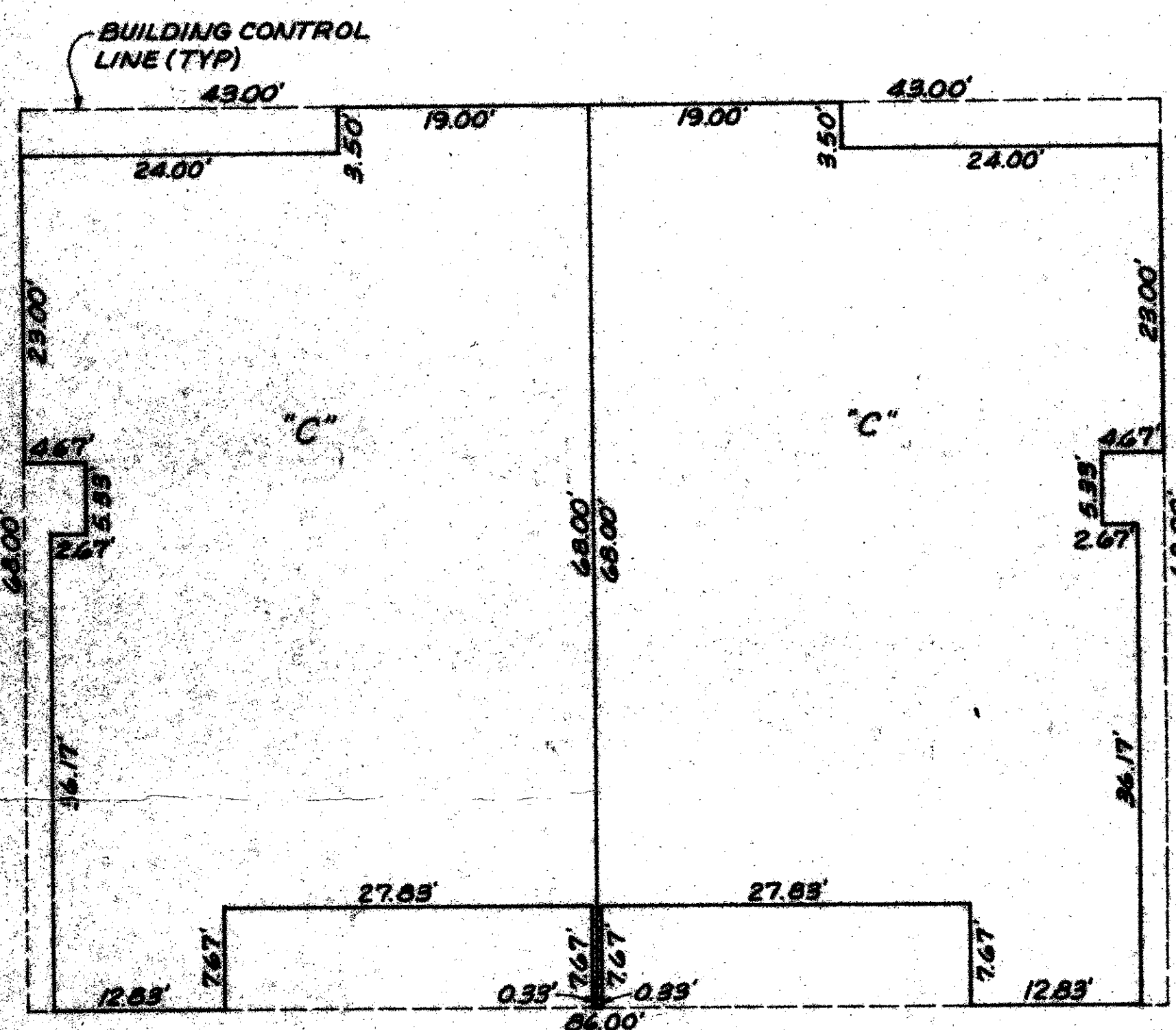

TYPE ①

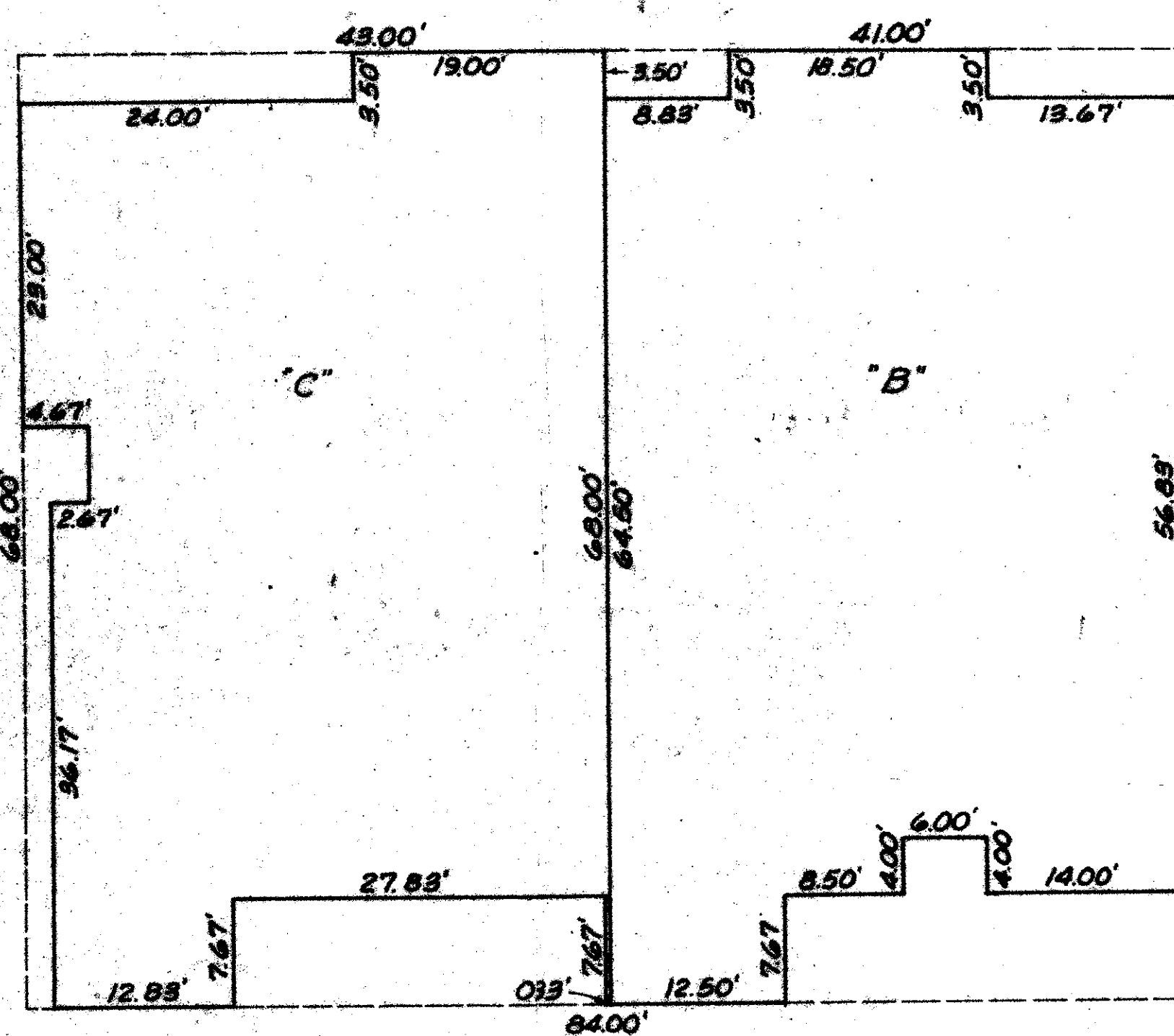

TYPE ②

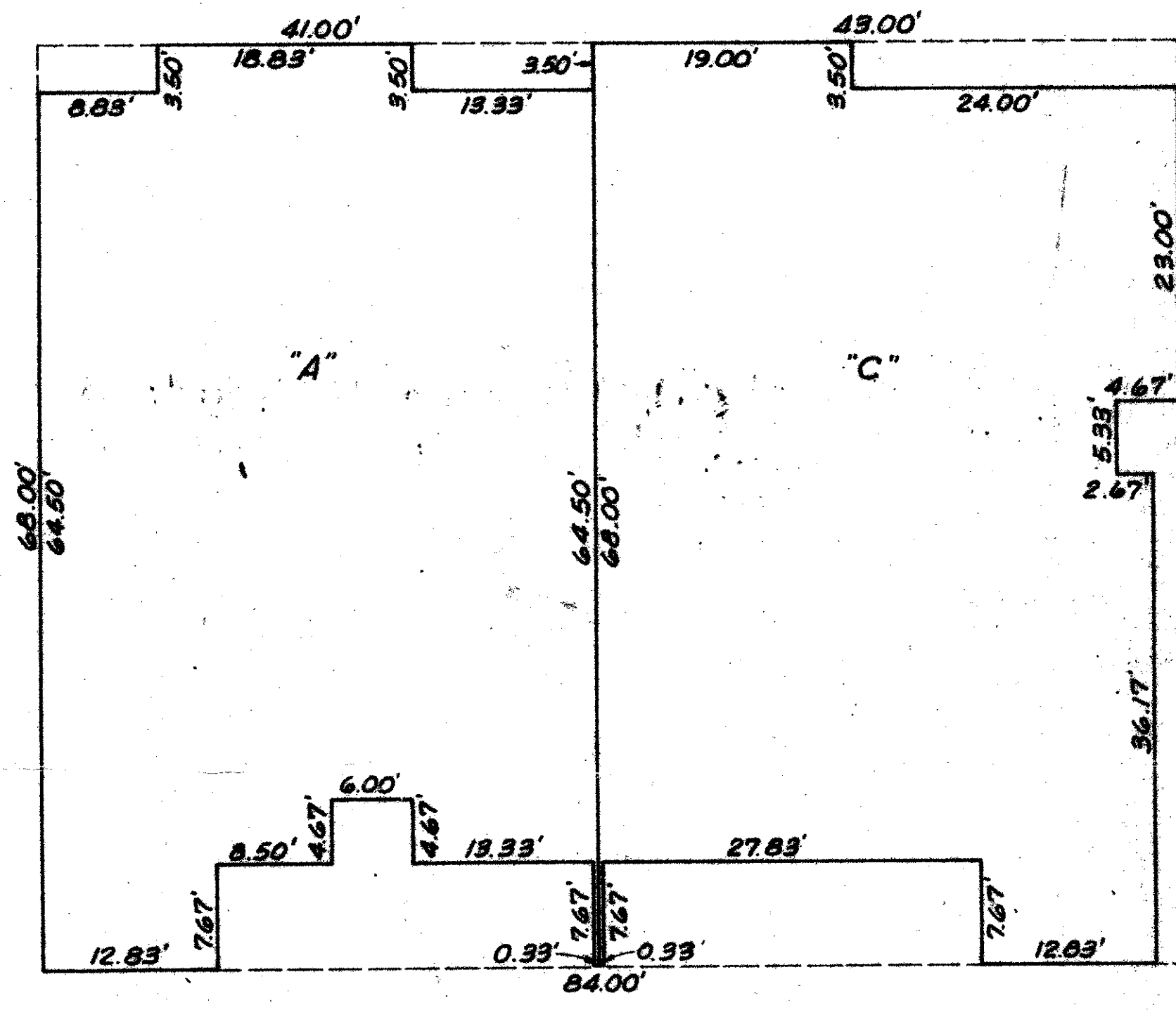

TYPE ③

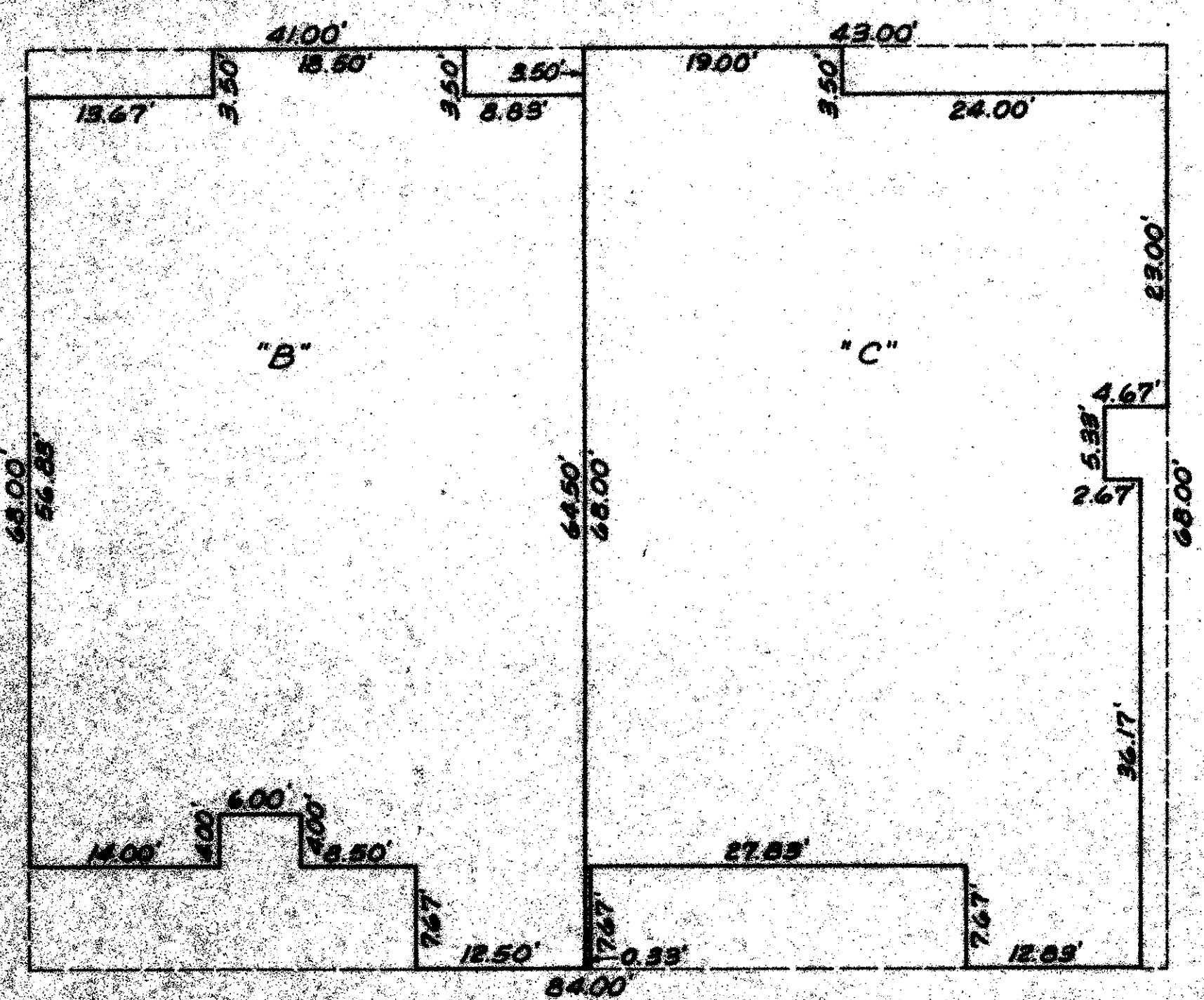

TYPE ④

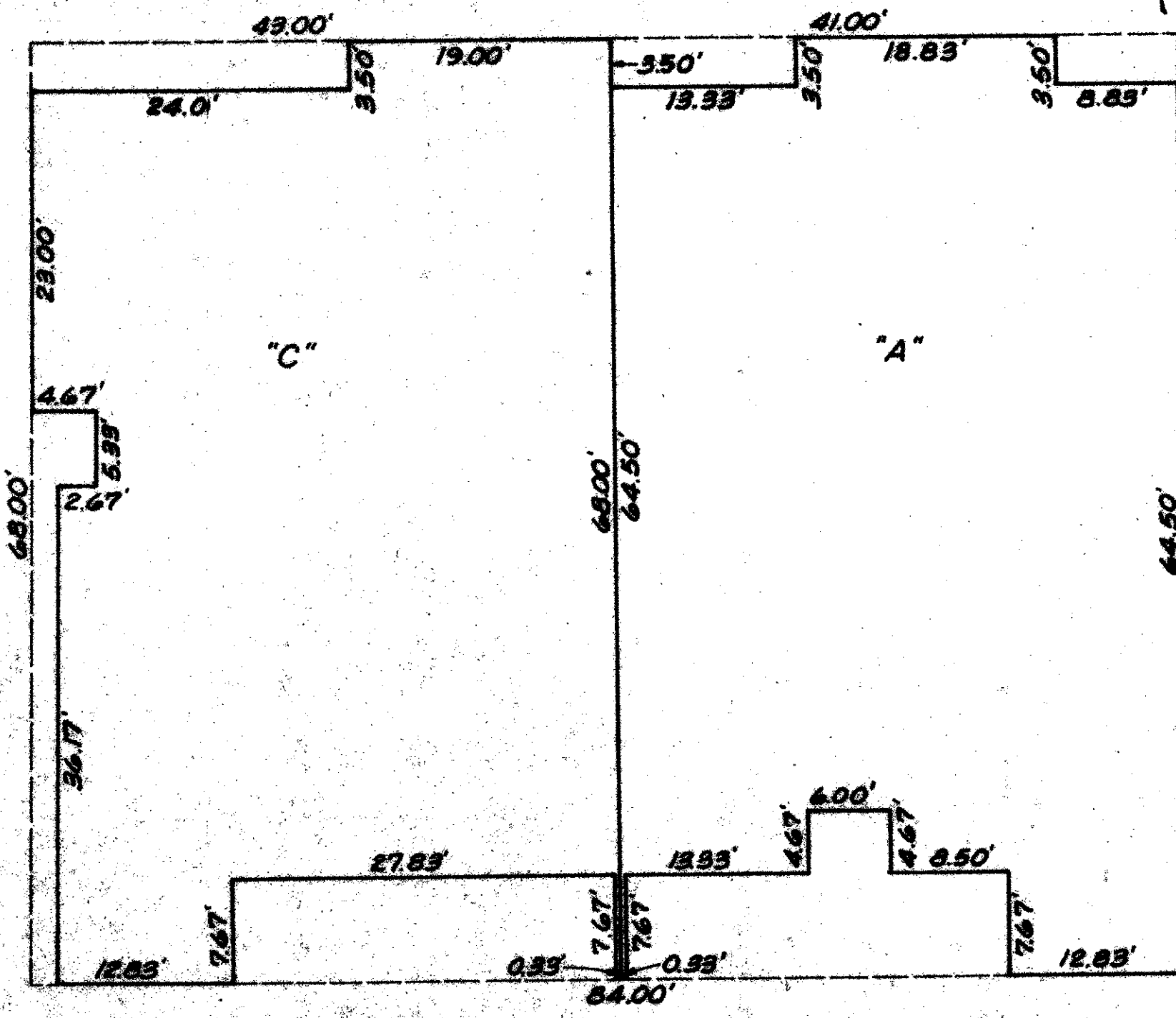

TYPE ⑤

34/44/42
 SUBDIVISION: Fountains South
 BOOK: 49 PAGE: 145
 FLOOD ZONE: B FLOOD MAP: 170A
 QUAD: 33 ZONING: RS
 PU: PUD ZIP CODE: 92463
 PUD NAME: FOUNTAINS SOUTH

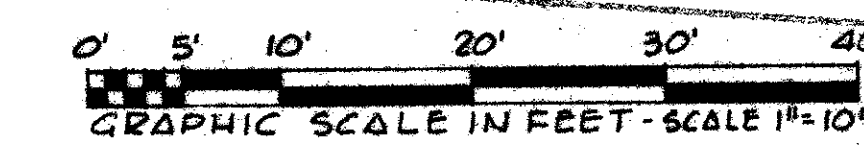

BUILDING UNIT NOTES

- indicates BUILDING CONTROL LINE.
- indicates building line (Lot Line).
- "C" indicates building unit type obtained from plans provided by Cinochlio and Spina, architects.
- All units are one (1) story, C.B.S. Villas.
- All building lines as shown hereon are at right angles (90°).
- The lot line separating the two units in each building represents the center line of an eight inch (8") party wall as constructed.
- The actual location of the building line (lot line) as shown hereon shall be the physical location of the extreme outside building wall line as constructed.

49/146 0244-302

ADAIR & BRADY, INC. CONSULTING ENGINEERS & LAND SURVEYORS		FOUNTAINS SOUTH TRACT B-5 RECORD PLAT	
Dr. MBL	Scale 1"=10'	FP 823	3 of 3
Ch. dp	Date SEPT. 1984		
As. JA	Lot No. 0562W		

DRAWING NUMBER

DRAWING NUMBER

DRAWING NUMBER