

SADDLE TRAIL PARK OF WELLINGTON

P.U.D.
IN PART OF SECTION 17, TWP. 44 S., RGE. 41 E.
PALM BEACH COUNTY, FLORIDA
IN 3 SHEETS SHEET NO. 1
GEE & JENSON
ENGINEERS-ARCHITECTS-PLANNERS, INC.
WEST PALM BEACH, FLORIDA
APRIL 1979

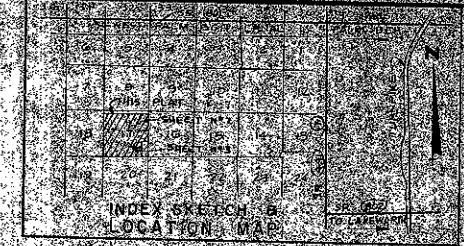

DESCRIPTION

A Parcel of land lying and being in Section 17, Township 44 South Range 41 East, Palm Beach County, Florida, and more particularly described as follows:
Commencing at the Northwest Corner of Section 17, Township 44 South Range 41 East, Palm Beach County, Florida, thence S. 00° 50' 00" W. along the West line of said Section 17, a distance of 5000 feet to the POINT OF BEGINNING, said point being the westerly extension of the South Right of Way Line of Acme Improvement District C-15 as described in Deed Book 1037, Page 689, Public Records of Palm Beach County, Florida, thence S. 88° 26' 11" E., a distance of 5359.50 feet to a point on the East line of said Section 17, thence S. 00° 51' 23" W. along the said East line of Section 17 being the West Line of Greenview Shores No. 2 as recorded in Plat Book 31, Pages 120 to 136, incl., shown on Sheet No. 5, Public Records of Palm Beach County, Florida, a distance of 4000.68 feet to the Northeast corner of a Parcel of land as described in Official Record Book 1826, pages 233 and 234 of said Public Records, thence N. 89° 39' 54" W. a distance of 354.86 feet, thence S. 00° 51' 18" W. a distance of 1350.02 feet to the Southwest corner of the above parcel of land and a point on the South line of said Section 17, thence N. 89° 37' 45" W. along said South line of Section 17, a distance of 5022.40 feet to the Southwest Corner of said Section 17, thence N. 00° 50' 00" E. along the West line of said Section 17, a distance of 5437.83 feet to the POINT OF BEGINNING.

Containing 647.0 Acres, more or less.

MORTGAGE CONSENT

STATE OF NEW YORK - COUNTY OF NEW YORK
The undersigned hereby certifies that it is a Co-holder of a Mortgage upon the herein described property and does hereby join in and consents to the dedication of the lands described in the dedication hereto, by the owner thereof and agrees that its mortgage which is recorded in Official Record Book 1826, Page 233 of the Public Records of Palm Beach County, Florida, shall be subordinated to the dedication shown hereon.

IN WITNESS WHEREOF, the said corporation has caused these presents to be signed by its duly authorized officers and attested to by its Secretary and its Corporate Seal to be affixed hereto by and with the authority of its Board of Directors, this 23rd day of January, 1979.

BANKERS TRUST COMPANY, a corporation of the State of New York as a Co-Trustee of the Testamentary Trusts of C.O. Wellington, deceased.

Attest: *[Signature]* By: *[Signature]*

ACKNOWLEDGMENT

STATE OF NEW YORK - COUNTY OF NEW YORK
BEFORE ME personally appeared *[Signatures]* and *[Signatures]* to me well known, and known to me to be the individuals described in and who executed the foregoing instrument as *[Signatures]* and *[Signatures]* of the BANKERS TRUST COMPANY, a corporation, and severally acknowledge to and before me that they executed such instrument as such officers of said corporation, and that the seal affixed to the foregoing instrument is the corporate seal of said corporation and that it was affixed to said instrument by due and regular corporate authority, and that said instrument is the free act and deed of said corporation.

WITNESS my hand and official seal this 23rd day of January, 1979.

[Signature]
Notary Public

My commission expires: _____

NOTES

- denotes Permanent Reference Monument.
- denotes Permanent Control Point which are to be buried 6"± below Crown of Shell Road, Standard for Paved Road.
- There shall be no buildings or other structures placed on Utility Easements.
- There shall be no buildings or any kind of construction or the planting of trees or shrubs on Drainage Easements, or Maintenance Easements.
- Building Setback Lines shall be as required by Palm Beach County Zoning Regulations.
- A.E. denotes Anchor Easement.
- All bearings shown herein are relative to an assumed meridian used throughout Wellington.
- All block corners are rounded with a 25 foot radius curve unless otherwise shown.
- Easements are for Public Utilities unless otherwise noted.

TITLE CERTIFICATION

STATE OF FLORIDA
COUNTY OF PALM BEACH
I, LARRY ALEXANDER, a duly licensed Attorney in the State of Florida, do hereby certify that I have examined the title in the hereon described property, that I find the title to the property is vested in GOULD FLORIDA, INC., a Delaware Corporation and ACME IMPROVEMENT DISTRICT, that the current taxes have been paid, that the property described in the dedication is not encumbered by any mortgage except as shown hereon, and that the property is found to contain deed reservations which are not applicable and do not affect the subdivision of the property.

[Signature]
Larry Alexander - Attorney at Law
Licensed in Florida
Date: 1/24/1980

MORTGAGE CONSENT

STATE OF NEW YORK - COUNTY OF NEW YORK
The undersigned hereby certifies that he is a Co-Holder of a Mortgage upon the herein described property and does hereby join in and consents to the dedication of the lands described in the dedication hereto, by the owner thereof and agrees that his mortgage which is recorded in Official Record Book 1826, Page 233 of the Public Records of Palm Beach County, Florida, shall be subordinated to the dedication shown hereon.

In Witness Whereof, I Roger Wellington do hereunto set my hand this 23rd day of January, 1979.

Witness: *[Signature]* By: *[Signature]*
Roger Wellington as Co-Trustee of the Testamentary Trusts of C.O. Wellington, deceased.

ACKNOWLEDGMENT

STATE OF FLORIDA
COUNTY OF PALM BEACH
Before me personally appeared Roger Wellington as Co-Trustee of the Testamentary Trusts of C.O. Wellington, deceased, to me well known and known to me to be the person described in and who executed the foregoing instrument, and acknowledged to and before me that he executed said instrument for the purposes therein expressed.

WITNESS my hand and official seal this 23rd day of January, 1979.

[Signature]
Notary Public

My Commission expires: _____

APPROVAL

PALM BEACH COUNTY
BOARD OF COUNTY COMMISSIONERS
This plot is hereby approved for record this 30th day of December, 1980.

[Signature]
Dennis P. Kehler - Chairman

Attest: JOHN B. DUNKLE - Clerk
By: Kathryn S. Miller
Deputy Clerk

COUNTY ENGINEER

This plot is hereby approved for record this 30th day of December, 1980.
By: *[Signature]*
H.F. Kohler, County Engineer

DEDICATION

STATE OF FLORIDA
COUNTY OF PALM BEACH
KNOW ALL MEN BY THESE PRESENTS, that GOULD FLORIDA, INC., a Delaware Corporation organized to do business in Florida, joined by ACME IMPROVEMENT DISTRICT, its sole member, the land shown hereon as SADDLE TRAIL PARK OF WELLINGTON P.U.D. lying in part in Section 17, Township 44 South Range 41 East, Palm Beach County, Florida, and being more particularly described by the plat and description have caused the same to be surveyed and plotted as shown hereon and do hereby dedicate to the Mayor, Streets, Greenview Boulevard and Wellington Tract, and hereby dedicate to the Board of Commissioners of Palm Beach County, Florida, for the use of the public, the portion of said land shown on the plat and called the Bridge Path and Acme Improvement District Right of Way, as shown on a plat dedicated to ACME IMPROVEMENT DISTRICT, in fee simple, provided however, that in the event ACME IMPROVEMENT DISTRICT ceases to exist or to have the authority to maintain the same, then in that event the aforementioned shall revert to FIRST WELLINGTON, INC. and shall be owned by First WELLINGTON, INC. as provided in the Restated Articles of Incorporation of First Wellington, Book 211, Pages 154.5, to 155.4, inclusive, and Amended in Official Record Book 2280, Pages 228.1 to 228.2, inclusive, Public Records of Palm Beach County, Florida, 1973. The Easements, Easements as shown on the plat and hereby dedicated to the BOARD OF COUNTY COMMISSIONERS of Palm Beach County, Florida for the purpose of control and jurisdiction over access rights, utility easements and Maintenance Easements as shown are hereby dedicated in perpetuity for the construction, use and maintenance of utilities and drainage.

IN WITNESS WHEREOF, the said Corporation and District have caused these presents to be signed by their respective officers and duly authorized agents in and to the said County, Florida, in the authority of their Boards of Directors, this 23rd day of January, 1979.

GOULD FLORIDA, INC., a Corporation of the State of Delaware
Attest: *[Signature]* By: *[Signature]*
Diana L. Curran, Assistant Secretary
ACME IMPROVEMENT DISTRICT

Attest: *[Signature]* By: *[Signature]*
A.W. Glisson, General Manager
Madison F. Packer, Secretary

ACKNOWLEDGMENT

STATE OF FLORIDA
COUNTY OF PALM BEACH
BEFORE ME personally appeared GUERRY STUBBING and DIANA L. CURRAN, President and Assistant Secretary, respectively, of GOULD FLORIDA, INC., a Delaware Corporation, and MADISON F. PACKER and A.W. GLISSON, Secretary and General Manager, respectively, of ACME IMPROVEMENT DISTRICT, to me well known and known to me to be the individuals described in and who executed the foregoing instrument as such officers of said Corporation and District, and that the same affixed to the foregoing instrument are the corporate seal of said Corporation and District of both that they were affixed to said instrument by due and regular corporate authority and that said instrument is the free act and deed of said Corporation and District.

WITNESS my hand and official seal this 23rd day of January, 1979.

[Signature]
Notary Public

My Commission expires: JAN. 29, 1980

SURVEYOR'S CERTIFICATION

STATE OF FLORIDA
COUNTY OF PALM BEACH
KNOW ALL MEN BY THESE PRESENTS, that the undersigned, Joseph H. Packer, Jr., on the 12th day of December, 1979, completed the survey of lands as shown on the foregoing plat, and said survey was a true and correct representation of the lands therein described and plotted, that the same were surveyed and plotted in accordance with the laws and regulations of the State of Florida, and that the survey data complies with all requirements of Chapter 177, Florida Statutes, and all Amendments, and Ordinances of Palm Beach County, Florida.

[Signature]
Paul J. Farber, Surveyor and Land Surveyor
Florida Registration No. 1257, Date 14 DEC 1979

SURVEYOR'S CERTIFICATION

STATE OF FLORIDA
COUNTY OF PALM BEACH
KNOW ALL MEN BY THESE PRESENTS, that the undersigned, William S. Miller, on the 12th day of December, 1979, completed the survey of lands as shown on the foregoing plat, and said survey was a true and correct representation of the lands therein described and plotted, that the same were surveyed and plotted in accordance with the laws and regulations of the State of Florida, and that the survey data complies with all requirements of Chapter 177, Florida Statutes, and all Amendments, and Ordinances of Palm Beach County, Florida.

[Signature]
William S. Miller, Surveyor and Land Surveyor
Florida Registration No. 1257, Date 14 DEC 1979

THIS INSTRUMENT PREPARED BY WILLIAM S. MILLER IN HIS OFFICE AS SURVEYOR AND LAND SURVEYOR, WEST PALM BEACH, FLORIDA.

0332-057