

A PLANNED UNIT DEVELOPMENT
PLAT 25 VILLADELRAY
 A PARCEL OF LAND IN SECTION 11, TOWNSHIP 46 SOUTH, RANGE 42 EAST
 PALM BEACH COUNTY, FLORIDA
 IN TWO SHEETS - SHEET NO. ONE

R.U.D. DATA

Total Area 1.6749 Acres
 Total Dwelling Units 14
 Density 8.35 Dwelling Units/Acre
 Water Bodies 0
 Recreation Areas 0

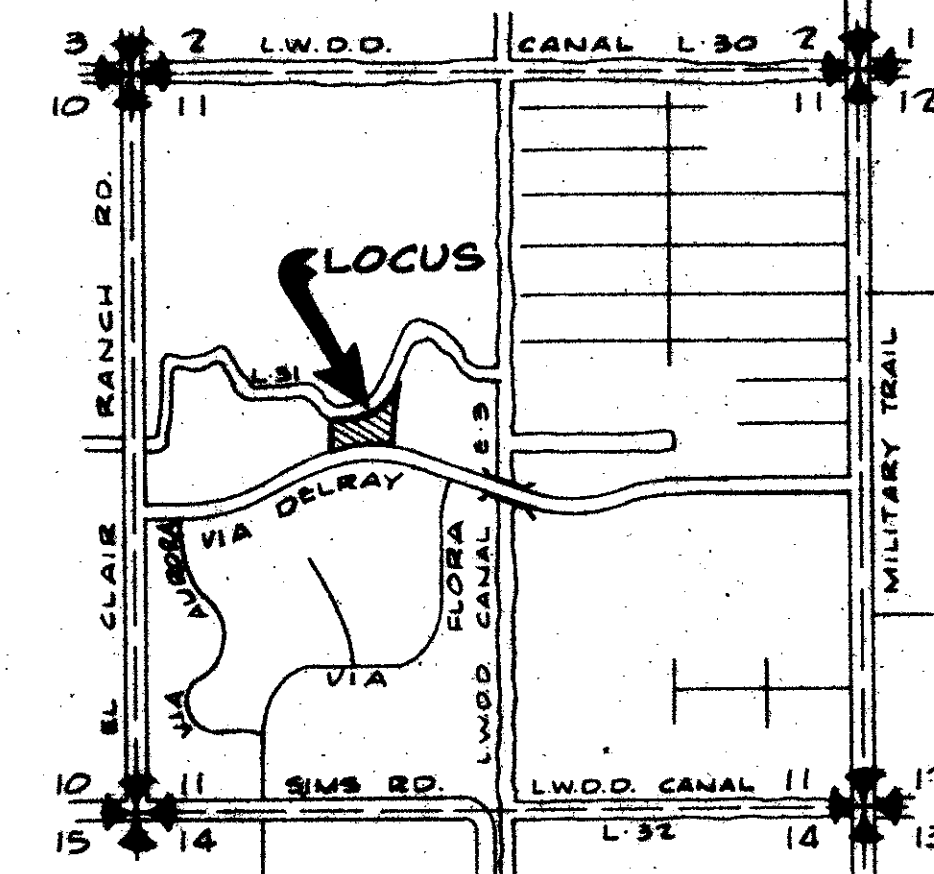

LOCATION MAP
NOT TO SCALE

COUNTY OF PALM BEACH
 STATE OF FLORIDA
 This Plat was filed for record at 9:39
 on the 26 day of July
 1979 and duly recorded in Plat Book
 37 on page 188 & 189
 JOHN B. DUNKLE, Clerk Circuit Court
 By: *[Signature]*

DESCRIPTION / DEDICATION

KNOW ALL MEN BY THESE PRESENTS that YUSEM PROPERTIES OF DELRAY LIMITED, a Florida limited partnership, owners of the land shown hereon, being in Section 11, Township 46 South, Range 42 East, Palm Beach County, Florida, shown hereon as PLAT 25 VILLADELRAY and more particularly described as follows:

Commencing at the Southeast Corner of Tract "F" as shown on Plat 12, VILLADELRAY, a Planned Unit Development as Recorded in Plat Book 30, Pages 77, 78, and 79, Public Records of Palm Beach County, Florida, said corner being the POINT OF BEGINNING (P.O.B.); thence run Easterly along the North Right-of-Way line of VIA DELRAY as shown on said PLAT 12, VIA DELRAY, along the arc of a curve concave to the South, having a radius of 2008.17 feet, and a central angle of 7°11'30", a distance of 252.06 feet; thence run South 79°50'40" East, a distance of 192.08 feet; thence run North 55°09'20" East, a distance of 35.38 feet; thence run North 10°09'20" East, a distance of 52.06 feet; thence run Northerly along the arc of a curve concave to the East, having a radius of 1035.00 feet, and a central angle of 22°30'00", a distance of 406.44 feet to a point on the Easterly Right-of-Way of Lake Worth Drainage District Canal L-31 as recorded in Official Record Book 2218, Page 1150, Public Records of Palm Beach County, Florida; thence run South 32°39'20" West along the Easterly Right-of-Way Line of said Canal L-31, a distance of 267.75 feet; thence run Southwesterly along the arc of a curve concave to the North, having a radius of 154.00 feet, and a central angle of 68°00'00", a distance of 185.15 feet; thence run North 79°20'40" West, a distance of 319.00 feet, to the Northeast corner of aforesaid Tract "P"; thence run South 2°57'50" West, a distance of 149.16 feet to the POINT OF BEGINNING.

CONTAINING 1.6749 acres more or less.

IN WITNESS WHEREOF, Lawrence Sodick as a general partner does hereunto set his hand and seal this 22nd day of June 1979.

By: *[Signature: Lawrence Sodick]*
 Witness: *[Signature: Sandra S. ...]*

Witness: *[Signature: R.M. Dixon]*

ACKNOWLEDGEMENT

STATE OF FLORIDA
 COUNTY OF PALM BEACH

BEFORE ME personally appeared Lawrence Sodick, to me well known and known to me to be the person described in and who executed the foregoing instrument, and acknowledged before me that he executed the foregoing instrument, and acknowledged before me that he executed said instrument for the purposes expressed therein.

IN WITNESS my hand and official seal this 22nd day of June 1979.

[Signature: Sandra S. ...]
 Notary Public

My commission expires:

TITLE CERTIFICATION

STATE OF FLORIDA
 COUNTY OF PALM BEACH

We, COUNTY TITLE AND ABSTRACT COMPANY, a title insurance company, duly licensed in the State of Florida, do hereby certify that we have examined the title to the hereon described property; that we find the title to the property is vested to YUSEM PROPERTIES OF DELRAY LIMITED; that the current taxes have been paid; and that we find that the property is encumbered by the mortgages shown hereon; and that we find that all mortgages are shown and are true and correct.

[Signature: Phillip L. Spalding]
 Phillip L. Spalding, President

COUNTY APPROVALS

BOARD OF COUNTY COMMISSIONERS
 PALM BEACH COUNTY, FLORIDA.

This plat is hereby approved for record this 24 day of July, 1979.

By: *[Signature: Bill Bailey]*
 Bill Bailey Chairman

COUNTY ENGINEER

This plat is hereby approved for record this 24 day of July, 1979.

By: *[Signature: Herbert F. Kahlert]*
 Herbert F. Kahlert
 County Engineer

ATTEST: JOHN B. DUNKLE, Clerk
 Board of County Commissioners

By: *[Signature: Maxine B. Jennings]*
 Maxine B. Jennings
 Deputy Clerk

SURVEYOR'S CERTIFICATE

This is to certify that the plat shown hereon is a true and correct representation of a survey made under my responsible direction and supervision and that said survey is accurate to the best of my knowledge and belief and that (P.R.M.'s) Permanent Reference Monuments have been placed as required by law, that (P.C.P.'s) Permanent Control Points will be set under the guarantees posted with Palm Beach County for the Required Improvements and further that the survey data complies with all the requirements of Chapter 177 Florida Statutes, as amended, and ordinances of Palm Beach County, Florida.

[Signature: Ward L. Mitzelfeld]
 Ward L. Mitzelfeld
 Registered Surveyor No. 1632
 State of Florida

0324-302

36

11/46/42

37/1988

This instrument was prepared by WARD L. MITZELFELD in the offices of Robert E. Owen & Associates, Engineers, Planners and Surveyors, 1675 Palm Beach Lakes Boulevard, West Palm Beach, Florida.

Field Book No. Pg.	ROBERT E. OWEN & ASSOCIATES, INC. ENGINEERS · PLANNERS · SURVEYORS WEST PALM BEACH FLORIDA	Job No. 77-1126
Design W. MITZELFELD		Scale
Drawn M. SIKORA		Date AUGUST, 1978
Checked W. MITZELFELD		Sheet of 2 1
File No.		File No. BF-2266

PLAT 25 Villadelray