

MONARCA

BEING A REPLAT OF TRACT 19, SUBDIVISION OF SECTIONS 20 AND 29, TOWNSHIP 45 SOUTH RANGE 43 EAST, ACCORDING TO THE PLAT THEREOF AS RECORDED IN PLAT BOOK 7, PAGE 20 (P.R.P.B.CO.), BEING IN SECTION 20, TOWNSHIP 45 SOUTH, RANGE 43 EAST, CITY OF BOYNTON BEACH, PALM BEACH COUNTY, FLORIDA

JANUARY 2018

THIS INSTRUMENT WAS PREPARED BY PAUL D. ENGLE, IN THE OFFICE OF O'BRIEN, SUTER & O'BRIEN, INC., 955 N.W. 17TH AVENUE, SUITE K-1, DELRAY BEACH, FLORIDA 33445 (561) 276-4501

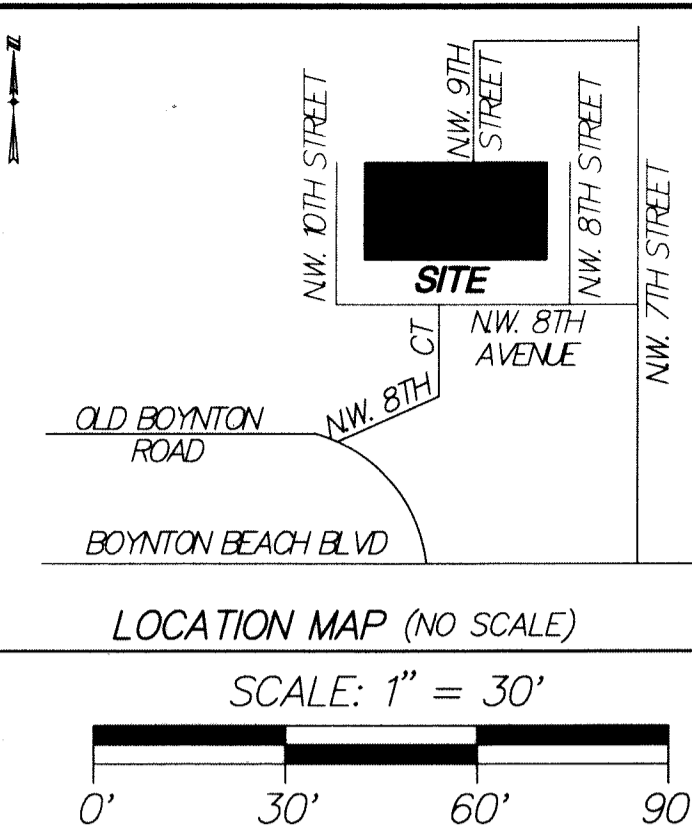

- LEGEND:
 - CL = CENTERLINE
 - P.R.M. = PERMANENT REFERENCE MONUMENT (4"X4"X24" CONCRETE MONUMENT STAMPED "PRM LB353") UNLESS STATED OTHERWISE
 - P.R.P.B.CO. = PUBLIC RECORDS OF PALM BEACH COUNTY
 - SECTION 20/45/43 = SECTION 20, TOWNSHIP 45 SOUTH, RANGE 43 EAST
 - C.A. = CENTRAL ANGLE
 - C.B. = CHORD BEARING
 - L.B. = LICENSE BUSINESS

COUNTY OF PALM BEACH
STATE OF FLORIDA
THIS PLAT WAS FILED FOR RECORD AT _____
THIS _____ DAY OF _____
2018 AND DULY RECORDED IN PLAT BOOK NO. _____
ON PAGE _____
SHARON R. BOCK, CLERK AND COMPTROLLER
BY _____ DC

SHEET 2 OF 2

