

THIS INSTRUMENT PREPARED BY
 DAVID P. LINDLEY
 OF
CAULFIELD and WHEELER, INC.
 SURVEYORS — ENGINEERS — PLANNERS
 7900 GLADES ROAD, SUITE 100
 BOCA RATON, FLORIDA 33434 — (561)392-1991
 CERTIFICATE OF AUTHORIZATION NO. LB3591

WAWA HO 1193

A PORTION OF THE NORTHWEST ONE-QUARTER OF SECTION 25
 TOWNSHIP 43 NORTH, RANGE 42 EAST
 PALM BEACH COUNTY, FLORIDA

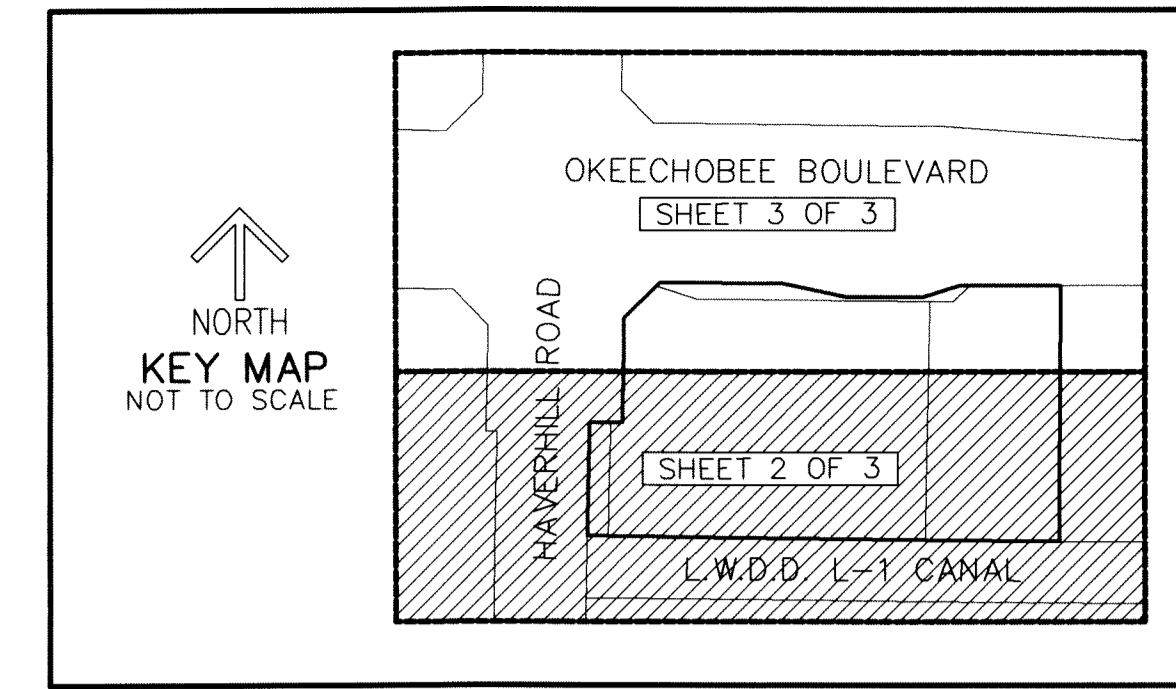

167

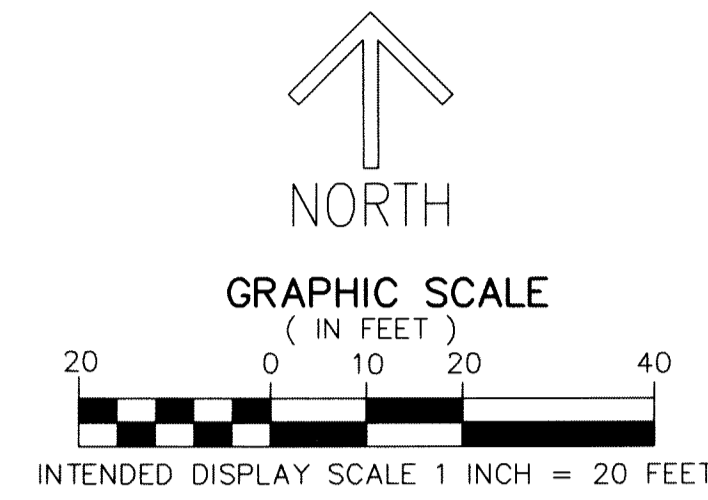

- LEGEND/ABBREVIATIONS**
- ⊙ - CENTERLINE
 - Δ - DELTA (CENTRAL ANGLE)
 - E - EASTING WHEN USED WITH COORDINATES
 - FPL - FLORIDA POWER AND LIGHT COMPANY
 - LB - LICENSED BUSINESS
 - L.W.D.D. - LAKE WORTH DRAINAGE DISTRICT
 - MTE - MASS TRANSIT EASEMENT
 - N - NORTHING WHEN USED WITH COORDINATES
 - O.R.B. - OFFICIAL RECORD BOOK
 - PBCUE - PALM BEACH COUNTY UTILITY EASEMENT
 - UE - UTILITY EASEMENT
 - PRM - DENOTES PERMANENT REFERENCE MONUMENT 4" x 4" x 24" CONCRETE MONUMENT WITH ALUMINUM DISK STAMPED "C&W PRM LB3591"
 - PRM - DENOTES PERMANENT REFERENCE MONUMENT NAIL AND DISK
 - △ - PALM BEACH COUNTY CONTROL POINT
 - SIRC - DENOTES SET 5/8" IRON ROD WITH CAP STAMPED "C&W LB3591"

- NOTES**
COORDINATES, BEARINGS AND DISTANCES
- COORDINATES SHOWN ARE GRID
 - DATUM = NAD 83 1990 ADJUSTMENT
 - ZONE = FLORIDA EAST
 - LINEAR UNIT = US SURVEY FEET
 - COORDINATE SYSTEM 1983 STATE PLANE
 - TRANSVERSE MERCATOR PROJECTION
 - ALL DISTANCES ARE GROUND UNLESS OTHERWISE NOTED
 - SCALE FACTOR = 1.0000360
 - GROUND DISTANCE X SCALE FACTOR = GRID DISTANCE
 - BEARINGS AS SHOWN HEREON ARE GRID DATUM, NAD 83 1990 ADJUSTMENT, FLORIDA EAST ZONE.

SHEET 2 OF 3

MATCH LINE SHEET 3 OF 3

