

THIS INSTRUMENT PREPARED BY
DAVID P. LINDLEY
 OF
CAULFIELD and WHEELER, INC.
 SURVEYORS - ENGINEERS - PLANNERS
 7900 GLADES ROAD, SUITE 100
 BOCA RATON, FLORIDA 33434 - (561)392-1991
 CERTIFICATE OF AUTHORIZATION NO. LB3591

COBBLESTONE PLAZA

BEING A REPLAT OF TRACT B, WEST BOYNTON FARMS,
 AS RECORDED IN PLAT BOOK 104, PAGES 9 THROUGH 11
 OF THE PUBLIC RECORDS OF PALM BEACH COUNTY, FLORIDA,
 LYING IN SECTION 20, TOWNSHIP 45 SOUTH, RANGE 42 EAST,
 PALM BEACH COUNTY, FLORIDA

NORTH
 KEY MAP
 NOT TO SCALE

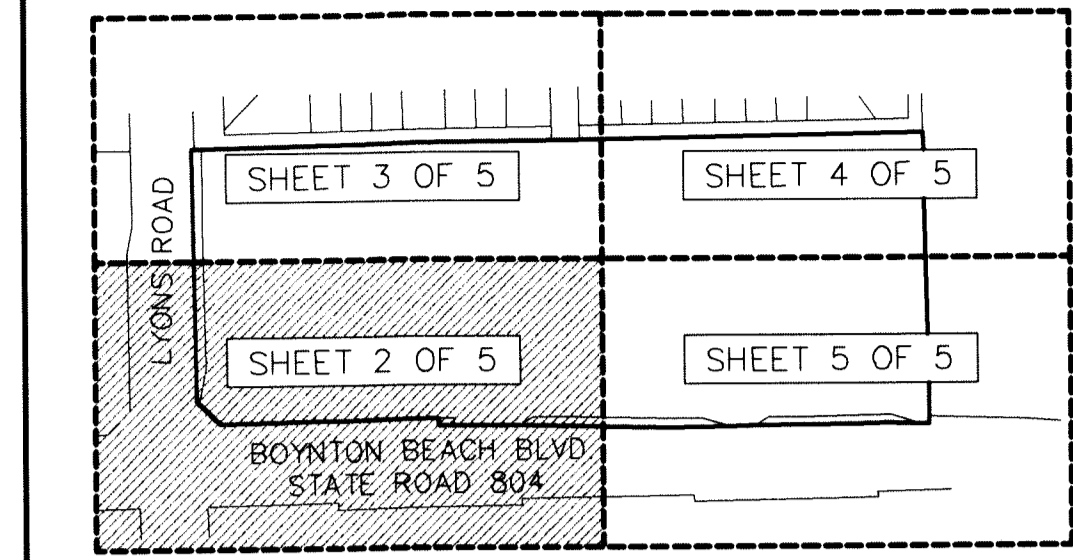

45

NOTES COORDINATES, BEARINGS AND DISTANCES

COORDINATES SHOWN ARE GRID
 DATUM = NAD 83 (90 ADJUSTMENT)
 ZONE = FLORIDA EAST
 LINEAR UNIT = US SURVEY FEET
 COORDINATE SYSTEM 1983 STATE PLANE
 TRANSVERSE MERCATOR PROJECTION
 ALL DISTANCES ARE GROUND
 SCALE FACTOR = 1.00002236
 GROUND DISTANCE X SCALE FACTOR = GRID DISTANCE
 BEARINGS AS SHOWN HEREON ARE GRID DATUM,
 NAD 83 (90 ADJUSTMENT), FLORIDA EAST ZONE.

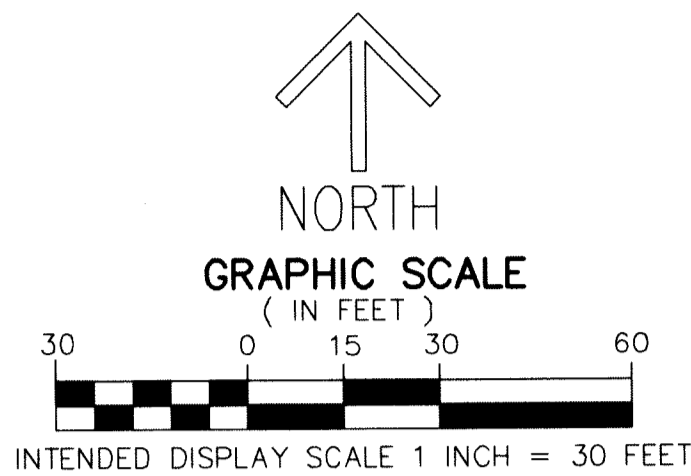

LEGEND/ABBREVIATIONS

- Δ - DELTA (CENTRAL ANGLE)
- E - EASTING
- FPL - FLORIDA POWER AND LIGHT
- FDOT - FLORIDA DEPARTMENT OF TRANSPORTATION
- L - ARC LENGTH
- LB - LICENSED BUSINESS
- LAE - LIMITED ACCESS EASEMENT
- L.W.D.D. - LAKE WORTH DRAINAGE DISTRICT
- N - NORTHING
- O.R.B. - OFFICIAL RECORD BOOK
- R - RADIUS
- R/W - RIGHT-OF-WAY
- UE - UTILITY EASEMENT
- PRM - DENOTES PERMANENT REFERENCE MONUMENT
 4" x 4" x 24" CONCRETE MONUMENT WITH
 ALUMINUM DISK STAMPED "C&W PRM LB3591"
- △ - PALM BEACH COUNTY CONTROL POINT

MATCH LINE SHEET 3 OF 5

SHEET 2 OF 5

