

**PERIMETER**  
SURVEYING & MAPPING  
Certificate of Authorization No. LB7264  
Prepared by: Jeff S. Hodapp, P.S.M.  
947 Clint Moore Road  
Boca Raton, Florida 33487  
Tel: (561) 241-9988  
Fax: (561) 241-5182

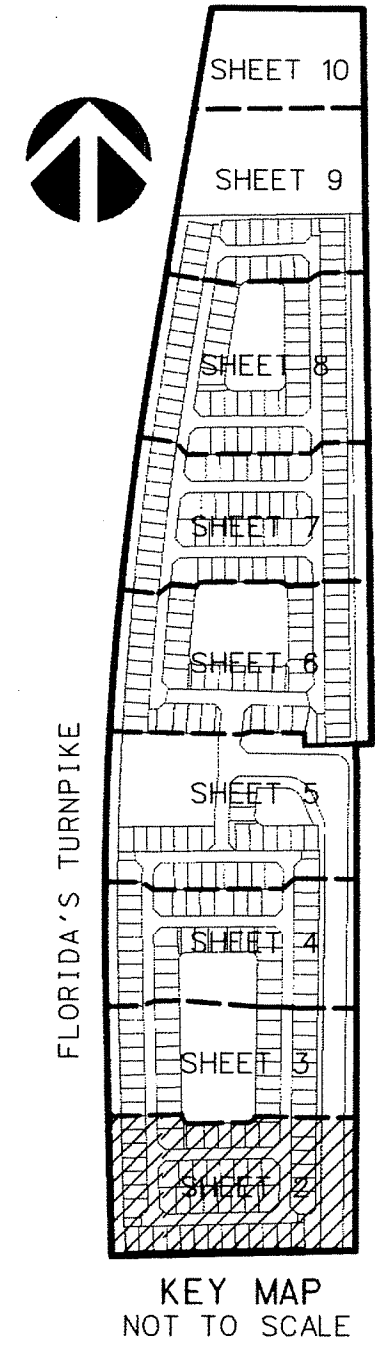

# ATLANTIC COMMONS - PLAT FIVE

A REPLAT OF PORTIONS OF TRACTS 1-3 AND 30-35 IN SECTION 17, TOWNSHIP 46 SOUTH, RANGE 42 EAST,  
AND PORTIONS OF TRACTS 65, 66, 94-99 AND 126-128 IN SECTION 8, TOWNSHIP 46 SOUTH, RANGE 42 EAST,  
OF "PALM BEACH FARMS CO. PLAT NO.1" (P.B. 2, PGS 26-28, P.B.C.R.)  
PALM BEACH COUNTY, FLORIDA.

**LEGEND:**

- SET P.R.M. (UNLESS OTHERWISE NOTED) 3-4" X 4" CONC. MON. WITH ALUMINUM DISK STAMPED P.R.M. #LB7264
- ◊ PERMANENT CONTROL POINT (NAIL 8 DISK #LB7264)
- ⊙ CENTERLINE

**ABBREVIATIONS:**

ALUM	ALUMINUM	MON.	MONUMENT
B.F.E.	BUFFER EASEMENT	O.E.	OFFICIAL RECORDS BOOK
CH	CHORD	O.R.B.	OFFICIAL RECORDS BOOK
CHB	CHORD BEARING	N.R.	NON-RADIAL
CONC.	CONCRETE	P.B.	PLAT BOOK
COR.	CORNER	P.B.C.	PALM BEACH COUNTY
D.	DELTA (CENTRAL ANGLE)	P.B.C.R.	PALM BEACH COUNTY RECORDS
D.E.	DRAINAGE EASEMENT	P.B.C.U.E.	PALM BEACH COUNTY UTILITY EASEMENT
D.T.	DRIVEWAY TRACT	P.C.P.	PERMANENT CONTROL POINT
FD.	FOUND	P.O.B.	POINT OF BEGINNING
L.A.E.	LIMITED ACCESS EASEMENT	P.O.C.	POINT OF COMMENCEMENT
L.B.E.	LANDSCAPE BUFFER EASEMENT	P.R.M.	PERMANENT REFERENCE MONUMENT
L.B.	LICENSED BUSINESS	P.S.M.	PROFESSIONAL SURVEYOR & MAPPER
L.E.	LANDSCAPE EASEMENT	P.U.D.	PLANNED UNIT DEVELOPMENT
L.M.E.	LAKE MAINTENANCE EASEMENT	R.	RADIUS
L.M.A.E.	LAKE MAINTENANCE ACCESS EASEMENT	RAD	RADIAL
L.S.	LICENSED SURVEYOR	R.P.B.	ROAD PLAT BOOK
L.S.E.	LIFT STATION EASEMENT	R/W	RIGHT-OF-WAY
L.W.D.D.	LAKE WORTH DRAINAGE DISTRICT	SEC.	SECTION
		S.F.	SQUARE FEET
		U.E.	UTILITY EASEMENT

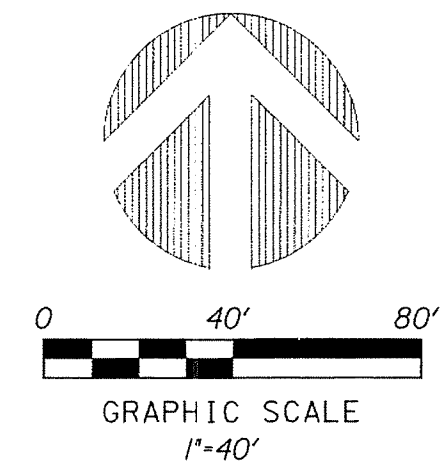

14

SHEET 2 OF 10

