

GARDEN OF ISRAEL

A REPLAT OF A PORTION OF THE GARDEN OF RUEBEN, FIRST ADDITION, PLAT BOOK 31, PAGES 247-249, LYING IN SECTION 14, TOWNSHIP 42 SO., RANGE 41 E., PALM BEACH COUNTY, FLORIDA

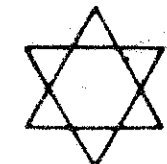

June, 1976

72

STATE OF FLORIDA
COUNTY OF PALM BEACH

THIS PLAT WAS FILED FOR RECORD AT M. THIS TH DAY 1976, and DULY RECORDED FOR PUBLIC RECORD IN PLAT BOOK NO. PAGES

JOHN S. DUNKLE, CREW
SURVEYOR



GRAPHIC SCALE
0' 5' 10' 15'
one inch equals ten feet

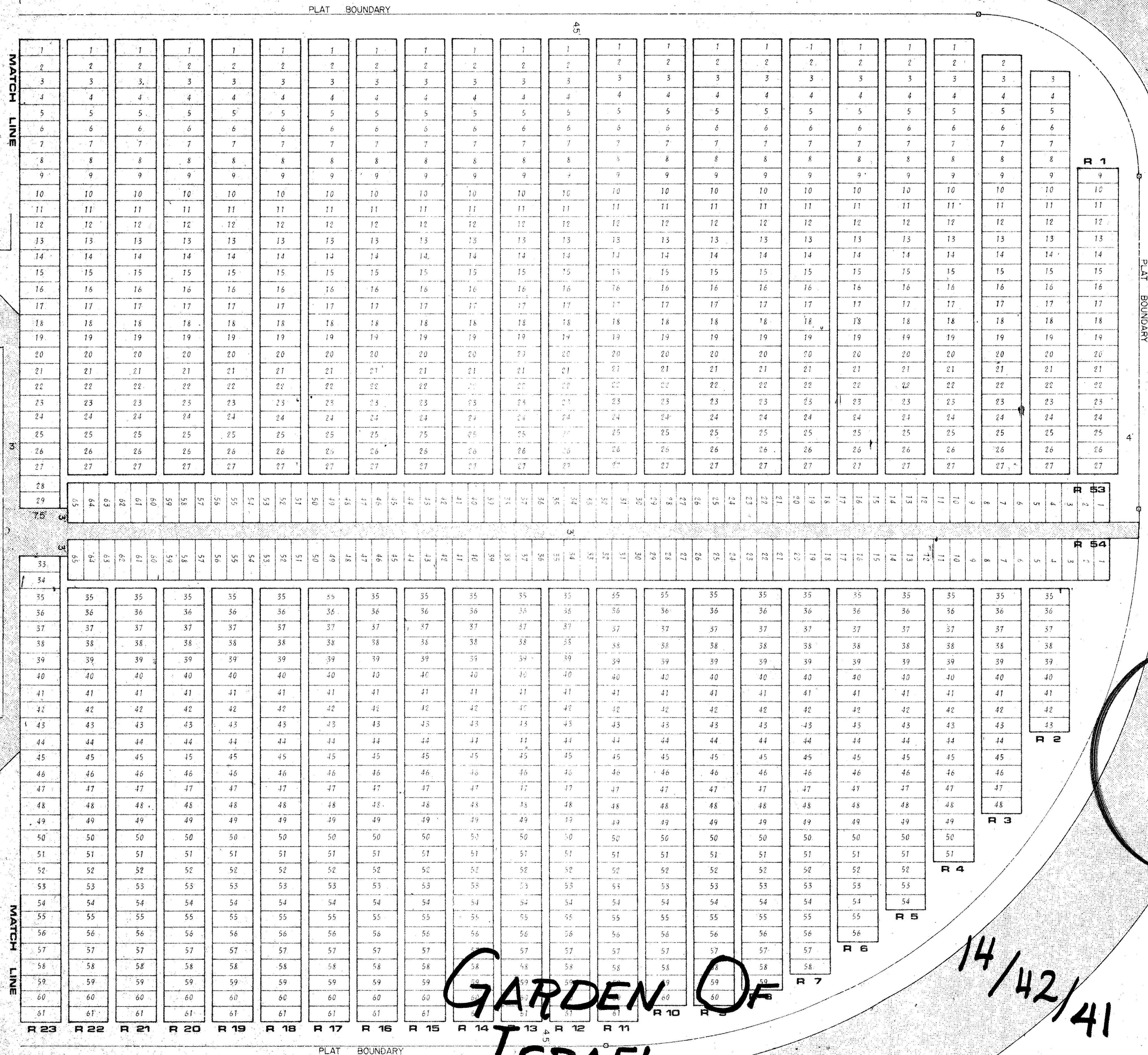

MOUNT SINAI DRIVE

1000-162

58

32/72

BENCH MARK
land surveying and mapping, inc.

NOTES:
A. FOR SURVEYOR'S NOTES SPECIFY TO SHEETS 2 and 3 OF 3, THIS PLAT, CONSULT SHEET 3 OF 3.
B. FOR MATCH AREA IN THIS SHEET, CONSULT SHEET 3 OF 3.
C. THIS INSTRUMENT WAS PREPARED BY ROBERT J. WHIDDEN IN THE OFFICES OF BENCH MARK LAND SURVEYING AND MAPPING, INC., 2300 PALM BEACH LAKES BOULEVARD, SUITE 109, WEST PALM BEACH, FLORIDA, 33409, phone (305) 689-8714.

14/42/41

GARDEN OF ISRAEL