

STATE OF FLORIDA)
COUNTY OF PALM BEACH)
This plat was filed for record
at 9:57 A.M. this 8 day of
January, 1976, and duly
recorded in Plat Book No. 31
on Page 1226, 1227, 1228
JOHN B. DUNKLE, Clerk Circuit
Court
By: *[Signature]*

WELLINGTON COUNTRY PLAZA

A PART OF WELLINGTON P.U.D.
A TRACT OF LAND LYING AND BEING IN PART
OF SECTION 3, TOWNSHIP 44 SOUTH, RANGE 41
EAST, PALM BEACH COUNTY, FLORIDA.

MILLER & THARIN INC. IN 2 SHEETS, SHEET NO. 1
LAND SURVEYORS WEST PALM BEACH, FLORIDA
JUNE 1975

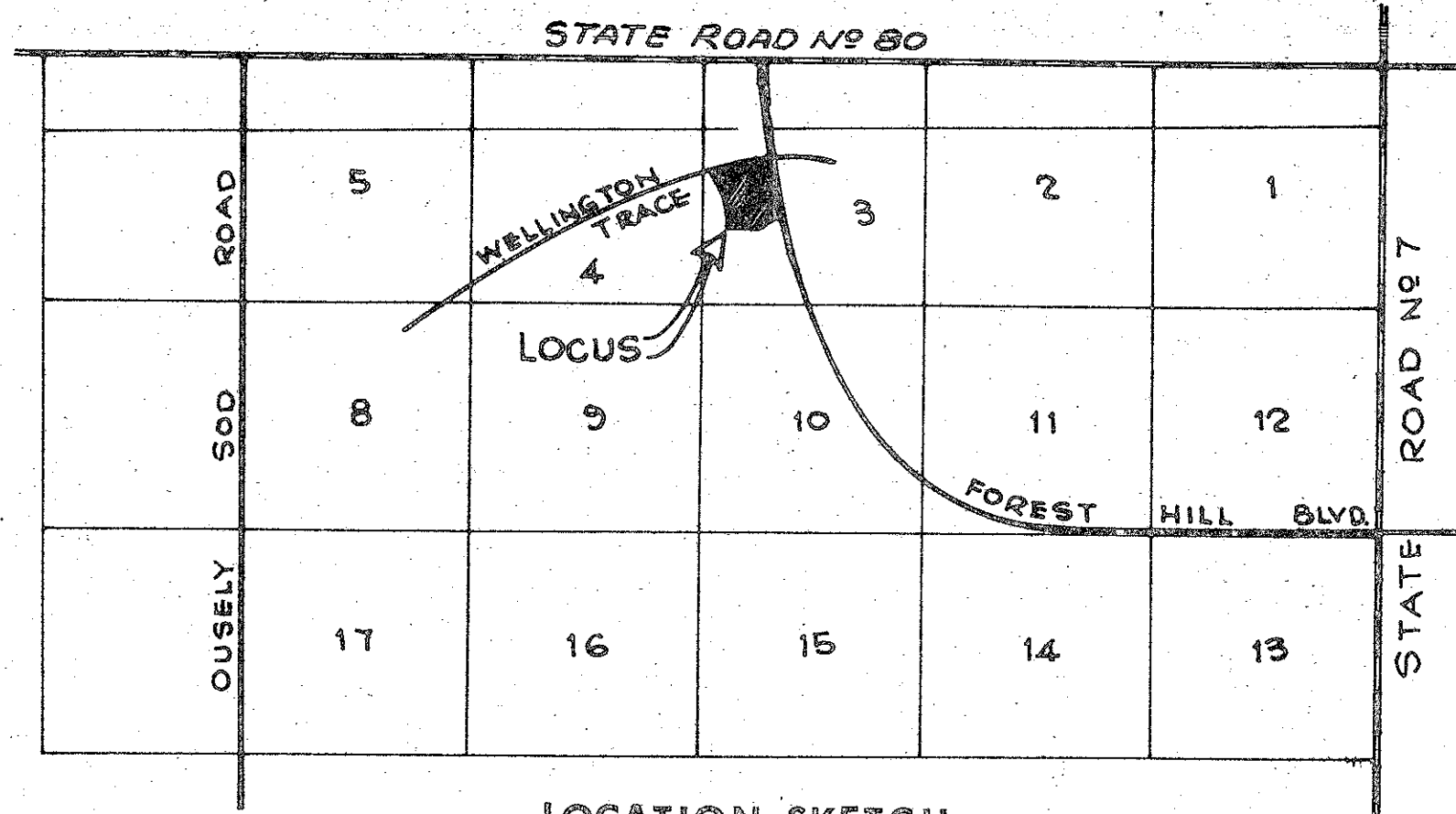

LOCATION SKETCH

DEDICATION

STATE OF FLORIDA)
COUNTY OF PALM BEACH)

KNOW ALL MEN BY THESE PRESENTS, that Trafalgar Properties Limited, a Florida limited Partnership, joined with Alcoa Florida, Inc. and Breakwater Housing Corp., both Florida corporations, owners of the land shown hereon, being in Section 3, Township 44 South, Range 41 East, Palm Beach County, Florida, shown hereon as Wellington Country Plaza being more particularly described as follows:

Commencing at the Southwest corner of said Section 3; thence South 89°-59'-42" East (for convenience all bearings shown herein are referred to an assumed meridian) along the South line of Section 3, a distance of 605.01 feet to a point on the East Right of Way line of canal C-7; thence North 01°-10'-33" East along said East line, a distance of 1289.20 feet to the POINT OF BEGINNING of the hereinafter described tract; thence continue North 01°-10'-33" East, a distance of 55.67 feet to the beginning of a curve concave to the Southwest having a radius of 859.40 feet and a central angle of 27°-51'-30"; thence Northerly and Northwesterly along the arc of said curve, a distance of 418.36 feet; thence North 26°-44'-57" West along the tangent to said curve, a distance of 520.92 feet to a point on the South Right of Way line of Wellington Trace and a curve concave to the Southeast having a radius of 2062.28 feet and a central angle of 16°-42'-42" and whose tangent at this point bears South 64°-46'-45" West; thence Northeasterly along the arc of said South line, a distance of 601.51 feet; thence North 81°-29'-27" East along the tangent to said curve, a distance of 107.42 feet; thence South 54°-31'-10" East, a distance of 34.73 feet to a point on the West Right of Way line of Forest Hill Boulevard and a curve concave to the Northeast having a radius of 2386.13 feet and a central angle 15°-43'-58" and whose tangent at this point bears North 10°-31'-46" West; thence Southeasterly along the arc of said West line, a distance of 571.91 feet; thence South 24°-15'-44" East along the tangent to said curve, a distance of 371.10 feet to the beginning of a curve concave to the Southwest having a radius of 590.43 feet and a central angle of 00°-36'-31"; thence Southeasterly along the arc of said curve, a distance of 54.07 feet; thence South 87°-55'-21" West, making an angle with the tangent of the previously described curve of 88°-25'-26" measured from North to West, a distance of 449.87 feet; thence North 88°-49'-27" West, a distance of 311.23 feet to a point on the East Right of Way line of Canal C-7 and the POINT OF BEGINNING.

Containing 16.291 Acres, more or less.

Has caused said lands to be surveyed and platted as shown hereon and hereby dedicates to the perpetual use of the public, the use and maintenance of the public utility easements. The easements shown for drainage and maintenance purposes are hereby dedicated to the ACME DRAINAGE DISTRICT, reserving, however, unto themselves their heirs, successors, assigns or legal representatives, the reversion or reversions thereof whenever the same shall be abandoned by the public or discontinued by law.

IN WITNESS WHEREOF, the said Florida Limited Partnership has caused these presents to be signed by its General Partner, ALAN BLACK, this 30th day of September, A.D., 1975.

TRAFALGAR PROPERTIES LIMITED

Witness: *[Signature]* ALAN BLACK, General Partner
Witness: *[Signature]*
Witness: *[Signature]*

ACKNOWLEDGEMENT

Before me personally appeared ALAN BLACK, to me well known, and known to me to be the individual described in and who executed the foregoing instrument as ALAN BLACK, General Partner of the above named Trafalgar Properties Limited, a Florida Limited Partnership, and he acknowledged to and before me that he executed such instrument as General Partner of said Limited Partnership, and that said instrument is the free act and deed of said Limited Partnership.

WITNESS my hand and official seal, this 30th day of September, A.D., 1975.

My commission expires: *[Signature]* March 12, 1977

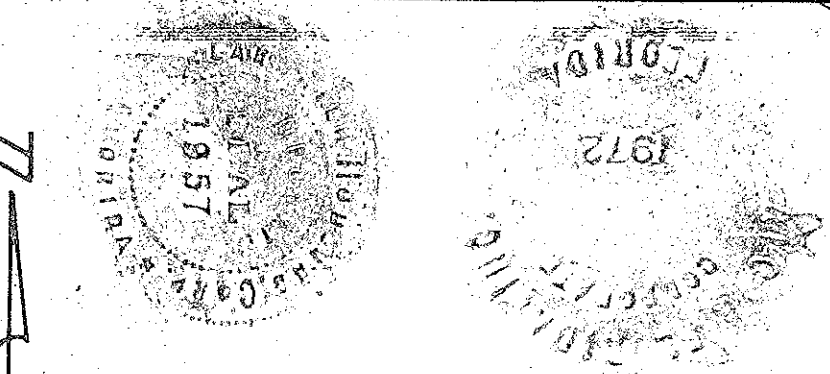

IN WITNESS WHEREOF, the said Corporation has caused these presents to be signed by their Vice President and Assistant Secretary, John R. Dunkle and Harriett B. Gilbreath, this 3 day of OCTOBER, A.D., 1975.

ALCOA FLORIDA, INC.

Attest: Assistant Secretary *[Signature]* By: *[Signature]* Vice President

ACKNOWLEDGEMENT

Before me personally appeared John R. Dunkle and Harriett B. Gilbreath, to me well known, and known to me to be the individuals described in and who executed the foregoing instrument as Vice President and Assistant Secretary of the above named Alcoa Florida, Inc., a Corporation, and severally acknowledged to and before me that they executed such instrument as such Vice President and Assistant Secretary, respectively, of said corporation, and that the seal affixed to the foregoing instrument is the corporate seal of said corporation and that it was affixed to said instrument by due and regular corporate authority, and that said instrument is the free act and deed of said corporation.

WITNESS my hand and official seal, this 3 day of OCTOBER, A.D. 1975.

My commission expires: *[Signature]* 9/23/77

IN WITNESS WHEREOF, the said Corporation has caused these presents to be signed by their President and Secretary, Guerry Stribling and James Sadock, Jr., this 2 day of OCTOBER, A.D., 1975.

BREAKWATER HOUSING CORP.

Attest: Secretary *[Signature]* By: *[Signature]* President

ACKNOWLEDGEMENT

Before me personally appeared Guerry Stribling and James Sadock, Jr., to me well known, and known to me to be the individuals described in and who executed the foregoing instrument as President and Secretary of the above named Breakwater Housing Corp., a Corporation, and severally acknowledged to and before me that they executed such instrument as such President and Secretary, respectively, of said corporation, and that the seal affixed to the foregoing instrument is the corporate seal of said corporation and that it was affixed to said instrument by due and regular corporate authority, and that said instrument is the free act and deed of said corporation.

WITNESS my hand and official seal, this 2 day of October, A.D. 1975.

My commission expires: *[Signature]* Oct. 23, 1978

IN WITNESS WHEREOF, the said District has caused these presents to be signed by its General Manager and Secretary, A.W. Glisson and Madison F. Pacetti, this 3 day of OCTOBER, A.D., 1975.

ACME DRAINAGE DISTRICT

Attest: General Manager *[Signature]* By: *[Signature]* Secretary

ACKNOWLEDGEMENT

I HEREBY CERTIFY that on this day personally appeared before me an officer duly authorized by law to administer oaths and take acknowledgements, MADISON F. PACETTI and A.W. GLISSON, Secretary and General Manager, respectively, of ACME DRAINAGE DISTRICT, and they executed the hereon Dedication as such officers of said District by and with the authority of the Board of Directors and that their act and deed of said District.

WITNESS my hand and official seal, this 3rd day of October, 1975.

My Commission expires: *[Signature]* June 27, 1978

MORTGAGEE'S CONSENT

STATE OF Florida)
COUNTY OF PALM BEACH)

The undersigned hereby certifies that he is a co-holder of a Mortgage upon the hereon described property and does hereby join in and consent to the dedication of the lands described in the dedication hereto, by the owner thereof and agrees that his Mortgage which is recorded in Official Record Book 1935, page 978, of the Public Records of Palm Beach County, Florida shall be subordinated to the dedication shown hereon.

Witness: *[Signature]* By: *[Signature]*
Roger Wellington as Co-Trustee of the Testamentary Trusts of C. O. Wellington, deceased.

ACKNOWLEDGEMENT

STATE OF Florida)
COUNTY OF Palm Beach)

Before me personally appeared Roger Wellington as Co-Trustee of the Testamentary Trusts of C. O. Wellington, deceased, to me well known and known to me to be the person described in and who executed the foregoing instrument, and acknowledged to and before me that he executed said instrument for the purposes therein expressed.

WITNESS my hand and official seal this 21st day of October, A.D., 1975.

My commission expires: *[Signature]* 9-22-77

SURVEYOR'S CERTIFICATION

I HEREBY CERTIFY that this plat complies with the New Florida Statutes (Chapter 71-339) of an Act relating to Maps and Plats approved by the Governor, June 27, 1971 and effective September 1, 1971, also that it is a true and correct representation of a survey, made under my direction, of the foregoing described property, and that said survey is accurate and correct to the best of my knowledge and belief, and that Permanent Reference Monuments have been placed as required by law and furthermore, that Permanent Control will be set in accordance with law after construction is complete.

THIS INSTRUMENT WAS PREPARED BY
DOUGLAS H. MILLER
417 So. Military Trail
West Palm Beach, Florida
By: *[Signature]*
Registered Land Surveyor
Fla. Certificate No. 1457

TITLE CERTIFICATION

I, HERBERT P. BENN, a duly licensed attorney in the state of Florida, do hereby certify that I have examined the title to the hereon described property; that I find the title to the property is vested to Trafalgar Properties Limited, a Florida Limited Partnership, and Alcoa Florida, Inc. and Breakwater Housing Corp., both Florida Corporations, that the current taxes have been paid; and I find that the property is encumbered by the mortgages shown hereon; and I find that all mortgages are shown and are true and correct.

By: *[Signature]*
HERBERT P. BENN

MORTGAGEE'S CONSENT

STATE OF NEW YORK)
COUNTY OF NEW YORK)

The undersigned hereby certifies that it is a co-holder of a Mortgage upon the hereon described property and does hereby join in and consent to the dedication of the lands described in the dedication hereto, by the owner thereof and agrees that its Mortgage which is recorded in Official Record Book 1935, page 978, of the Public Records of Palm Beach County, Florida, shall be subordinated to the dedication shown hereon.

In witness whereof, the said corporation has caused these presents to be signed by its Vice President and attested by its Assistant Secretary and its corporate seal to be affixed hereon by and with the authority of its board of directors, this 22nd day of October, A.D., 1975.

BANKERS TRUST COMPANY
as Co-Trustee of the Testamentary Trusts of C. O. Wellington, deceased.

Attest: *[Signature]* Assistant Secretary By: *[Signature]* Vice President (SEAL)

ACKNOWLEDGEMENT

STATE OF NEW YORK)
COUNTY OF NEW YORK)

Before me personally appeared *[Signature]* and *[Signature]*, to me well known, and known to me to be the individuals described in and who executed the foregoing instrument as Vice President and Assistant Secretary of the above named BANKERS TRUST COMPANY, a corporation, as Co-Trustee of the Testamentary Trusts of C. O. Wellington, deceased, and severally acknowledged to and before me that they executed such instrument as such Vice President and Assistant Secretary, respectively, of said corporation, and that the seal affixed to the foregoing instrument is the corporate seal of said corporation and that it was affixed to said instrument by due and regular corporate authority, and that said instrument is the free act and deed of said corporation.

WITNESS my hand and official seal, this 22nd day of October, A.D., 1975.

By: *[Signature]* Notary Public

My commission expires: *[Signature]* March 30, 1976

BOARD OF COUNTY COMMISSIONERS
This Plat is hereby approved for record, this 2nd day of October, A.D. 1975.

By: *[Signature]* Chairman

COUNTY ENGINEER
This Plat is hereby found to meet all requisite State and County laws and ordinances.

By: *[Signature]* County Engineer

ATTEST: John B. Dunkle, Clerk Board of County Commissioners

By: *[Signature]* Deputy Clerk

0332-001

