

MODEL LAND CO.

SUBDIVISION OF
THE N 1/4 AND THE SE 1/4 OF THE NEX,
THE W 1/4 AND THE SE 1/4 OF
SEC 2 T 44 S R 42 E

5-80

GEORGE B. BOWEN
ENGINEER
WEST PALM BEACH, FLA.
Aug 14, 1912

WEST PALM BEACH CANAL

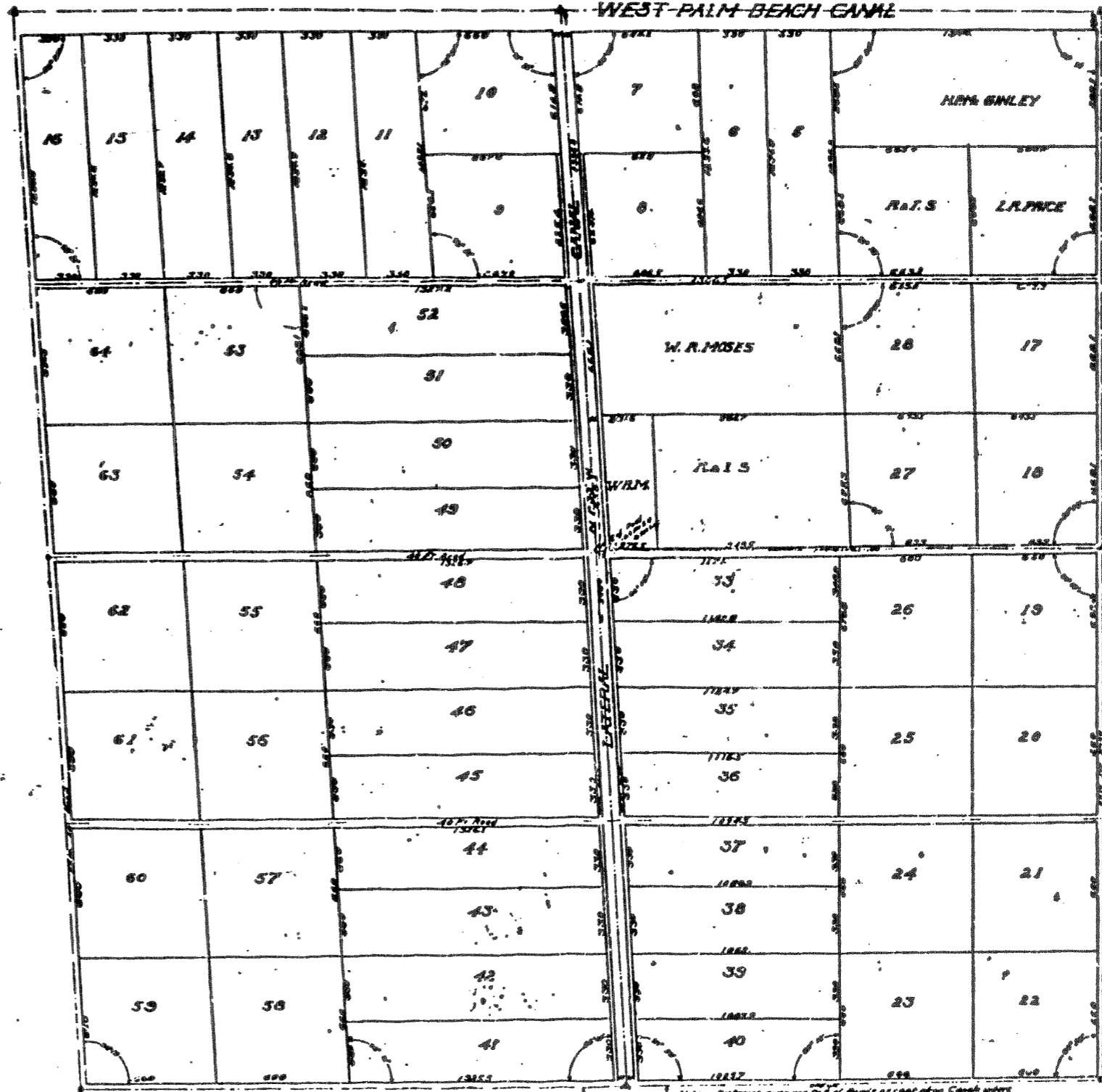

KNOW ALL MEN BY THESE PRESENTS, That the Model Land Co. a Corporation created and organized under the laws of the State of Florida, the first lawful owner of the N 1/4 and the SE 1/4 of the NEX, the W 1/4 and the SE 1/4 of the NEX, T. 44 S., R. 42 E., lying in Palm Beach Co. Florida, and shown on this plat, has caused said land to be surveyed, plotted and platted, and does hereby certify to the proper use of the same as public highways the roads shown hereon to be in the possession of the State of Florida, to be used for the purpose and in the manner shown on this plat, and to be subject to the same as such roads.

IN WITNESS WHEREOF the Model Land Co. has caused this certificate to be signed as its Agent by its President, and attested by its Secretary, and its corporate seal hereunto affixed this 14th day of August, A.D. 1912.

Model Land Co.
President: *Richard Hamilton*
Secretary: *W. H. Ingraham*

STATE OF FLORIDA
COUNTY OF ST. JOHN

Before me personally appeared J. B. Ingraham, Clerk and Attorney and acknowledged that he executed the foregoing Certificate as President of the Model Land Co., a Corporation, and before me also appeared Richard Hamilton, and acknowledged that, as Secretary of said Corporation, he executed the Certificate of said Corporation by the President of said Corporation, and affixed thereto the corporate seal of said Corporation.

IN WITNESS WHEREOF, I have hereunto set my hand and official seal of my office as Clerk of St. John County, Florida, this 14th day of August, A.D. 1912.

J. B. Ingraham
Clerk of St. John County, Florida
My Commission Expires
14th day of Aug., 1912

STATE OF FLORIDA
COUNTY OF PALM BEACH

Before me personally appeared Carl E. Bidwell, Clerk and Attorney, who being duly sworn depose and say that he is a member of the firm of Bidwell, Bidwell, Bidwell, and that the above plat, map and is made in accordance with an official survey of the land shown hereon, and that the signatories appearing on said plat do execute and swear to the truth of the foregoing and certify.

Carl E. Bidwell

Sworn to and attested before me at West Palm Beach, Florida, this 14th day of Sept. A.D. 1912.

Notary Public in and for the State of Florida at Large
My Commission Expires
14th day of Sept., 1912

7th day of Sept. 1912
John D. ...
...

Original One Cent and 2
Reproduction Same

Note: Distances given are full of Roads except along Canal where distances are given to boundary line Canal right of way. Streets 50 ft wide and numbered roads set in boundary line of Roads and Tracts.