

**FLORIDA FRUIT LANDS COMPANY'S
SUBDIVISION No 2**

**IN
PALM BEACH COUNTY,
FLORIDA**

State of Missouri }
County of Jackson } SS
Personally appeared before me the undersigned authority, The Florida Fruit
Lands Company, a corporation organized under the laws of the State of
Colorado, by George A. Rudock, its President and John Matthews its Secretary
who have duly sworn under oath that they are the officers of said Com-
pany as stated, that the accompanying Subdivision map of certain lands of
The Florida Fruit Lands Company, situated in Palm Beach County, Florida, was
executed as the actual deed of incorporation under the resolution of the Board
of Directors thereof, and that the corporate seal of said corporation was affixed
thereto in accordance with the resolution of the Board of Directors to the end that
the said subdivision map may be with the force and effect of a law, and that said
seal bears the genuine and authentic corporate name and corporation,
The Florida Fruit Lands Company.

Corp. Seal

Witness my hand and the seal of my office
this 15th day of February, A. D. 1911.

Notary Public
George A. Rudock
President

John Matthews
Secretary

My Commission Expires June 23, 1912.

Map Seal

1000-807

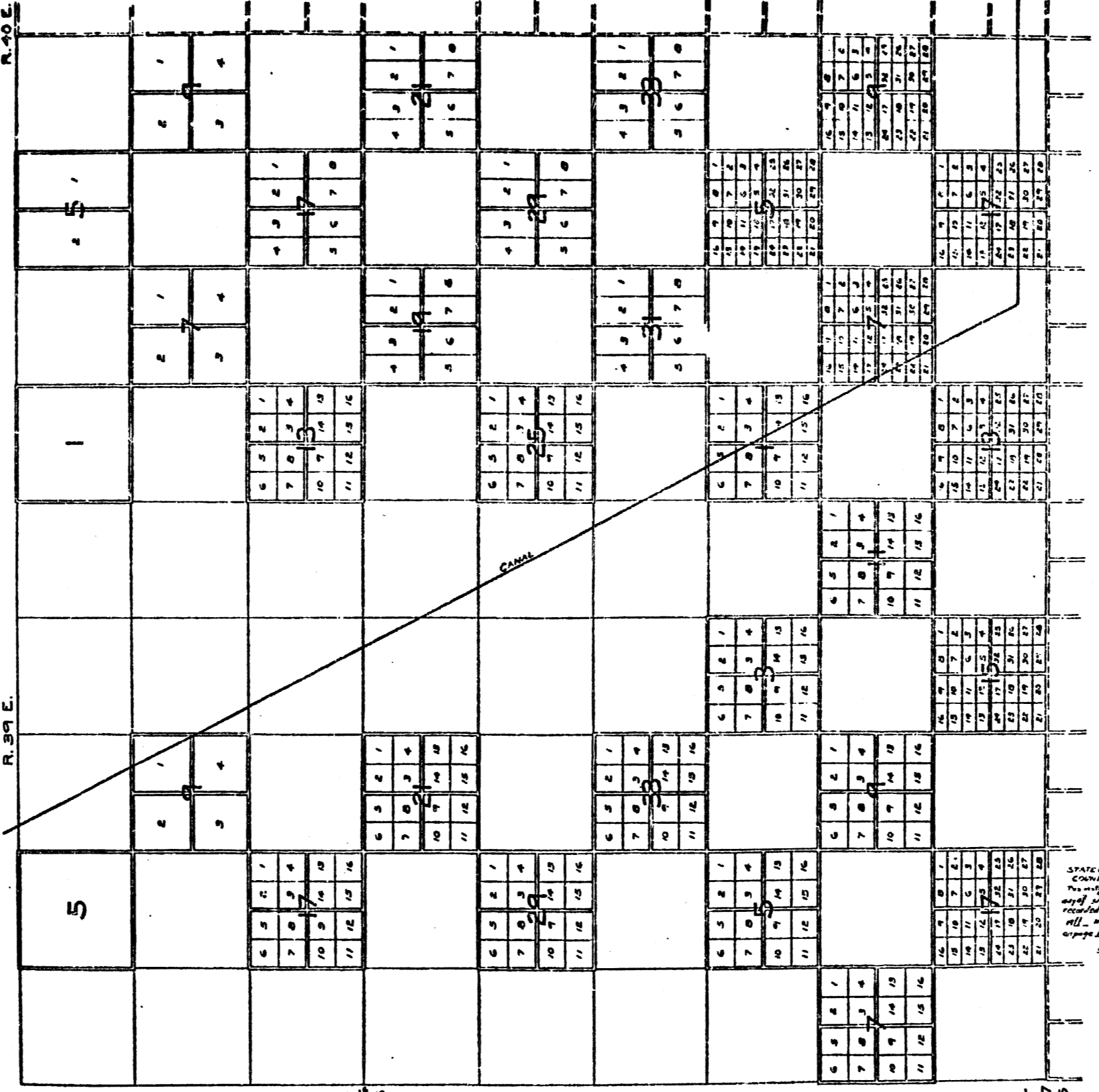

1-102
A

STATE OF FLORIDA
COUNTY OF PALM BEACH }
I, the undersigned, Clerk of the County, do hereby certify that the
above described map is a true and correct copy of the original
as the same is on file in my office.
Witness my hand and the seal of my office
this 15th day of February, A. D. 1911.
Clerk of the County

1000-807

102
Copied by
BIDWELL & HOLSTMAN
LAW OFFICES
Palm Beach, Florida
4 Sheets
Sheet No. 1