

Palm Beach County (County) makes no representation or warranties whatsoever on the attached / enclosed information reflected herein pertaining to easements, rights-of-way, setback lines, reservations, agreements, and other similar matters. The information provided herein should not be relied upon by the requesting party to confirm the existence / non-existence of facts contained herein.

- 1/4-01-SUNSET PARK IN LAKEWORTH PB 6 P 65 (SE NW & SE SE)
- 1/4-02-RESUB OF TR 5 OF SUNSET PARK PB 14 P 65 004 38
- 1/4-03-THORBURY HEIGHTS PB 26 P 65
- 1/4-04-HUB PROPERTIES PB 24 P 101
- 1/4-05-LAKE OSBORNE TERRACE PB 25 P 21
- 1/4-06-LAKESIDE POINT CONDO NO 6
- 1/4-07-LAKESIDE POINT " NO 5
- 1/4-08-LAKESIDE POINT " NO 4
- 1/4-09-LAKESIDE POINT " NO 12
- 1/4-10-LAKESIDE POINT " NO 3
- 1/4-11-LAKESIDE POINT " NO 1
- 1/4-12-LAKESIDE POINT " NO 2
- 1/4-13-LAKESIDE POINT " NO 7
- 1/4-14-LAKESIDE POINT " NO 14
- 1/4-15-LAKESIDE POINT " NO 8
- 1/4-16-LAKESIDE POINT " NO 11
- 1/4-17-MURRY HILLS CONDO'S
- 1/4-18-PARKVIEW VILLAS CONDOS
- 1/4-19-PARK TOWERS APTS INC CO-OP

NOTE: PT OF E 1/2 IN LAKE WORTH-36 REMAINDER IN COUNTY 30

ABANDONED CENTER STREET
PUT NIS' OF ROAD IN OWNERS' NAMES ON N SIDE OF ROAD PER FLORIDA STATUTE 177-085 10/21/76

NOTE:
NOT TO BE REPRODUCED IN
ANY FORM EXCEPT BY EXPRESS
WRITTEN CONSENT FROM THE
PALM BEACH COUNTY
PROPERTY APPRAISER
Information shown herein is
compiled from the best available
sources and CANNOT be used
for surveys or land transfers of
any type.

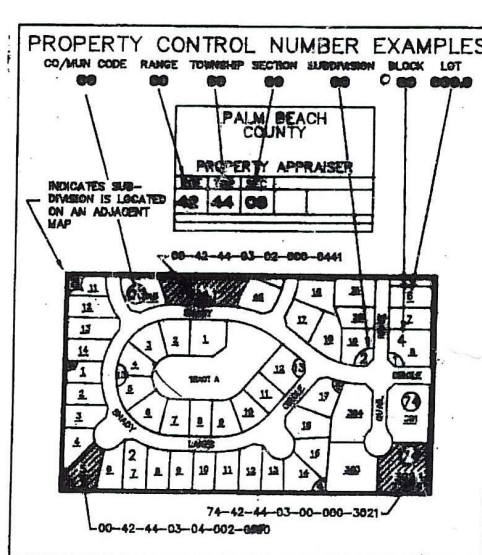

PALM BEACH COUNTY
GARY R. NIKOLITS
PROPERTY APPRAISER

RGE	TWP	SEC	AERIAL
43	44	29	NO1088
SCALE 1" = 200'			
DRAWN BY MRC			
UPDATED TEDMOND 05-30-02			