

Should be CMB 2-105  
2-6-1917

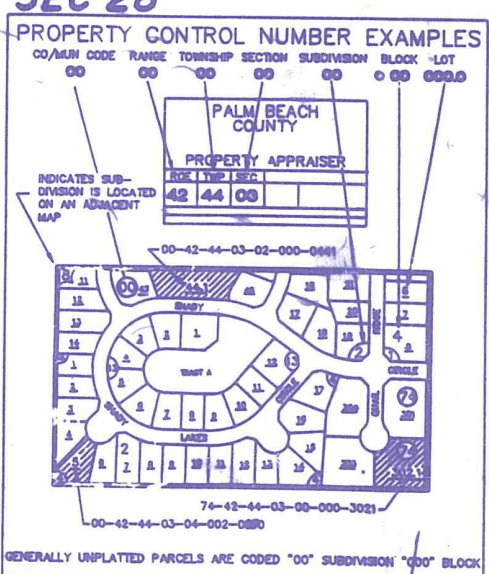
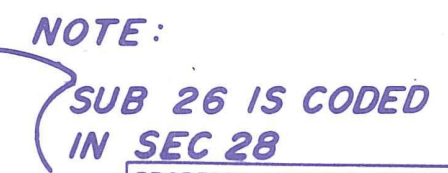

NOTE:  
ALL OF SEC. 29 IS CODED  
IN MUN OF RIVIERA BCH 5

SE	51	PALM BEACH	OIL (81)	PB41P9
SE	52	METZGER TRACT	(1982)	PB42 P185
SE	53	SOLITRON	(1982)	PB43 P76
SE	54	AUSTRALIAN WAREHOUSE	COND. NO. 2	(1982)
S 1/2	55	LEWIS TERMINALS	PL NO. C	(1983)
			PB44 P43	
SE	56	SOLITRON REPLAT	PB44 P79	(1983)
NE	57	SUGAR HILL REPLAT OF PORTION	P55 P164	(1984)
NE	58	SUN COAST TERRACE	PB46 P13	(1984)
SW	59	TIMBER PINE COND (85)		
SW	60	TIMBER PINE WEST AIKIA		
		ALLISON PARK	PB21P25	

NOTE:  
NOT TO BE REPRODUCED IN  
ANY FORM EXCEPT BY EXPRESS  
WRITTEN CONSENT FROM THE  
PALM BEACH COUNTY  
PROPERTY APPRAISER  
\_\_\_\_\_  
Information shown herein is  
compiled from the best available  
sources and CANNOT be used  
for surveys or land transfers of  
any type.

**PALM BEACH  
COUNTY**  
*N-15*  
**PROPERTY APPRAISER**

36	31	32	33	34	35	36	31	RGE	TWP	SEC	AERIAL
4	6	5	4	3	2	1	6	43	42	29	NO 67-d
12	7	8	9	10	11	12	7	SCALE	1 : 200'		
13	18	17	16	15	14	13	18	DRAWN BY	KESHIAN 7-26		
24	19	20	21	22	23	24	19	UPDATED			
25	30	29	28	27	26	25	30				
36	31	32	33	34	35	36	31				
1	6	5	4	3	2	1	6				

Notes:

- Silver Beach Rd., between Ave. 'S' & Lake shore Dr. maintained by P.B. Co. as per R 92-800.
- Blue Heron Blvd., between U.S. #1 & I-95 maintained by P.B. Co. as per R 92-136
- BLUE HERON & BY R. 99-793 to U. TO STATE BOWN I 95 to U.

- Blue Heron Blvd, between U.S. #1 & West city Limits of Riviera Bch. maintained by P.B. Co. as per R 92-800. →
- Old Dixie Hwy. maintained by P.B. Co. within Riviera Bch. City Limits as per R 92-800

SEE SEC 32  
ALSO

See sec 32 also

LOTS 13, 14, &  
CODED IN SEC.  
28 SUB 31

23-2  
6.67A  
TR W-X