

NE 01 LOXAHATCHEE CLUB PROP PB20-77
 NE 02 FOX RUN (1977) PB32P76
 SE03 FIRST ADD PL1 EAGLES NEST(8) PB39P10
 NW04 IMPERIAL WOODS (981) PB39P141
 SE05 WHISPERING TRAILS PL 1 (1980) PB40P95
 SE06 WHISPERING TRAILS PL 2 (1980) PB41P106
 SW07 WHISPERING TRAILS PL 3 (1987) PB53P26
 SE-SW08 WHISPERING TRAILS PL 4 (1987) PB53P49
 SE09 SHORES PL 6 (1988) FE57P32
 SE10 SHORES PL 5 (1988) PE58F138
 NE11 LOXAHATCHEE POINTE(9) PB59P24

SW 12 SHOREWOOD (89) PB61P45
 NE 13 LOXAHATCHEE POINTE REPL (90) PB63P89
 W 1/2 14 NORTH FORK (90) PB63P184
 SW 15 PRESERVE AT JUPITER (91) PB65 P35
 NW 16 NORTH FORK PL 2 (91) PB65P70
 NE 17 FOX RUN LT 13 REPL (91) PB65P10800
 SW 18 CYPRESS COVE OF JUPITER (91) PB65P156

NOTES:
 NORTHFORK DR: REMOVED FROM PBC MAINTENANCE
 List From LONGSHORE DR. to
 MARTIN County Imp.
 RES. 92-800 (RES FILE)

NOTE:
 PT OF SEC IN COUNTY 00
 PT OF SEC IN JUPITER 30

Palm Beach County (County) makes no representation or warranties whatsoever on the attached / enclosed information reflected herein pertaining to easements, rights-of-way, setback lines, reservations, agreements, and other similar matters. The information provided herein should not be relied upon by the requesting party to confirm the existence / non-existence of facts contained herein.

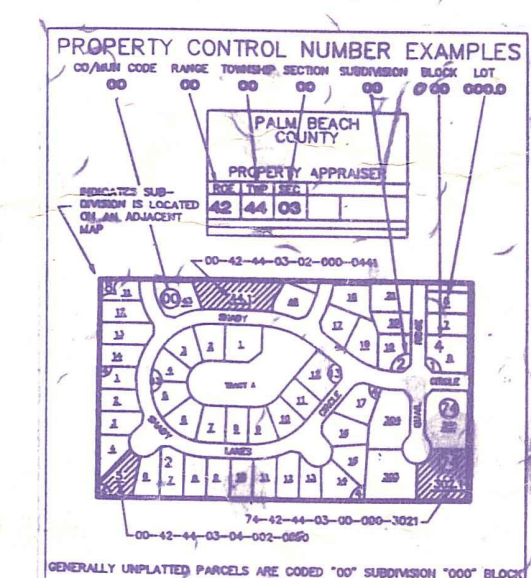

NOTE:
 NOT TO BE REPRODUCED IN
 ANY FORM EXCEPT BY EXPRESS
 WRITTEN CONSENT FROM THE
 PALM BEACH COUNTY
 ASSESSOR.
 Information shown hereon is
 compiled from the best available
 sources and CANNOT be used
 for surveys or land transfers of
 any type.

PALM BEACH
 COUNTY
 4

PROPERTY APPRAISER

RGE	TWP	SEC	AERIAL
12	40	27	No 1131
SCALE	1"=200'		
DRAWN BY	J. B. Little		
UPDATED	9/92 Jim		

36	31	32	33	34	35	36
1	6	5	4	3	2	1
12	7	8	9	10	11	12
13	18	17	16	15	14	13
24	19	20	21	22	23	24
25	30	29	28	27	26	25
36	31	32	33	34	35	36
1	6	5	4	3	2	1