

RESOLUTION NO. R-2019- 1699

RESOLUTION APPROVING ZONING APPLICATION ZV/PDD/CA-2019-00508  
(CONTROL NO. 1997-00004)  
a Class A Conditional Use  
APPLICATION OF SFD Boynton, LLC, PEBB Boynton, LLC  
BY Dunay, Miskel and Backman, LLP, Urban Design Kilday Studios, AGENT  
(Fountains East MUPD)

WHEREAS, the Board of County Commissioners, as the governing body of Palm Beach County, Florida, pursuant to the authority vested in Chapter 163 and Chapter 125, Florida Statutes, is authorized and empowered to consider applications relating to zoning;

WHEREAS, the notice and public hearing requirements pursuant to Article 2 (Application Processes and Procedures) of the Palm Beach County Unified Land Development Code (ULDC), Ordinance 2003-067, Supplement 25, have been satisfied;

WHEREAS, Zoning Application ZV/PDD/CA-2019-00508 was presented to the Board of County Commissioners at a public hearing conducted on October 24, 2019;

WHEREAS, the Board of County Commissioners has considered the evidence and testimony presented by the Applicant and other interested parties, the recommendations of the various County Review Agencies, and the recommendation of the Zoning Commission;

WHEREAS, the Board of County Commissioners pursuant to Article 2 (Application Processes and Procedures) of the ULDC is authorized and empowered to consider, approve, approve with conditions or deny the request;

WHEREAS, the Board of County Commissioners hereby incorporates by reference the Findings in the staff report addressing the Standards contained in Article 2.B (Public Hearing Processes) for a Class A Conditional Use;

WHEREAS, this approval is subject to Article 2.E (Monitoring), of the ULDC and other provisions requiring that development commence in a timely manner;

WHEREAS, the issuance of this Development Permit does not in any way create any rights on the part of the Applicant and/or Property Owner to obtain a permit from a state or federal agency and does not create any liability on the part of the County for issuance of the permit if the Applicant fails to obtain requisite approvals or fulfill the obligations imposed by a state or federal agency or undertakes actions that result in a violation of state or federal law;

WHEREAS, the Palm Beach County Survey Section may administratively correct any scrivener's errors that will not significantly impact the overall boundary of the adopted legal description; and,

WHEREAS, Article 2.B.6.C (Board Action) of the ULDC requires that the action of the Board of County Commissioners be adopted by resolution.

NOW, THEREFORE, BE IT RESOLVED BY THE BOARD OF COUNTY COMMISSIONERS OF PALM BEACH COUNTY, FLORIDA, that Zoning Application ZV/PDD/CA-2019-00508, the Application of SFD Boynton, LLC, PEBB Boynton, LLC, by Dunay, Miskel and Backman, LLP, Urban Design Kilday Studios, Agent, for a Class A Conditional Use to allow a Type 1 Restaurant over 5,000 square feet, on a parcel of land generally described as shown on the legal description in EXHIBIT A, attached hereto and made a part hereof, and generally located as shown on a vicinity sketch as indicated in EXHIBIT B, attached hereto and made a part hereof, was approved on October 24, 2019, subject to the Conditions of Approval described in EXHIBIT C, attached hereto and made a part hereof.

Commissioner Kerner moved for the approval of the Resolution.

The motion was seconded by Commissioner Weiss and, upon being put to a vote, the vote was as follows:

Commissioner Mack Bernard, Mayor	- Aye
Commissioner Dave Kerner, Vice Mayor	- Aye
Commissioner Hal R. Valeche	- Aye
Commissioner Gregg K. Weiss	- Aye
Commissioner Robert S. Weinroth	- Absent
Commissioner Mary Lou Berger	- Aye
Commissioner Melissa McKinlay	- Aye

The Mayor thereupon declared that the resolution was duly passed and adopted on October 24, 2019.

Filed with the Clerk of the Board of County Commissioners on October 30th, 2019

This resolution is effective when filed with the Clerk of the Board of County Commissioners.

APPROVED AS TO FORM  
AND LEGAL SUFFICIENCY

PALM BEACH COUNTY, FLORIDA  
BY ITS BOARD OF COUNTY  
COMMISSIONERS

SHARON R. BOCK,  
CLERK & COMPTROLLER

BY:

  
COUNTY ATTORNEY

BY:

  
DEPUTY CLERK FLORIDA



EXHIBIT A

LEGAL DESCRIPTION

THE LAND REFERRED TO HEREIN BELOW IS SITUATED IN THE COUNTY OF PALM BEACH, STATE OF FLORIDA, AND IS DESCRIBED AS FOLLOWS:

A PARCEL OF LAND SITUATED IN SECTION 22, TOWNSHIP 45 SOUTH, RANGE 42 EAST, PALM BEACH COUNTY, FLORIDA, BEING MORE PARTICULARLY DESCRIBED AS FOLLOWS:

COMMENCING AT THE SOUTHWEST CORNER OF THE SOUTHEAST ONE-QUARTER (SE 1/4) OF THE AFORESAID SECTION 22; THENCE NORTH 00°41'06" WEST ALONG THE WEST LINE OF SAID SOUTHEAST ONE-QUARTER (SE 1/4) A DISTANCE OF 1331.34 FEET TO THE SOUTH LINE OF THE NORTHWEST ONE-QUARTER (NW 1/4) OF SAID SOUTHEAST ONE-QUARTER (SE 1/4); THENCE NORTH 89°31'42" EAST ALONG SAID LINE, DISTANCE OF 51.88 FEET TO THE EAST RIGHT-OF-WAY LINE OF JOG ROAD AS DESCRIBED IN OFFICIAL RECORDS BOOK 4224, PAGE 780, AND THE POINT OF BEGINNING; THENCE CONTINUE NORTH 89°31'42" EAST, A DISTANCE OF 615.46 FEET TO A POINT ON THE WEST LINE OF THE WEST ONE-HALF (W1/2) OF THE NORTHEAST ONE-QUARTER (NE 1/4) OF THE SOUTHWEST ONE-QUARTER (SW 1/4) OF THE SOUTHEAST ONE-QUARTER (SE 1/4) OF SAID SECTION 22; THENCE SOUTH 00°30'38" EAST ALONG SAID LINE, A DISTANCE OF 1144.98 FEET TO A POINT ON THE NORTH RIGHT-OF-WAY LINE OF BOYNTON BEACH BOULEVARD (STATE ROAD 804) AS SHOWN IN COUNTY ROAD PLAT BOOK 2, PAGE 5, AND AS CONVEYED TO THE STATE OF FLORIDA IN OFFICIAL RECORDS BOOK 4251, PAGE 575 AND AS SHOWN ON FLORIDA DEPARTMENT OF TRANSPORTATION RIGHT-OF-WAY MAP SECTION 97931-2347; THENCE NORTH 86°24'21" WEST, ALONG SAID NORTH RIGHT-OF-WAY LINE, A DISTANCE OF 324.19 FEET; THENCE CONTINUE ALONG SAID NORTH RIGHT-OF-WAY LINE NORTH 88°18'58" WEST, A DISTANCE OF 270.97 FEET TO THE POINT OF BEGINNING OF A CURVE CONCAVE TO THE NORTH, HAVING A RADIUS OF 30.00 FEET AND A CENTRAL ANGLE OF 88°08'31"; THENCE NORTHWESTERLY AND NORTHERLY ALONG THE ARC OF SAID CURVE, A DISTANCE OF 46.15 FEET TO A POINT ON THE EAST RIGHT-OF-WAY LINE OF JOG ROAD; THENCE NORTH 00°10'27" WEST ALONG SAID EAST RIGHT-OF-WAY LINE, A DISTANCE OF 1081.68 FEET TO THE POINT OF BEGINNING.

THE ABOVE PARCEL BEING ALSO DESCRIBED AS FOLLOWS:

A PARCEL OF LAND SITUATED IN SECTION 22, TOWNSHIP 45 SOUTH, RANGE 42 EAST, PALM BEACH COUNTY, FLORIDA, BEING MORE PARTICULARLY DESCRIBED AS FOLLOWS:

COMMENCING AT THE SOUTHWEST CORNER OF THE SOUTHEAST ONE-QUARTER (SE 1/4) OF THE AFORESAID SECTION 22; THENCE NORTH 00°41'06" WEST ALONG THE WEST LINE OF SAID SOUTHEAST ONE-QUARTER (SE 1/4) A DISTANCE OF 1333.46 FEET TO THE SOUTH LINE OF THE NORTHWEST ONE-QUARTER (NW 1/4) OF SAID SOUTHEAST ONE-QUARTER (SE 1/4); THENCE NORTH 89°34'27" EAST ALONG SAID LINE, A DISTANCE OF 52.01 FEET TO THE EAST RIGHT-OF-WAY LINE OF JOG ROAD AS DESCRIBED IN OFFICIAL RECORDS BOOK 4224, PAGE 780, AND THE POINT OF BEGINNING; THENCE CONTINUE NORTH 89°34'27" EAST, A DISTANCE OF 616.20 FEET TO A POINT ON THE WEST LINE OF THE WEST ONE-HALF (W 1/2) OF THE NORTHEAST ONE-QUARTER (NE 1/4) OF THE SOUTHWEST ONE-QUARTER (SW 1/4) OF THE SOUTHEAST ONE-QUARTER (SE 1/4) OF SAID SECTION 22; THENCE SOUTH 00°32'07" EAST ALONG SAID LINE, A DISTANCE OF 1146.58 FEET TO A POINT ON THE NORTH RIGHT-OF-WAY LINE OF BOYNTON BEACH BOULEVARD (STATE ROAD 804) AS SHOWN IN COUNTY ROAD PLAT BOOK 2, PAGE 5, AND AS CONVEYED TO THE STATE OF FLORIDA IN OFFICIAL RECORDS BOOK 4251, PAGE 575 AND AS SHOWN ON FLORIDA DEPARTMENT OF TRANSPORTATION RIGHT-OF-WAY MAP SECTION 97931-2347; THENCE NORTH

86°24'21" WEST, ALONG SAID NORTH RIGHT-OF-WAY LINE, A DISTANCE OF 333.50 FEET; THENCE CONTINUE ALONG SAID NORTH RIGHT-OF-WAY LINE NORTH 88°18'58" WEST, A DISTANCE OF 261.75 FEET TO THE POINT OF BEGINNING OF A CURVE CONCAVE TO THE NORTH, HAVING A RADIUS OF 30.00 FEET AND A CENTRAL ANGLE OF 88°08'31"; THENCE NORTHWESTERLY AND NORTHERLY ALONG THE ARC OF SAID CURVE, A DISTANCE OF 46.15 FEET TO A POINT ON THE EAST RIGHT-OF-WAY LINE OF JOG ROAD; THENCE NORTH 00°10'27" WEST ALONG SAID EAST RIGHT-OF-WAY LINE, A DISTANCE OF 1083.46 FEET TO THE POINT OF BEGINNING.

CONTAINING, 698,236 SQUARE FEET/16.0293 ACRES, MORE OR LESS. SAID LANDS SITUATE IN PALM BEACH COUNTY, FLORIDA.

EXHIBIT B  
VICINITY SKETCH

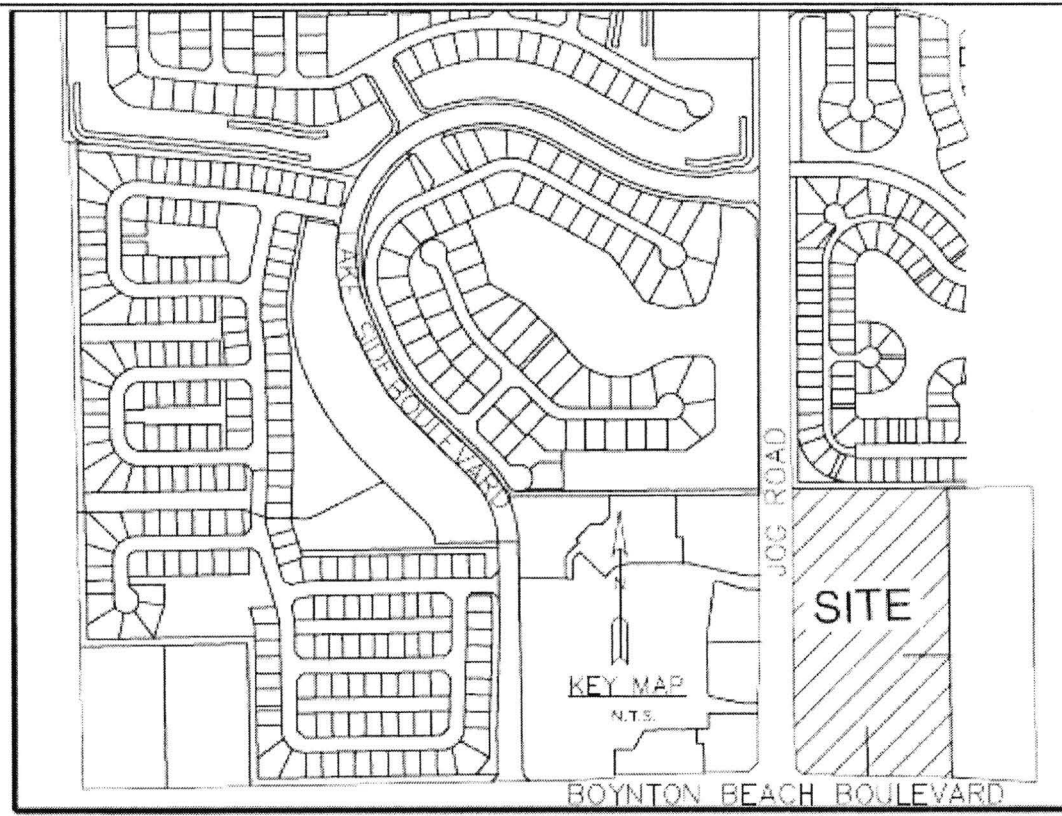



## EXHIBIT C

### CONDITIONS OF APPROVAL

#### **Class A Conditional Use – Type 1 Restaurant over 5,000 square feet**

##### **ALL PETITIONS**

1. The approved Preliminary Site Plan is dated June 24, 2019. Modifications to the Development Order inconsistent with the Conditions of Approval, or changes to the uses or site design beyond the authority of the Development Review Officer as established in the Unified Land Development Code, must be approved by the Board of County Commissioners. (ONGOING: ZONING - Zoning)

##### **COMPLIANCE**

1. In Granting this Approval, the Board of County Commissioners relied upon the oral and written representations of the Property Owner/Applicant both on the record and as part of the application process. Deviations from or violation of these representations shall cause the Approval to be presented to the Board of County Commissioners for review under the Compliance Condition of this Approval.

2. Failure to comply with any of the Conditions of Approval for the subject property at any time may result in:

- a. The Issuance of a Stop Work Order; the Issuance of a Cease and Desist Order; the Denial or Revocation of a Building Permit; the Denial or Revocation of a Certificate of Occupancy; the Denial of any other Permit, License or Approval to any developer, Owner, lessee, or user of the subject property; the Revocation of any other permit, license or approval from any developer, Owner, lessee, or user of the subject property; the Revocation of any concurrency; and/or
- b. The Revocation of the Official Map Amendment, Conditional Use, Requested Use, Development Order Amendment, and/or any other zoning approval; and/or
- c. A requirement of the development to conform with the standards of the Unified Land Development Code at the time of the finding of non-compliance, or the addition or modification of conditions reasonably related to the failure to comply with existing Conditions of Approval; and/or
- d. Referral to Code Enforcement; and/or
- e. Imposition of entitlement density or intensity.

Staff may be directed by the Executive Director of PZ&B or the Code Enforcement Special Master to schedule a Status Report before the body which approved the Official Zoning Map Amendment, Conditional Use, Requested Use, Development Order Amendment, and/or other zoning approval, in accordance with the provisions of Section 2.E of the ULDC, in response to any flagrant violation and/or continued violation of any Condition of Approval. (ONGOING: MONITORING - Zoning)

##### **DISCLOSURE**

1. All applicable state or federal permits shall be obtained before commencement of the development authorized by this Development Permit.