

RESOLUTION NO. R-2019-0693

RESOLUTION APPROVING ZONING APPLICATION SV/ABN/Z/CA-2018-00774  
(CONTROL NO. 1975-00168)  
an Official Zoning Map Amendment  
APPLICATION OF Els For Autism Foundation Inc  
BY Cotleur & Hearing, Inc., AGENT  
(Els Center for Excellence)

WHEREAS, the Board of County Commissioners, as the governing body of Palm Beach County, Florida, pursuant to the authority vested in Chapter 163 and Chapter 125, Florida Statutes, is authorized and empowered to consider applications relating to zoning;

WHEREAS, the notice and public hearing requirements pursuant to Article 2 (Application Processes and Procedures) of the Palm Beach County Unified Land Development Code (ULDC), Ordinance 2003-067 Supplement 24, have been satisfied;

WHEREAS, Zoning Application SV/ABN/Z/CA-2018-00774 was presented to the Board of County Commissioners at a public hearing conducted on May 23, 2019;

WHEREAS, the Board of County Commissioners has considered the evidence and testimony presented by the Applicant and other interested parties, the recommendations of the various County Review Agencies, and the recommendation of the Zoning Commission;

WHEREAS, the Board of County Commissioners pursuant to Article 2 (Application Processes and Procedures) of the ULDC is authorized and empowered to consider, approve, approve with conditions or deny the request;

WHEREAS, the Board of County Commissioners hereby incorporates by reference the Findings in the staff report addressing the Standards contained in Article 2.B (Public Hearing Processes) for an Official Zoning Map Amendment;

WHEREAS, this approval is subject to Article 2.E (Monitoring), of the ULDC and other provisions requiring that development commence in a timely manner;

WHEREAS, the issuance of this Development Permit does not in any way create any rights on the part of the Applicant and/or Property Owner to obtain a permit from a state or federal agency and does not create any liability on the part of the County for issuance of the permit if the Applicant fails to obtain requisite approvals or fulfill the obligations imposed by a state or federal agency or undertakes actions that result in a violation of state or federal law;

WHEREAS, the Palm Beach County Survey Section may administratively correct any scrivener's errors that will not significantly impact the overall boundary of the adopted legal description; and,

WHEREAS, Article 2.B.6.C (Board Action) of the ULDC requires that the action of the Board of County Commissioners be adopted by resolution.

NOW, THEREFORE, BE IT RESOLVED BY THE BOARD OF COUNTY COMMISSIONERS OF PALM BEACH COUNTY, FLORIDA, that Zoning Application SV/ABN/Z/CA-2018-00774, the Application of Els For Autism Foundation Inc, by Cotleur & Hearing, Inc., Agent, for an Official Zoning Map Amendment to allow a rezoning from the Single Family Residential (RS) Zoning District to the Institutional and Public Facilities (IPF) Zoning District., on a parcel of land generally described as shown on the legal description in EXHIBIT A, attached hereto and made a part hereof, and generally located as shown on a vicinity sketch as indicated in EXHIBIT B, attached hereto and made a part hereof, was approved on May 23, 2019, subject to the Conditions of Approval described in EXHIBIT C, attached hereto and made a part hereof.

Commissioner Weinroth moved for the approval of the Resolution.

The motion was seconded by Commissioner Valeche and, upon being put to a vote, the vote was as follows:

Commissioner Mack Bernard, Mayor	- Absent
Commissioner Dave Kerner, Vice Mayor	- Absent
Commissioner Hal R. Valeche	- Aye
Commissioner Gregg K. Weiss	- Absent
Commissioner Robert S. Weinroth	- Aye
Commissioner Mary Lou Berger	- Aye
Commissioner Melissa McKinlay	- Aye

The Mayor thereupon declared that the resolution was duly passed and adopted on May 23, 2019.

Filed with the Clerk of the Board of County Commissioners on June 4th, 2019.

This resolution is effective when filed with the Clerk of the Board of County Commissioners.

APPROVED AS TO FORM  
AND LEGAL SUFFICIENCY

PALM BEACH COUNTY, FLORIDA  
BY ITS BOARD OF COUNTY  
COMMISSIONERS

BY:

  
COUNTY ATTORNEY

BY:

SHARON R. BOCK,  
CLERK & COMPTROLLER

  
DEPUTY CLERK



EXHIBIT A

LEGAL DESCRIPTION

LEGAL DESCRIPTION

TRACT "A" OF ELS CENTER OF EXCELLENCE PLAT II, AS RECORDED  
IN PLAT BOOK 124, PAGE 170-171 OF THE PUBLIC RECORDS OF PALM  
BEACH COUNTY, FLORIDA.  
CONTAINING 1,169,631 SQUARE FEET OR 26.851 ACRES, MORE OR LESS.



EXHIBIT B  
VICINITY SKETCH

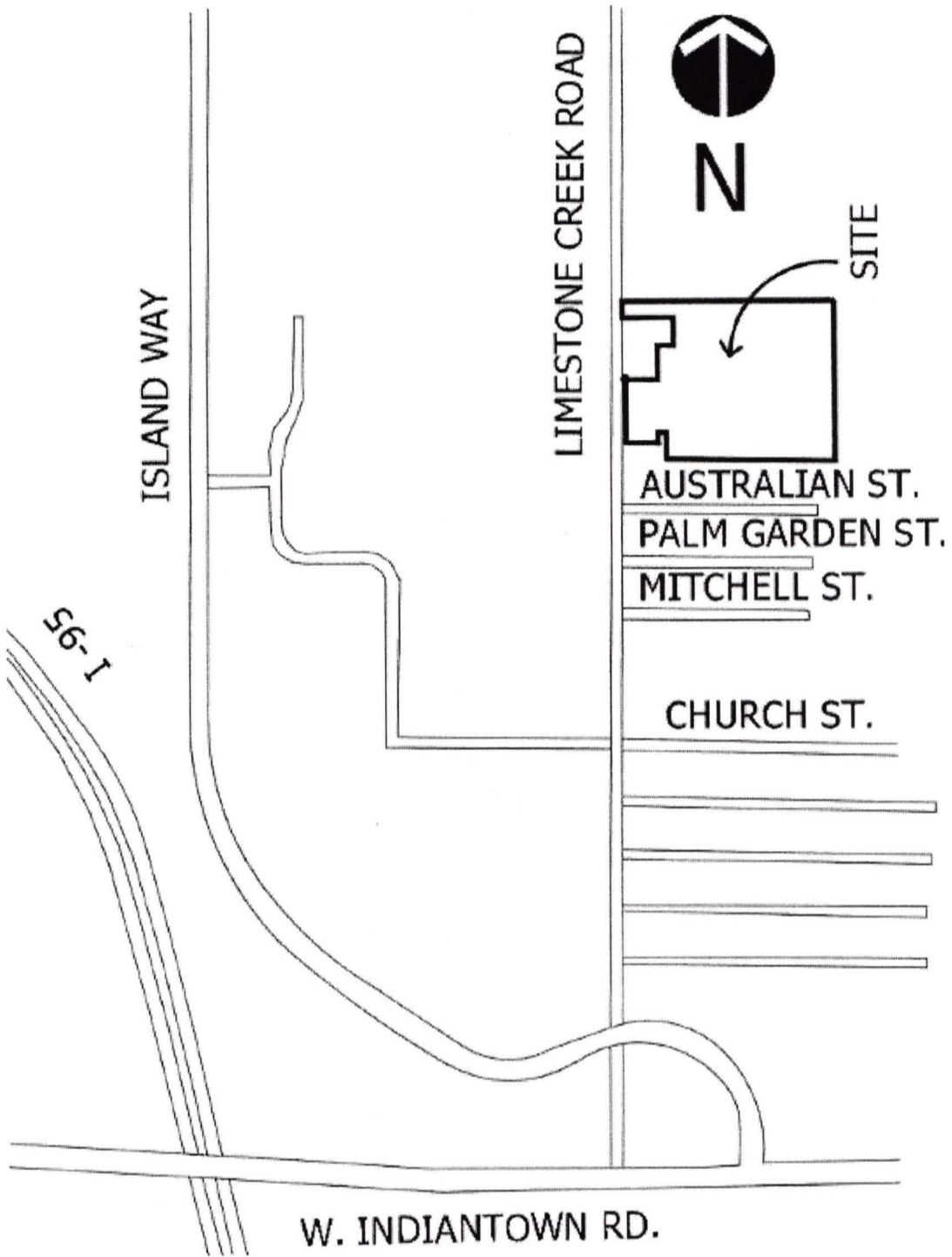

EXHIBIT C  
CONDITIONS OF APPROVAL

**DISCLOSURE**

1. All applicable state or federal permits shall be obtained before commencement of the development authorized by this Development Permit.