

RESOLUTION NO. R-2000- 1086

RESOLUTION APPROVING ZONING PETITION Z99-005(A)
OFFICIAL ZONING MAP AMENDMENT (REZONING)
PETITION OF PALM BEACH COUNTY HEALTHCARE DISTRICT
BY ANNA S. COTTRELL, AGENT
(PBC NURSING HOME)

WHEREAS, the Board of County Commissioners, as the governing body of Palm Beach County, Florida, pursuant to the authority vested in Chapter 163 and Chapter 125, Florida Statutes, is authorized and empowered to consider petitions relating to zoning; and

WHEREAS, the notice and public hearing requirements, as provided for in Article 5 (Development Review Procedures) of the Palm Beach County Unified Land Development Code (Ordinance 92-20, as amended), have been satisfied; and

WHEREAS, Zoning Petition Z99-005(A) was presented to the Board of County Commissioners at a public hearing conducted on July 27, 2000; and

WHEREAS, the Board of County Commissioners has considered the evidence and testimony presented by the petitioner and other interested parties, the recommendations of the various county review agencies, and the recommendation of the Zoning Commission; and

WHEREAS, the Board of County Commissioners made the following findings of fact:

1. This official zoning map amendment (rezoning) is consistent with the Palm Beach County Comprehensive Plan;
2. This official zoning map amendment (rezoning) is consistent with the requirements of the Palm Beach County Unified Land Development Code;
3. This official zoning map amendment (rezoning) is compatible with surrounding uses and zones, as defined in the Palm Beach County Unified Land Development Code, is generally consistent with existing uses and zones surrounding the subject land, and is the appropriate zoning district for the land;
4. This official zoning map amendment (rezoning) does not result in significantly adverse impacts on the natural environment, including but not limited to water, air, stormwater management, wildlife, vegetation, wetlands, and the natural functioning of the environment;
5. This official zoning map amendment (rezoning) will result in a logical and orderly development pattern;
6. This official zoning map amendment (rezoning) complies with Article 11 (Adequate Public Facilities Standards) of the Palm Beach County Unified Land Development Code; and,
7. This official zoning map amendment (rezoning) is consistent with the requirements of all other applicable local land development regulations.

WHEREAS, Article 5, Section 5.3.D.9 (Action by Board of County Commissioners) of the Palm Beach County Unified Land Development Code requires that the action of the Board of County Commissioners be adopted by resolution.

NOW, THEREFORE, BE IT RESOLVED BY THE BOARD OF COUNTY COMMISSIONERS OF PALM BEACH COUNTY, FLORIDA, that Zoning Petition Z99-005(A), the petition of Palm Beach County Healthcare District, by Anna S. Cottrell, agent, for an OFFICIAL ZONING MAP AMENDMENT (REZONING) from the Multiple Use Planned Development District (MUPD) to the Institutional and Public Facilities (IPF) Zoning District on a parcel of land legally described in EXHIBIT A, attached hereto and made a part hereof, and generally located as indicated on a vicinity sketch attached as EXHIBIT B, attached hereto and made a part hereof, was approved on July 27, 2000, subject to the conditions of approval described in Exhibit C of CB99-005(A).

Commissioner McCarty moved for the approval of the Resolution.

The motion was seconded by Commissioner Roberts and, upon being put to a vote, the vote was as follows:

Maude Ford Lee, Chair		Aye
Warren Newell, Vice Chair	-	Aye
Karen T. Marcus		Aye
Carol A. Roberts		Aye
Mary McCarty		Aye
Burt Aaronson		Aye
Tony Masilotti		Absent

The Chair thereupon declared that the resolution was duly passed and adopted on July 27, 2000.

APPROVED AS TO FORM
AND LEGAL SUFFICIENCY

PALM BEACH COUNTY, FLORIDA
BY ITS BOARD OF COUNTY
COMMISSIONERS

DOROTHY H. WILKEN, CLERK

BY: 
COUNTY ATTORNEY

BY: 
DEPUTY CLERK

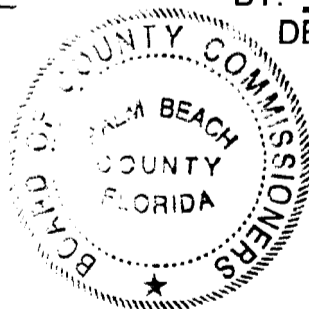

EXHIBIT A
LEGAL DESCRIPTION

All of Tracts 13 and 18 and the West one-half of Tracts 12 and 19, MODEL LAND Co. SUBDIVISION OF SECTION 20, TOWNSHIP 44 SOUTH, RANGE 43 EAST, Palm Beach County, Florida, according to the Plat thereof, recorded in Plat Book 5, Page 79, of the Public Records of Palm Beach County, Florida, LESS the North 55 feet of the said Tract 13 and of the West one-half of the said Tract 12, and LESS the South 40 feet of the said Tract 18 and of the West one-half of the said Tract 19.

Less and Excepting therefrom a portion of said Tract 13 and the west one-half of Tract 12 as recorded in Official Record Book 6495 at Page 1505 of the Public Records of Palm Beach County, Florida.

Said lands lying and being situate in Palm Beach County, Florida.

Containing 13.616 acres more or less.

EXHIBIT B

VICINITY SKETCH

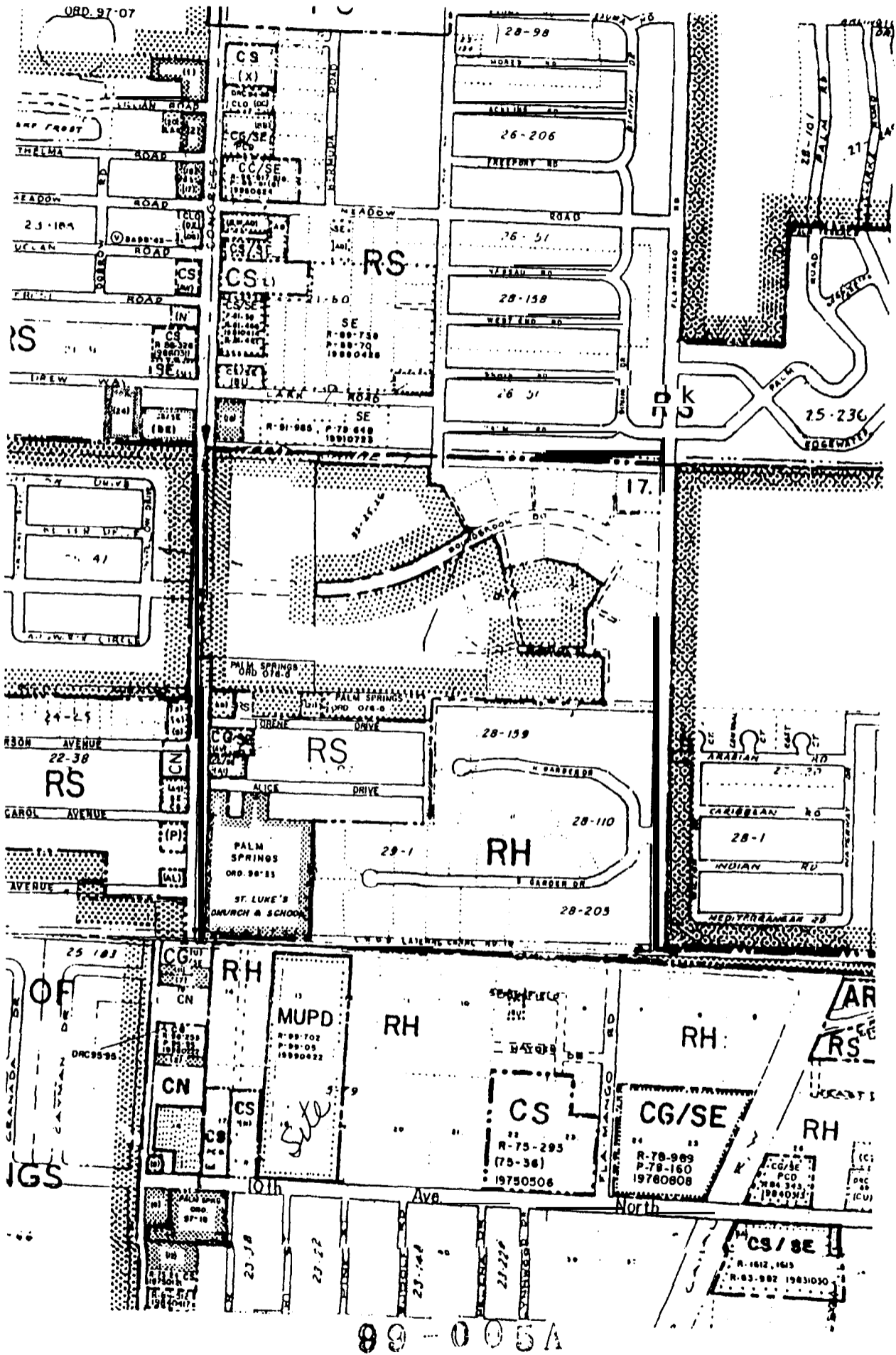

99-005A