



Federal Emergency Management Agency

Washington, D.C. 20472

December 12, 2000

REC'D JAN 2 - 2001

MR. BURT AARONSON
COMMISSIONER, PALM BEACH COUNTY
PALM BEACH GOVERNMENTAL CENTER
301 NORTH OLIVE AVENUE
WEST PALM BEACH, FL 33401

FOLLOWS CONDITIONAL CASE NO.: 99-04-4976C

CASE NO.: 01-04-0538A

COMMUNITY: PALM BEACH COUNTY, FLORIDA
(UNINCORPORATED AREAS)

COMMUNITY NO.: 120192

COMPL

Campos Del Mar

DEAR MR. AARONSON:

This is in reference to a request that the Federal Emergency Management Agency (FEMA) determine if the property is located within an identified Special Flood Hazard Area, the area that would be inundated by the flood having a 1-percent chance of being equaled or exceeded in any given year (base flood), on the effective National Flood Insurance Program (NFIP) map. Using the information submitted and the effective NFIP map, our determination is shown on the attached Letter of Map Revision based on Fill (LOMR-F) Determination Document. This determination document provides additional information regarding the effective NFIP map, the legal description of the property and our determination.

Additional documents are enclosed which provide information regarding the subject property and LOMR-Fs. Please see the List of Enclosures below to determine which documents are enclosed. If you have any questions about this letter or any of the enclosures, please contact the FEMA Map Assistance Center toll free at (877) 336-2627 (877-FEMA MAP) or by letter addressed to the Federal Emergency Management Agency, P.O. Box 2210, Merrifield, VA 22116-2210.

Sincerely,

Matthew B. Miller

Matthew B. Miller, P.E., Chief
Hazards Study Branch
Mitigation Directorate

LIST OF ENCLOSURES:

LOMR-F DETERMINATION DOCUMENT (REMOVAL)

cc: State/Commonwealth NFIP Coordinator
Community Map Repository
Region
Mr. Richard H. Smith, R.L.S.



Federal Emergency Management Agency

Washington, D.C. 20472

LETTER OF MAP REVISION BASED ON FILL DETERMINATION DOCUMENT (REMOVAL)

COMMUNITY AND MAP PANEL INFORMATION		LEGAL PROPERTY DESCRIPTION
COMMUNITY	PALM BEACH COUNTY, FLORIDA (Unincorporated Areas)	Coronado at Camino, located on Tract 69B, Camino Del Mar Country Club, as shown and recorded in Plat Book 78, Pages 199 and 120, filed on November 25, 1996, by the Palm Beach County Clerk of the Circuit Court
	COMMUNITY NO.: 120192	
AFFECTED MAP PANEL	NUMBER: 120192090B	
	NAME: PALM BEACH COUNTY, FLORIDA (UNINCORPORATED AREAS)	
	DATE: 10/15/1982	
FLOODING SOURCE: UNNAMED SHALLOW FLOODING		APPROXIMATE LATITUDE & LONGITUDE OF PROPERTY: 26.339, -80.139 SOURCE OF LAT & LONG: MAPBLAST! DATUM: NAD83

DETERMINATION

LOT	BLOCK/ SECTION	SUBDIVISION	STREET	OUTCOME WHAT IS REMOVED FROM THE SFHA	FLOOD ZONE	1% ANNUAL CHANCE FLOOD ELEVATION (NGVD29)	LOWEST ADJACENT GRADE ELEVATION (NGVD29)	LOWEST FLOOR ELEVATION (NGVD29)	LOWEST LOT ELEVATION (NGVD29)
—	—	Coronado at Camino	Camino Del Mar	Building No. 3	B	—	17.5 feet	17.5 feet	—

Special Flood Hazard Area (SFHA) - The SFHA is an area that would be inundated by the flood having a 1-percent chance of being equaled or exceeded in any given year (base flood).

ADDITIONAL CONSIDERATIONS (Please refer to the appropriate section on Attachment 1 for the additional considerations listed below.)

PORTIONS REMAIN IN THE SFHA
STUDY UNDERWAY

This document provides the Federal Emergency Management Agency's determination regarding a request for a Letter of Map Revision based on Fill for the property described above. Using the information submitted and the effective National Flood Insurance Program (NFIP) map, we have determined that the structure(s) on the property(ies) is/are not located in the SFHA, an area inundated by the flood having a 1-percent chance of being equaled or exceeded in any given year (base flood). This document revises the effective NFIP map to remove the subject property from the SFHA located on the effective NFIP map; therefore, the Federal mandatory flood insurance requirement does not apply. However, the lender has the option to continue the flood insurance requirement to protect its financial risk on the loan. A Preferred Risk Policy (PRP) is available for buildings located outside the SFHA. Information about the PRP and how one can apply is enclosed.

This determination is based on the flood data presently available. The enclosed documents provide additional information regarding this determination. If you have any questions about this document, please contact the FEMA Map Assistance Center toll free at (877) 336-2627 (877-FEMA MAP) or by letter addressed to the Federal Emergency Management Agency, P.O. Box 2210, Merrifield, VA 22116-2210.

Matthew B. Miller

Matthew B. Miller, P.E., Chief
Hazards Study Branch
Mitigation Directorate

Version 1.3.1

MX17301000339368LOMA39368SPF2



Federal Emergency Management Agency

Washington, D.C. 20472

NOV 30 1999

Ms. Maude F. Lee
Palm Beach Governmental Center
301 North Olive
West Palm Beach, Florida 33401

Case No.: 99-04-4976C
Community: PALM BEACH COUNTY,
FLORIDA
(UNINCORPORATED AREAS)
Community Number: 120192

Dear Ms. Lee:

revised

This is in reference to a request that the Federal Emergency Management Agency (FEMA) determine if the property would be located within an identified Special Flood Hazard Area, the area that would be inundated by the flood having a 1-percent chance of being equaled or exceeded in any given year (base flood), on the effective National Flood Insurance Program (NFIP) map. Using the information submitted and the effective NFIP map, our comment is shown on the attached Conditional Letter of Map Revision based on Fill (CLOMR-F) Comment Document. This document provides additional information regarding the effective NFIP map, the legal description of the property, and our comments regarding this proposed project.

Additional documents are enclosed which provide information regarding the subject property and CLOMR-Fs. Please see the List of Enclosures below to determine which documents are enclosed. If you have any questions about this letter or any of the enclosures, please contact the FEMA Map Assistance Center toll free at (877) 336-2627 (877-FEMA MAP) or by letter addressed to the Federal Emergency Management Agency, P.O. Box 2210, Merrifield, VA 22116-2210.

Sincerely,

Matthew B. Miller

Matthew B. Miller, P.E., Chief
Hazards Study Branch
Mitigation Directorate

List of Enclosures

CLOMR-F Comment Document and Attachment; Pages 1 and 2

cc: Mr. Richard H. Smith, R.L.S., Craig A. Smith & Associates



Federal Emergency Management Agency

Washington, D.C. 20472

CONDITIONAL LETTER OF MAP REVISION BASED ON FILL COMMENT DOCUMENT ATTACHMENT I (ADDITIONAL CONSIDERATIONS)

STUDY UNDERWAY

This determination is based on the flood data presently available. However, the Federal Emergency Management Agency is currently revising the National Flood Insurance Program (NFIP) map for the community. New flood data could be generated that may affect this property. When the new NFIP map is issued it will supersede this determination. The Federal requirement for the purchase of flood insurance will then be based on the newly revised NFIP map.

CONDITIONAL

Comments regarding this conditional request are based on the flood data presently available. Our final determination will be made upon receipt of this comment document, certified as-built elevations and/or survey. If this document is for a Conditional Letter of Map Revision based on Fill, the "Certification of Fill Placement" and "Community Acknowledgement of Raquests Involving Fill" forms must be completed and submitted. The "Certification of Fill Placement" form must be completed by a professional engineer, an accredited soils engineer, or the community's National Flood Insurance Program permit official. Additional data may be required for a final as-built determination.

This letter does not relieve Federal agencies of the need to comply with Executive Order 11988 on Floodplain Management in carrying out their responsibilities and providing Federally undertaken, financed, or assisted construction and improvements, or in their regulating or licensing activities.

This attachment provides additional information regarding this request. If you have any questions about this attachment, please contact the Federal Emergency Management Agency Map Assistance Center toll free at (877) 338-2627 (877-FEMA MAP) or by letter addressed to the Federal Emergency Management Agency, P.O. Box 2210, Memphis, VA 22116-2210.

A handwritten signature in black ink, which appears to read "Matthew B. Miller".

Matthew B. Miller, P.E., Chief
Hazards Study Branch
Mitigation Directorate



Federal Emergency Management Agency

Washington, D.C. 20472

CONDITIONAL LETTER OF MAP REVISION BASED ON FILL COMMENT DOCUMENT

COMMUNITY AND MAP PANEL INFORMATION		LEGAL PROPERTY DESCRIPTION
COMMUNITY	PALM BEACH COUNTY, FLORIDA (UNINCORPORATED AREAS)	Coronado at Camino, located on Tract 69B, Camino Del Mar Country Club, as shown and recorded in Plat Book 78, Pages 119 and 120, filed on November 25, 1996, by the Palm Beach County Clerk of the Circuit Court
	COMMUNITY NO: 120192	
MAP PANEL AFFECTED	NUMBER: 0240 B	
	NAME: PALM BEACH COUNTY, FLORIDA (UNINCORPORATED AREAS)	
DATE: OCTOBER 15, 1982		
FLOODING SOURCE: UNNAMED SHALLOW FLOODING		APPROXIMATE LATITUDE & LONGITUDE OF PROPERTY: 26.339481, -80.138502 SOURCE OF LAT & LONG: MAPBLAST! DATUM: NAD83

COMMENT TABLE REGARDING THE PROPOSED PROPERTY (PLEASE NOTE THAT THIS IS NOT A FINAL DETERMINATION. A FINAL DETERMINATION WILL BE MADE UPON RECEIPT OF AS-BUILT INFORMATION REGARDING THIS PROPERTY.)

BLOCK/SECTION	SUBDIVISION	STREET ADDRESS	OUTCOME WHAT WOULD BE REMOVED FROM THE SFHA	PROPOSED FLOOD ZONE	1% ANNUAL CHANGE FLOOD ELEVATION (NGVD29)	LOWEST ADJACENT GRADE ELEVATION (NGVD29) (Proposed)	LOWEST FLOOR ELEVATION (NGVD29) (Proposed)	LOWEST LOT ELEVATION (NGVD29) (Proposed)
—	Coronado at Camino	Camino Del Mar	Building No. 3	B	—	17.5 feet	17.5 feet	—

Special Flood Hazard Area (SFHA) – The SFHA is an area that would be inundated by the flood having a 1-percent chance of being equaled or exceeded in any given year (base flood).

ADDITIONAL CONSIDERATIONS (Please refer to the appropriate section on Attachment 1 for the additional considerations listed below.)

**STUDY UNDERWAY
CONDITIONAL**

This document provides the Federal Emergency Management Agency's comment regarding a request for a Conditional Letter of Map Revision based on Fill for the property described above. Using the information submitted and the effective National Flood Insurance Program (NFIP) map, we have determined that the proposed structure on the property would not be located in the SFHA, an area inundated by the flood having a 1-percent chance of being equaled or exceeded in any given year (base flood) if built as proposed. Our final determination will be made upon receipt of a copy of this document and certified as-built information showing the location of the structure(s), the elevation of the lowest adjacent grade to the structure(s), and the lowest floor elevation (including basement/crawl space) for the structure(s). This document is not a final determination; it only provides our comment on the proposed project in relation to the SFHA shown on the effective NFIP map.

This comment document is based on the flood data presently available. The enclosed documents provide additional information regarding this request. If you have any questions about this document, please contact the FEMA Map Assistance Center toll free at (877) 336-2627 (877-FEMA MAP) or by letter addressed to the Federal Emergency Management Agency, P.O. Box 2210, Merrifield, VA 22116-2210.

Matthew B. Miller, P.E., Chief
Hazards Study Branch
Mitigation Directorate

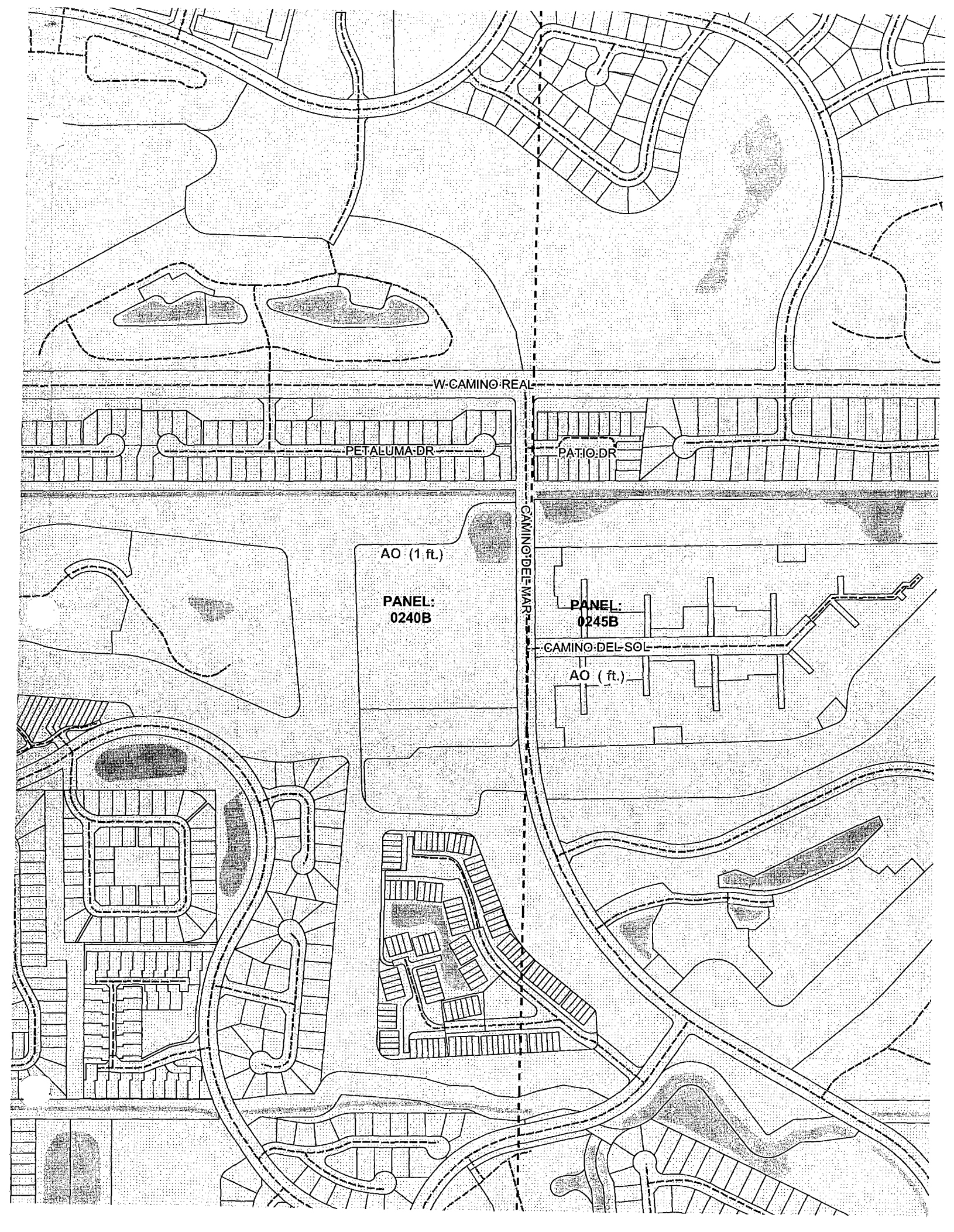

W-CAMINO-REAL

PETALUMA-DR

PATIO-DR

CAMINO-DEL-MAR

AO (1 ft.)

PANEL:
0240B

PANEL:
0245B

CAMINO-DEL-SOL

AO (ft.)

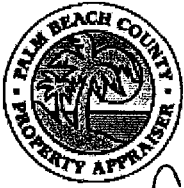

Gary R. Nikolits, CFA
Palm Beach County Property Appraiser
Public Access System

CLOMR - F

Back to Search

*Never completed
compr by applicant
properties still in
AOI depth
SFAR*

Rows 101 to 150 displayed

Click on row to see more information

< Prev Next

Owner Name	Situs Address	Parcel Control Number
<u>SHERES TED</u>	22703 CAMINO DEL MAR 65	00424727570020650
<u>SHERES DINA</u>	22703 CAMINO DEL MAR 65	00424727570020650
<u>STRONG DALE A</u>	22703 CAMINO DEL MAR 66	00424727570020660
<u>MARKS RANDY J &</u>	22701 CAMINO DEL MAR # 21	
<u>MARKS LUZ M</u>	22701 CAMINO DEL MAR # 21	
<u>FLAMINGO GROUP HOLDINGS CORP</u>	22701 CAMINO DEL MAR # 22	
<u>HARRIES DAVID</u>	22701 CAMINO DEL MAR 23	
<u>LAIRET ALEXANDRA</u>	22701 CAMINO DEL MAR 24	
<u>PASSAFIUME MICHAEL</u>	22701 CAMINO DEL MAR 25	
<u>MCCABE ALICE</u>	22701 CAMINO DEL MAR 26	
<u>MOORE GARY A &</u>	22701 CAMINO DEL MAR 31	
<u>MOORE TRUDY</u>	22701 CAMINO DEL MAR 31	
<u>EHRlich ALLAN J &</u>	22701 CAMINO DEL MAR 32	
<u>EHRlich ANITA L</u>	22701 CAMINO DEL MAR 32	
<u>CAVALLERANO DEBRA</u>	22701 CAMINO DEL MAR 33	
<u>STARASOLER TRACY</u>	22701 CAMINO DEL MAR 34	
<u>DAMIANO RAYMOND J</u>	22701 CAMINO DEL MAR 35	
<u>LORBER PETER &</u>	22701 CAMINO DEL MAR 36	
<u>LORBER ADELINE</u>	22701 CAMINO DEL MAR 36	
<u>IVES RITA K</u>	22701 CAMINO DEL MAR 41	
<u>IVES RITA K TR</u>	22701 CAMINO DEL MAR 41	
<u>GALARDI WILLIAM J &</u>	22701 CAMINO DEL MAR 42	
<u>GALARDI ANN B</u>	22701 CAMINO DEL MAR 42	
<u>MCNAIR STEVEN &</u>	22701 CAMINO DEL MAR 43	
<u>MCNAIR KARIN</u>	22701 CAMINO DEL MAR 43	
<u>ALBERT PERCIVAL</u>	22701 CAMINO DEL MAR 44	
<u>ZANN MILDRED M</u>	22701 CAMINO DEL MAR 45	
<u>ZANN GREGORY J III TR</u>	22701 CAMINO DEL MAR 45	
<u>ZANN MILDRED M TR</u>	22701 CAMINO DEL MAR 45	
<u>WALSH JOSEPH A &</u>	22701 CAMINO DEL MAR 46	
<u>WALSH CHRISTINE R</u>	22701 CAMINO DEL MAR 46	
<u>TRILLO MANUEL &</u>	22701 CAMINO DEL MAR 51	
<u>TRILLO MARIA</u>	22701 CAMINO DEL MAR 51	
<u>MARKS MARTIN J &</u>	22701 CAMINO DEL MAR 52	
<u>MARKS DARREN M</u>	22701 CAMINO DEL MAR 52	
<u>BASTIDAS BEATRICE H</u>	22701 CAMINO DEL MAR 53	
<u>HOGUE CHANTAL</u>	22701 CAMINO DEL MAR 54	
<u>LIF GARDEN &</u>	22701 CAMINO DEL MAR 55	

BUILDING 3

BUILDING 4 never had CLOMR/F SUBMITTED

GILBERT SARA L
MARTINO ROBERT S &
MARTINO GLORIA R
STARASOLER LEWIS
LITEWKA SERGIO G &
LONDONO ANA M
ROSENBERG FROMY &
ROSENBERG JUDITH M
GIRAND JUAN F M
MISLE CARMEN E D
LEVINE RISA S &
LEVINE PAUL

BUILDING 3
~~22701 CAMINO DEL MAR 58~~
~~22701 CAMINO DEL MAR 56~~
~~22701 CAMINO DEL MAR 56~~
~~22701 CAMINO DEL MAR 61~~
~~22701 CAMINO DEL MAR 62~~
~~22701 CAMINO DEL MAR 62~~
~~22701 CAMINO DEL MAR 63~~
~~22701 CAMINO DEL MAR 63~~
~~22701 CAMINO DEL MAR 63~~
~~22701 CAMINO DEL MAR 64~~
~~22701 CAMINO DEL MAR 64~~
~~22701 CAMINO DEL MAR 64~~
~~22701 CAMINO DEL MAR 65~~
~~22701 CAMINO DEL MAR 65~~

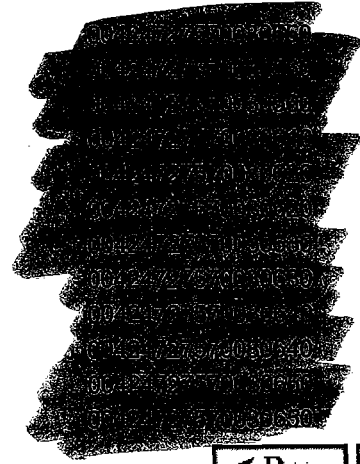

[| Home |](#)
[| Back |](#)
[| Search |](#)

Please send us your feedback

Copyright © 2002 by Palm Beach County Property Appraiser
 All Rights Reserved



Gary R. Nikolits, CFA
Palm Beach County Property Appraiser
Public Access System

Back to Search

Rows 151 to 200 displayed

Click on row to see more information

◀ Prev

Next ▶

Owner Name	Situs Address	Parcel Control Number
<u>LAPERUTA PETER &</u>	22701 CAMINO DEL MAR 66	
<u>LAPERUTA LENA</u>	22701 CAMINO DEL MAR 66	
<u>DE LORME PAMELA J</u>	23200 CAMINO DEL MAR 1010	00424735120011010
<u>BORGESE JULIE &</u>	23200 CAMINO DEL MAR 1020	00424735120011020
<u>AUGUSTINE PAUL</u>	23200 CAMINO DEL MAR 1020	00424735120011020
<u>KOESTER BEATRICE</u>	23200 CAMINO DEL MAR 1030	00424735120011030
<u>SCRIMA NANCY</u>	23200 CAMINO DEL MAR 1060	00424735120011060
<u>FABARA-NUNEZ NANCY &</u>	23200 CAMINO DEL MAR 1070	00424735120011070
<u>FABARA-NUNEZ MARIA</u>	23200 CAMINO DEL MAR 1070	00424735120011070
<u>GRAJA STANISLAW & BARBARA</u>	23200 CAMINO DEL MAR 1080	00424735120011080
<u>GRAJA BARBARA</u>	23200 CAMINO DEL MAR 1080	00424735120011080
<u>ASKARI HOLDINGS INC</u>	23200 CAMINO DEL MAR 2010	00424735120012010
<u>MASER LEONARD & MAE</u>	23200 CAMINO DEL MAR 2020	00424735120012020
<u>MAE MASER</u>	23200 CAMINO DEL MAR 2020	00424735120012020
<u>PRESTIANNI MARY K</u>	23200 CAMINO DEL MAR 2030	00424735120012030
<u>SCHWARTZ PHILIP</u>	23200 CAMINO DEL MAR 2040	00424735120012040
<u>PUGATZ EUGENE &</u>	23200 CAMINO DEL MAR 2050	00424735120012050
<u>OVERDORF ROBERT H</u>	23200 CAMINO DEL MAR 2050	00424735120012050
<u>ARCIADOCONO ROSE</u>	23200 CAMINO DEL MAR 2060	00424735120012060
<u>SHERMAN STUART R &</u>	23200 CAMINO DEL MAR 2070	00424735120012070
<u>SHERMAN ANTOINETTE</u>	23200 CAMINO DEL MAR 2070	00424735120012070
<u>HELFANBEIN BARRY</u>	23200 CAMINO DEL MAR 2080	00424735120012080
<u>RIVERA NANCY</u>	23200 CAMINO DEL MAR 2090	00424735120012090
<u>BRYAN AUDREY S</u>	23200 CAMINO DEL MAR 3010	00424735120013010
<u>GUEDES HENRY L JR &</u>	23200 CAMINO DEL MAR 3020	00424735120013020
<u>FIORINA DANIELLE PATRICIA</u>	23200 CAMINO DEL MAR 3020	00424735120013020
<u>MAGUIRE DEBRA C</u>	23200 CAMINO DEL MAR 3030	00424735120013030
<u>WOLFF SYBILLE</u>	23200 CAMINO DEL MAR 3040	00424735120013040
<u>ROBERTSON THOMAS D JR &</u>	23200 CAMINO DEL MAR 3050	00424735120013050
<u>ROBERTSON SANDRA M</u>	23200 CAMINO DEL MAR 3050	00424735120013050
<u>KREPP EDITH</u>	23200 CAMINO DEL MAR 3060	00424735120013060
<u>HELFANBEIN BARRY</u>	23200 CAMINO DEL MAR 3070	00424735120013070
<u>MARCUS HAROLD & RIVIAN</u>	23200 CAMINO DEL MAR 3080	00424735120013080
<u>RIVIAN MARCUS</u>	23200 CAMINO DEL MAR 3080	00424735120013080
<u>ZACCARDI CLAUDETTE</u>	23200 CAMINO DEL MAR 3090	00424735120013090
<u>SCHECHTER TRINETTE</u>	23200 CAMINO DEL MAR 4010	00424735120014010
<u>WILLIS JOHN W</u>	23200 CAMINO DEL MAR 4020	00424735120014020
<u>POLIAFITO ANTONIO & GRACE</u>	23200 CAMINO DEL MAR 4030	00424735120014030

Blat